

- NOTES:
1. ONLY STAKE TREES THAT ARE NOT CAPABLE OF STANDING UPRIGHT WITHOUT FALLING OR LEANING.
  2. USE (3) TREE STABILIZER TREE TUBES PER TREE. PLACE +/- 120 DEGREES APART.
  3. INSTALL INSPECTION TUBE CAPS AND TREE TIES PER MANUFACTURER'S SPECIFICATIONS.
  4. REF. PLANTING NOTES FOR MORE INFORMATION.

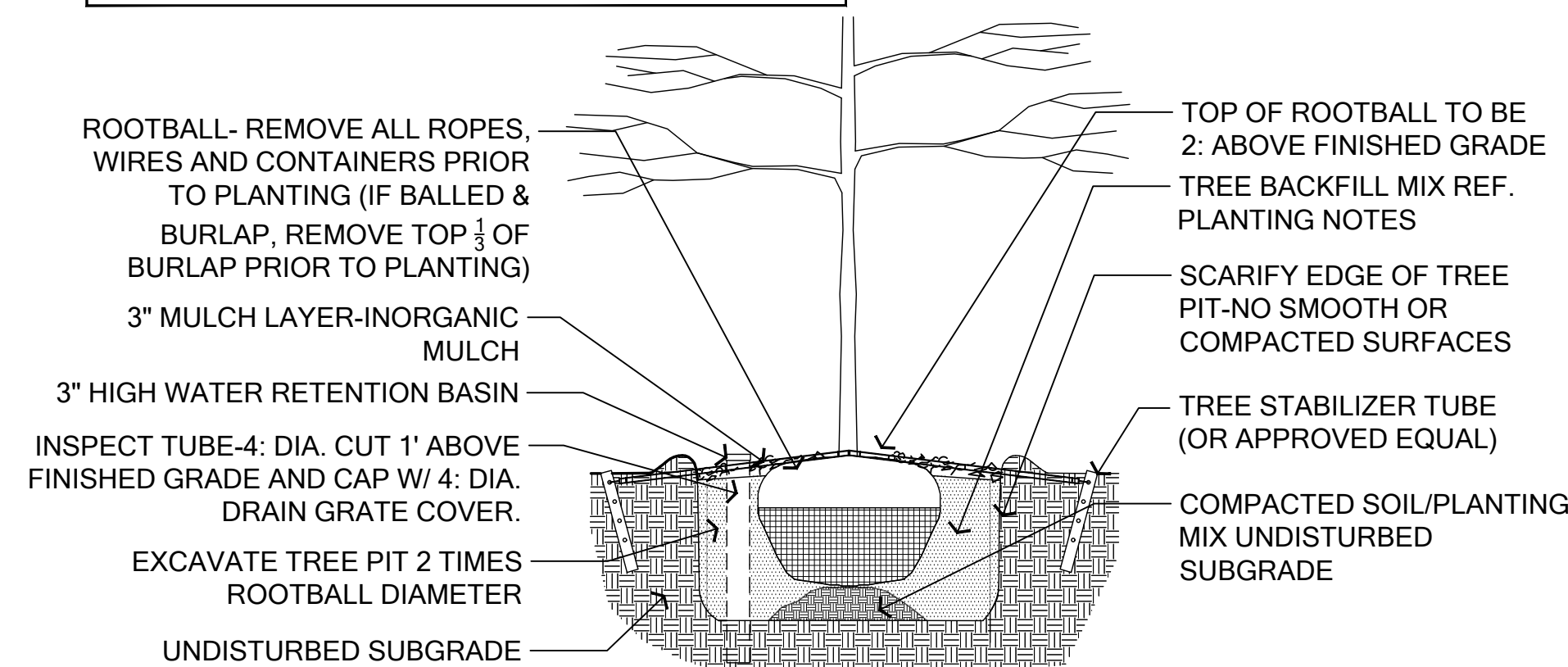

**01-DETAIL: TYPICAL TREE PLANTING**

SCALE: 1/2"= 1'-0"

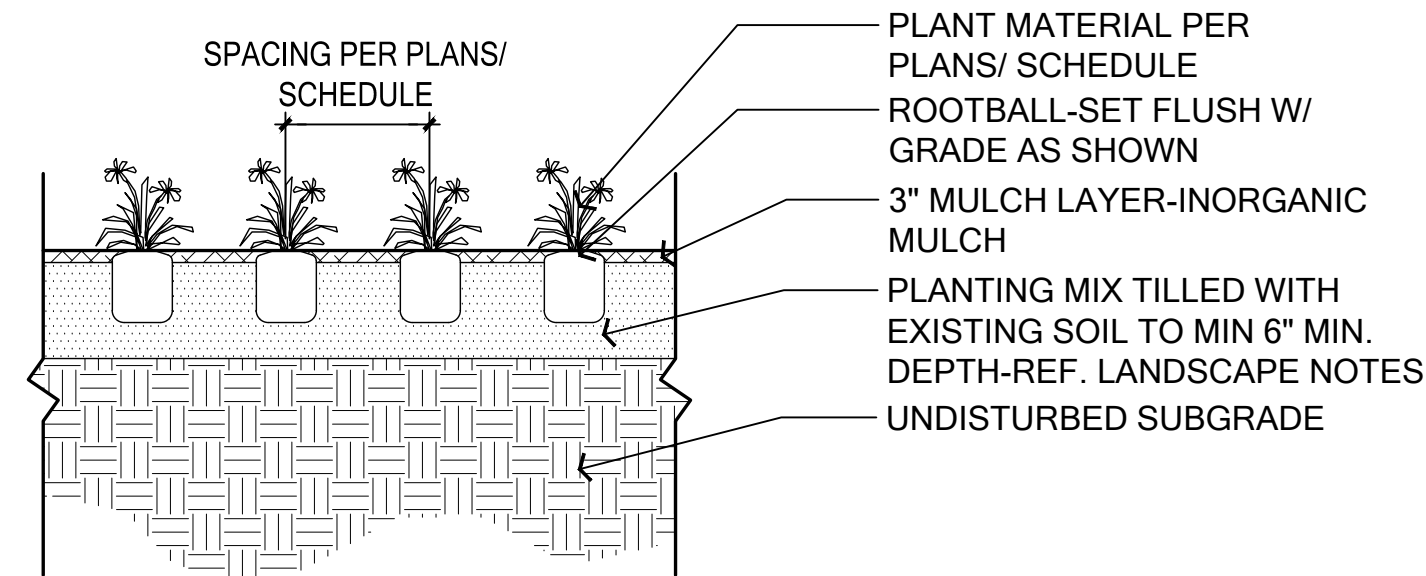

NOTE: THIS DETAIL REFERS TO ALL GROUND COVER, PERENNIAL, AND SEASONAL COLOR PLANTINGS UNLESS OTHERWISE NOTED.

**02-DETAIL: TYPICAL GROUND COVER PLANTING**

SCALE: 1/2"= 1'-0"

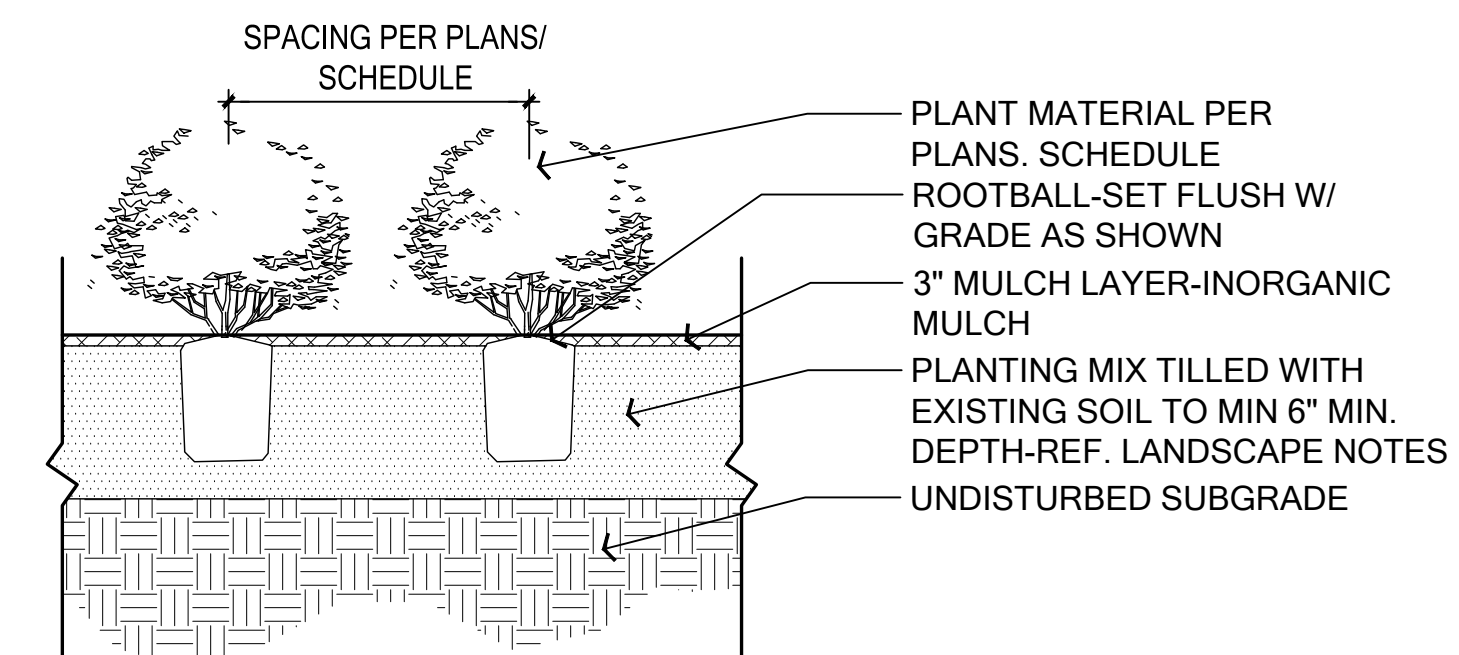

NOTE: THIS DETAIL REFERS TO ALL SHRUB AND ORNAMENTAL GRASS PLANTINGS UNLESS OTHERWISE NOTED.

**03-DETAIL: TYPICAL SHRUB PLANTING**

SCALE: 1/2"= 1'-0"



DEVELOPMENT PLAN FOR PD 758,  
SUBAREA C:  
7.95 ACRES  
LOT 1, BLOCK D/8125  
LOT1, BLOCK C/8125  
LAKE HIGHLANDS TOWN CENTER  
CITY OF DALLAS, DALLAS COUNTY, TEXAS

CASE NO. D156-001 (DL)

DEVELOPMENT PLAN  
FOR PD 758  
LANDSCAPE PLAN

LAKE HIGHLANDS TOWN CENTER  
SKILLMAN STREET AND WALNUT HILL LANE  
DALLAS, TEXAS

OWNER:  
PCLH Land Partners, LP  
Dallas, Texas

**Kimley»Horn**

1750 Chestnut Court, Suite 200  
Frisco, Texas 75034  
State of Texas Registration No. F-4928

Tel. No. (972) 335-5869  
Fax No. (972) 335-5779

Scale: AS SHOWN  
Designed by: MSB  
Drawn by: MSB  
Checked by: MSB  
Date: 08/23/2015 / REVISED 12/11/2015 FOR CITY COMMENTS  
Project No.: GFF 14208

LS 2.1