

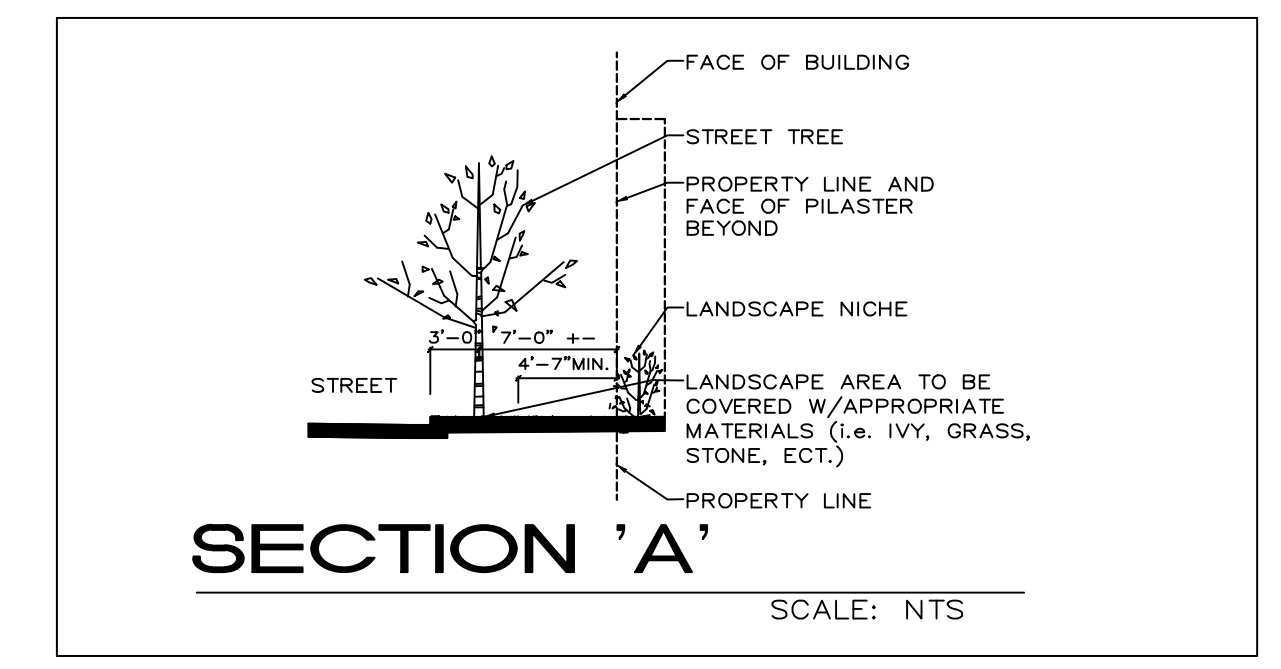

2501 N. Harwood Street  
Dallas, TX 75201  
214-871-0871

MINOR AMENDMENT TO  
LANDSCAPE PLAN FOR  
**SAINT ANN COURT  
PHASE II**  
2501 N. HARWOOD STREET  
DALLAS, TEXAS 75201

THESE DRAWINGS AND COPIES ARE  
THE COPYRIGHTED PROPERTY OF  
THE ARCHITECT. THEY MAY NOT BE  
USED FOR PROJECTS OTHER THAN  
THE DESIGNATED PROJECT WITHOUT  
THE SPECIFIC WRITTEN APPROVAL  
OF THE ARCHITECT.

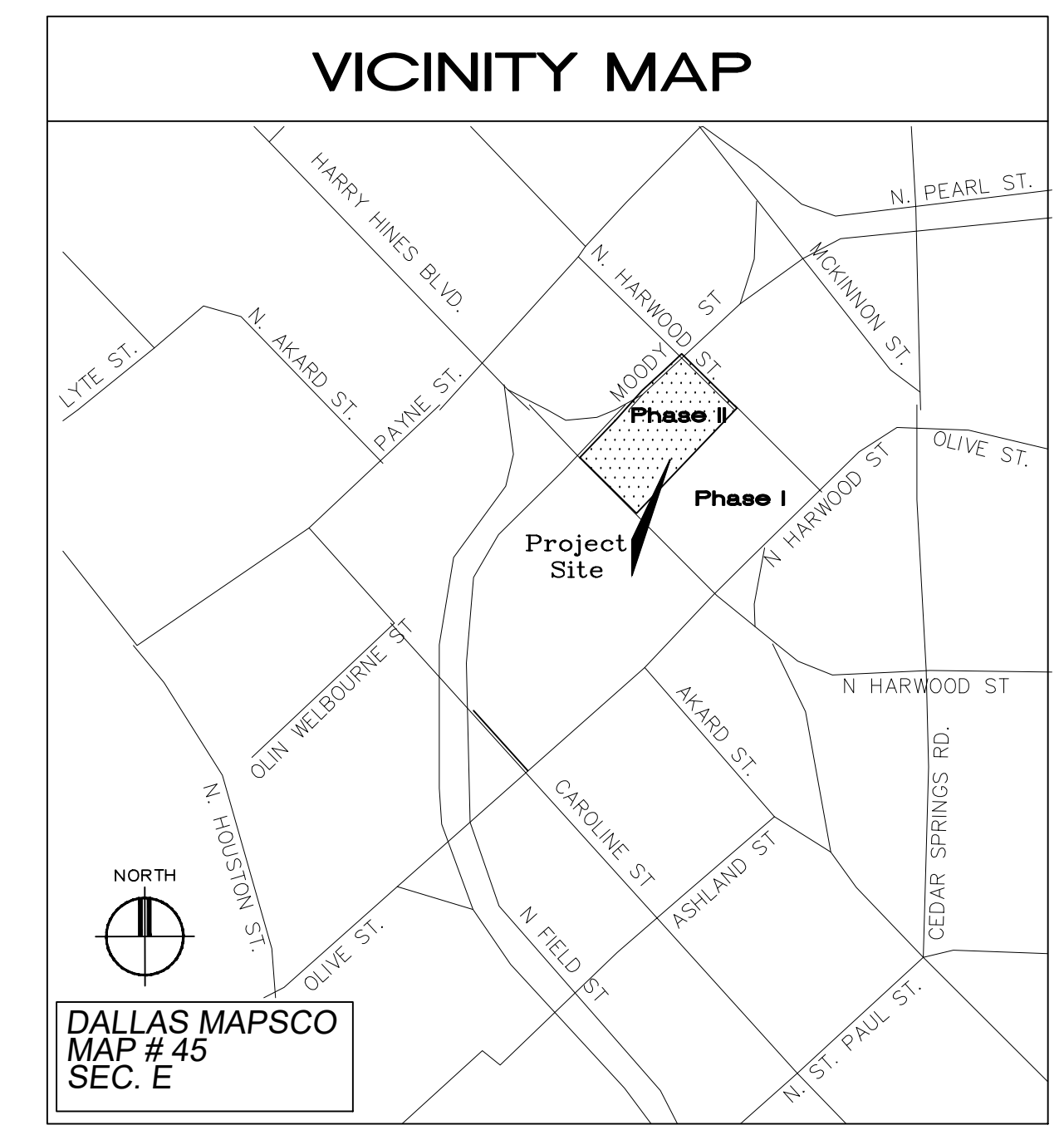

**OWNER - INFORMATION**  
Owner: International Development Center IX, LTD.  
Property Location: Lot 1A, Block 3/364  
1.377 ACRES (60,000 SF)

**TREES PROVIDED BY STREET**

	REQUIRED PHASE I	PROVIDED PHASE I	REQUIRED PHASE II	PROVIDED PHASE II
HARRY HINES BLVD.	2	2	3	5
HARWOOD BLVD.	3	6	4	4
OLIVE ST.	7	8	NA	NA
MOODY ST.	N/A	N/A	N/A	N/A

1. STREET TREES ON OLIVE (WICHITA) TO BE LIVE OAK OR MAGNOLIA.

**MINOR AMENDMENT TO  
LANDSCAPE PLAN**  
Planned Development  
District No. 193 Sub District 53  
Historic Overlay District 94  
PDS 53, PHASE II

M178-031

REVISIONS:

PRELIMINARY ISSUES:

PROJECT ARCHITECT:  
BEN CORTEZ

ISSUE DATE:  
03-26-18

APPROVED BY:  
B.C.

DRAWN BY:  
B.C.

JOB AND SHEET NO.:  
H13491s1-0.DWG

DRAWING TITLE:  
LANDSCAPE PLAN

SHEET NO.:

**LS1.0**

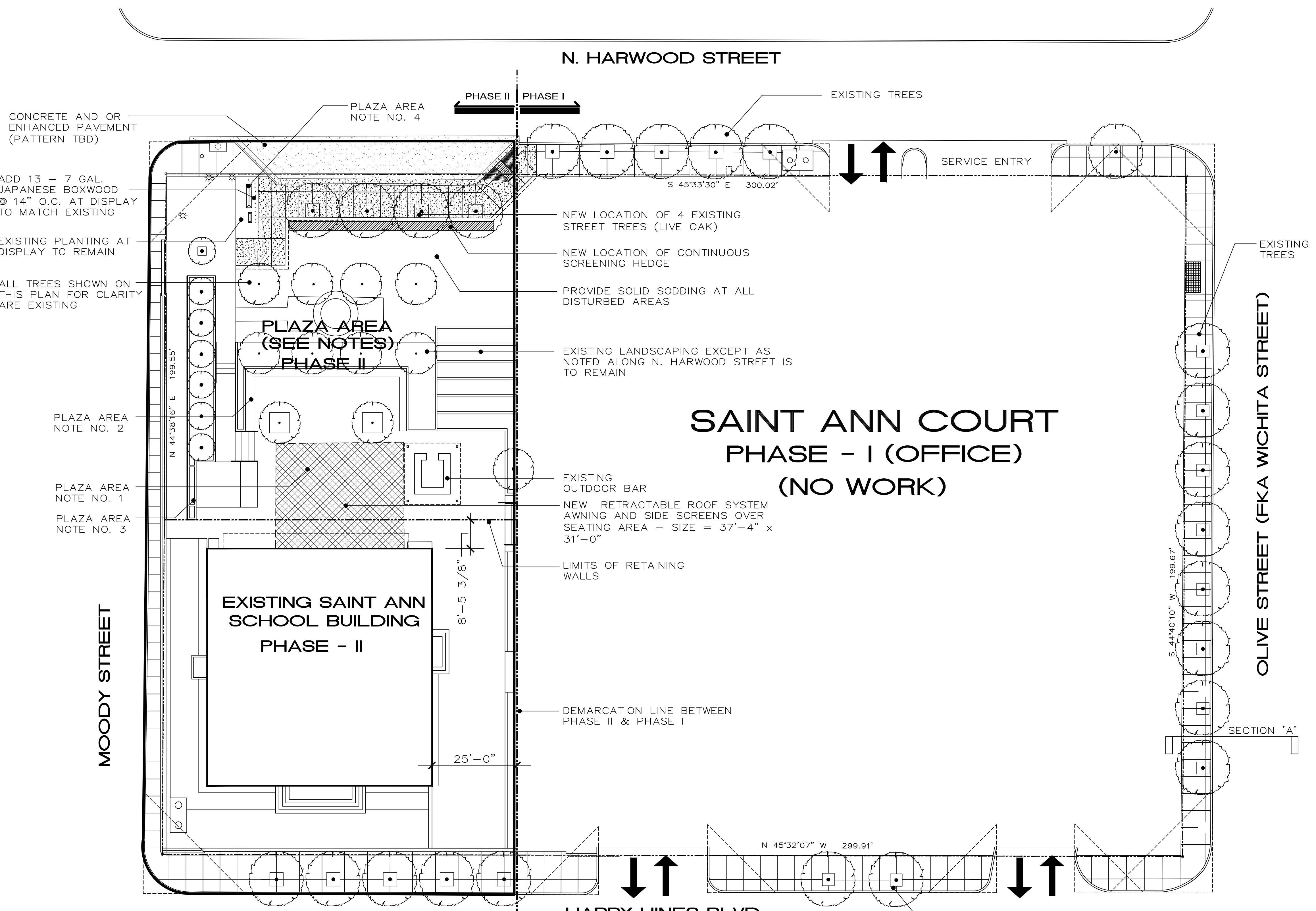

- Phase II**
- PLAZA AREA NOTES: \***
- Outdoor Amenity Area to Include Landscaping Materials, Seating Area & Bar Structure - Not to Exceed 24 Feet Above Grade.
  - Retaining Walls - Variable Heights, Not to Exceed 20 Feet - See Limits of Retaining Walls for Location.
  - Lighting Enhancements and Fire Pits - 2 Fire Pits Not to Exceed 3 Feet Above Grade.
  - Monument Structure for the Virgin of Guadalupe Mosaic & Cornerstone - Not to Exceed 24 Feet Above Grade.

\* NOTE:  
Existing Outdoor Amenity Area Complies with these 4 notes.

**LANDSCAPE PLAN**  
SCALE: 1/16"=1'-0"  
**Saint Ann Court  
Phase II**  
Lot 1A, Block 3/364  
PD-193 - SUB DISTRICT 53  
HISTORIC OVERLAY DISTRICT 94  
PDS 53, PHASE II

