

2999 TURTLE CREEK

Dallas, Texas

Talley Associates

Landscape Architecture
Planning
Urban Design
1925 San Jacinto, Suite 400
Dallas, Texas 75201
Tel. 214-871-7900
Fax. 214-871-7985

fab studio

Architecture
5646 Milton Street, Suite 207
Dallas, Texas 75206
Tel. 214-550-6623

LOCATION MAP

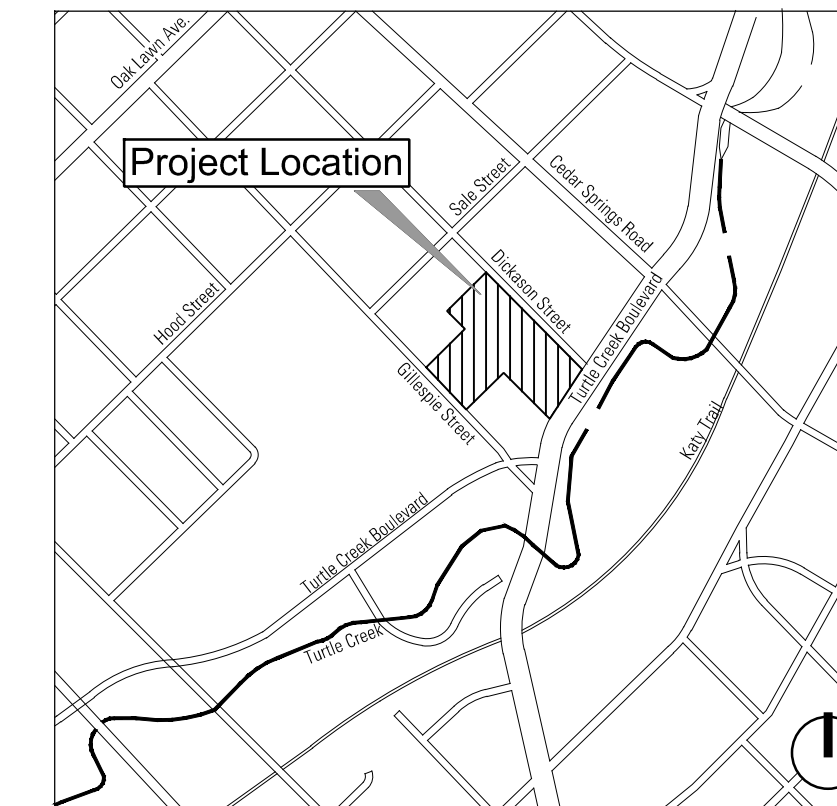

SITE SUMMARY

ALLOWABLE USES:	PDS / O-2
PROPOSED USE:	HOTEL AND RESIDENTIAL
OVERLAY DISTRICT:	TURTLE CREEK ENVIRONMENTAL CORRIDOR
LOT AREA:	2.47 ACRES (107,709 SF)
LOT COVERAGE:	60% MAX.
FLOOR AREA RATIO:	5.25 MAX.
BUILDING HEIGHT:	325 FT MAX.

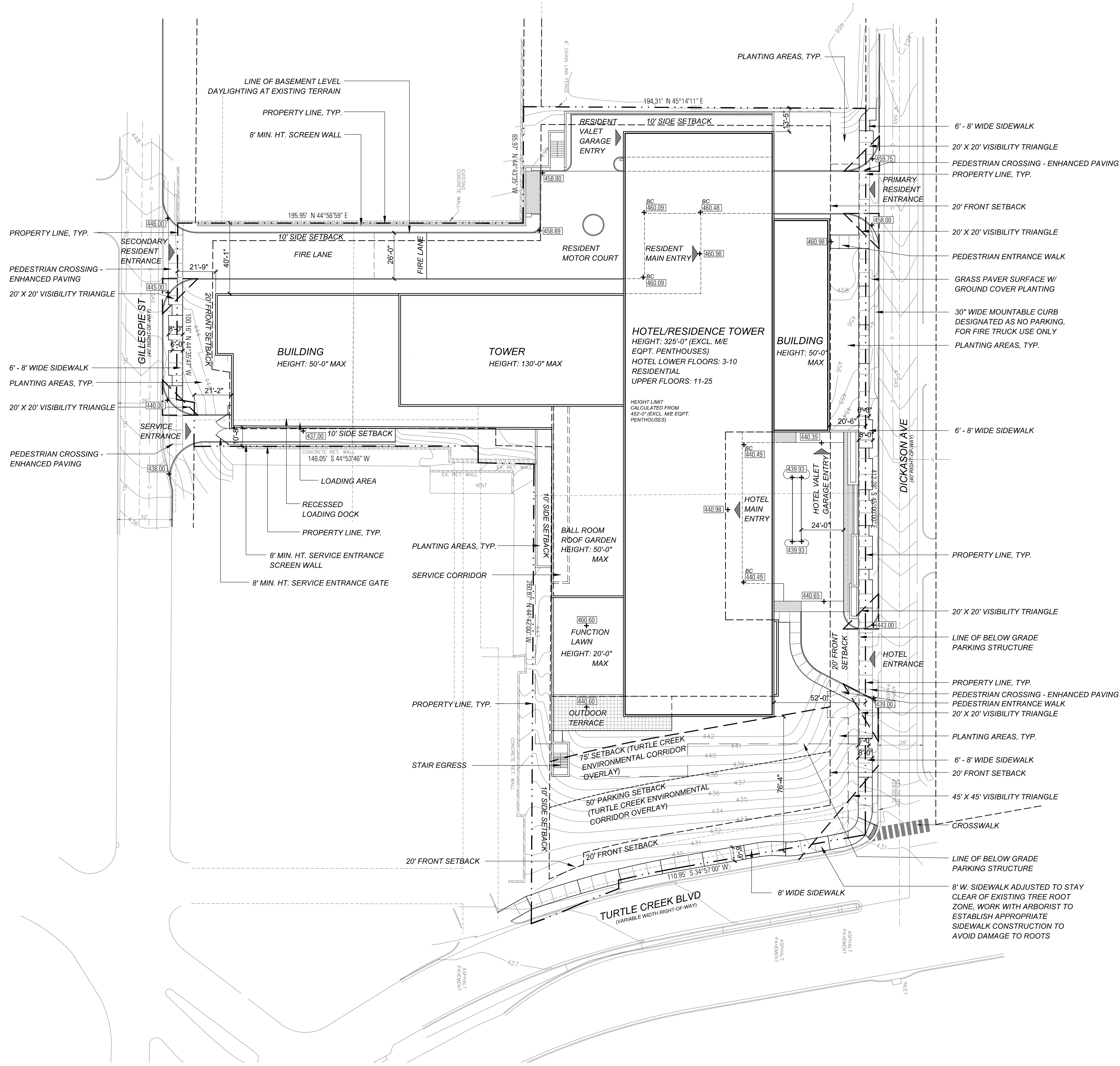

Project No.	18039	
Drawn By:	JY	
Checked By:	CT	
Date:	NOVEMBER 21, 2018	
Issued:		
Issued:		
Issued:		
Revisions:		
▲	UPDATES	01-18-19
▲	UPDATES	01-31-19
▲		
▲		

Sheet Title:
DEVELOPMENT PLAN

L1.00

Sheet No.:

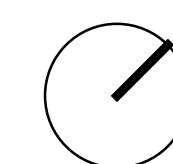

SCALE: 1" = 30'

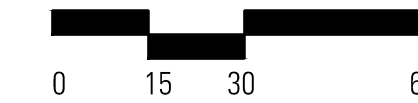

CASE #: Z- 189-136

DEVELOPMENT PLAN
2999 TURTLE CREEK BOULEVARD
Dallas, Texas 75219