

KILLION DR.

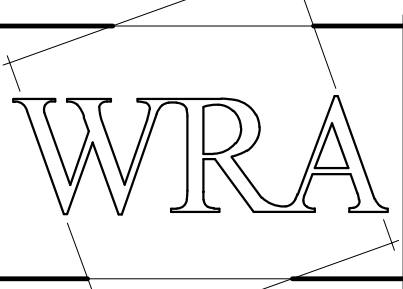
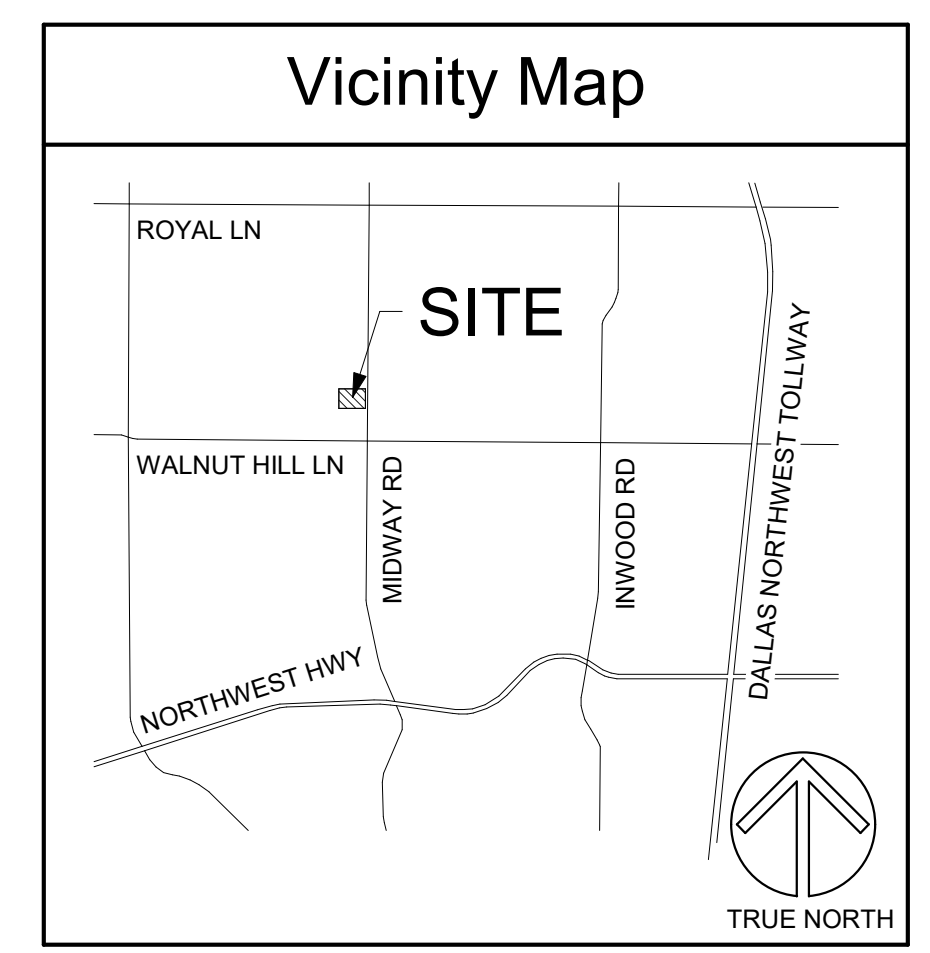

WRA Architects, Inc.  
12377 Merit Drive  
Suite 1800  
Dallas, Texas 75251  
214.750.0077 voice  
www.wraarchitects.com

**NOTE:**  
THIS PRELIMINARY DRAWING IS RELEASED UNDER THE AUTHORITY OF BETH A. STEVENS, L.S.A.E. REGISTRATION NO. 2384.  
THIS SHEET OF DRAWINGS IS INCOMPLETE AND SHALL NOT BE USED FOR REGULATORY APPROVAL, PERMIT APPLICATION OR CONSTRUCTION.

**SITE SUMMARY**

OWNER:  
DALLAS INDEPENDENT SCHOOL DISTRICT  
9400 N. CENTRAL EXPRESSWAY  
DALLAS, TX 75231

BLOCK 6149  
AREA: 6.94 ACRES

MAXIMUM BUILDING HEIGHT: 50 FEET

BUILDING AREA  
EXISTING: 47,800 SF  
NEW ADDITION: 117,800 SF  
TOTAL: 165,500 SF

CLASSROOMS  
EXISTING: 25  
PROPOSED: 8  
TOTAL: 33

PARKING  
REGULAR SPACES: 132  
HANDICAP SPACES: 10  
TOTAL: 142

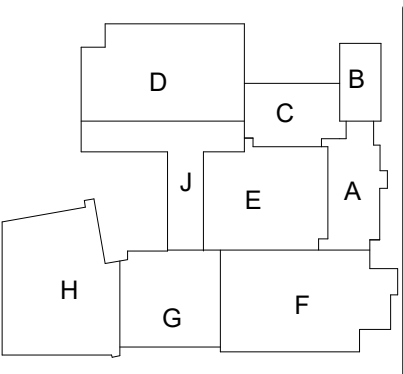

MIDWAY RD.

**NOT FOR CONSTRUCTION**

**Career Institute North at Walnut Hill**  
10115 Midway Rd, Dallas, TX 75229

NORTHCREST ROAD

FIELDFARE DR.

FIELDFARE COURT

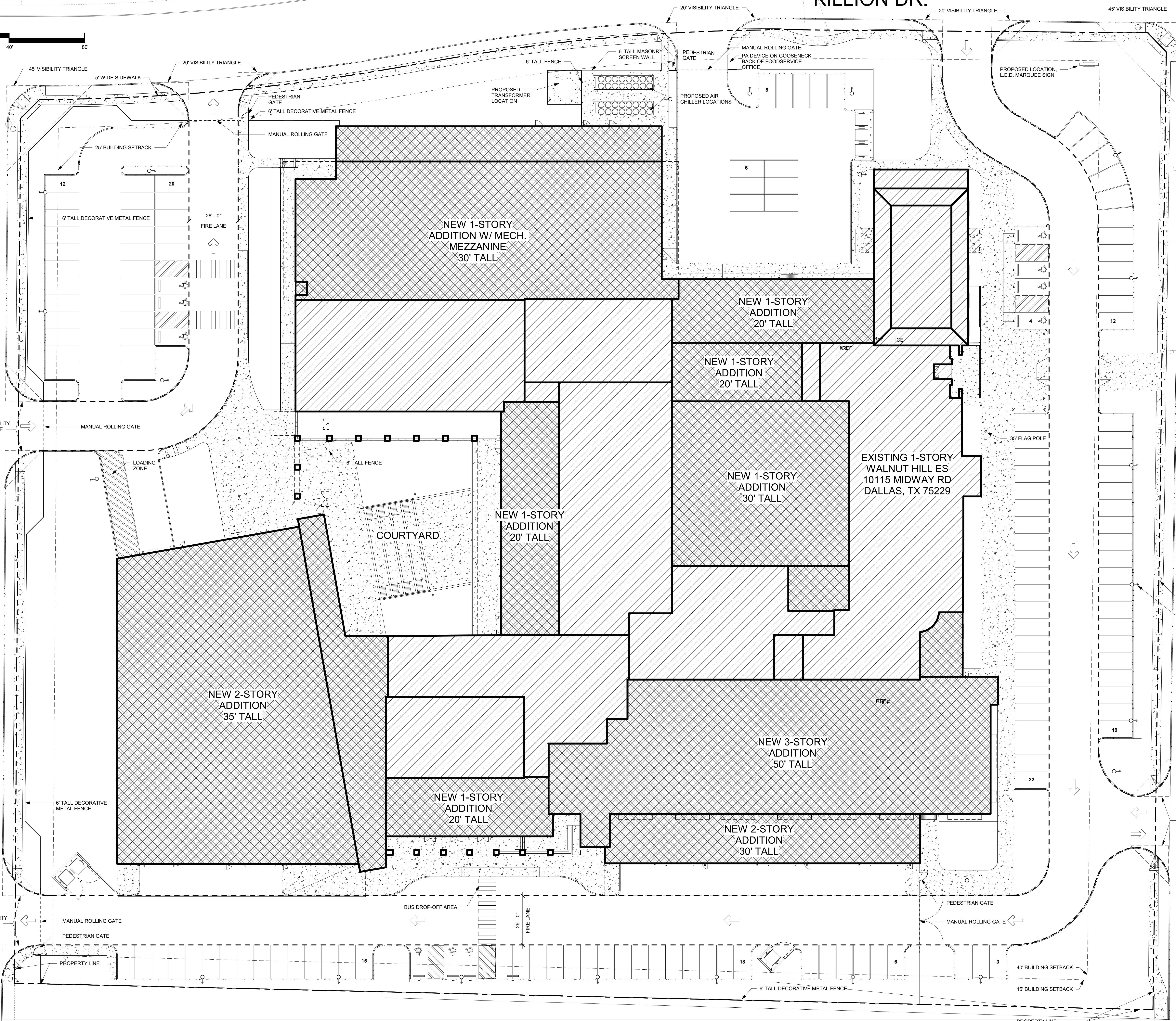

2/9/2021 7:17:07 AM



**1** Development Plan  
1" = 20'-0"

REVISIONS:  
No. Date

JOB NO. 1949  
DATE: 02/09/2021

Development Plan

Z100

© WRA Architects, Inc. 2020