

Plotted By: Rabin, Alex. Sheet: S&H-RICHARDSON INDUSTRIAL - Layout: 1.1. April 29, 2020. 05:11:31pm. K:\DAL\_CWA\068176077-KDC-Horwood\Cad\Exhibits\20200428-Development Plan\20200428-Development Plan.dwg  
 This document, together with the concepts and designs presented herein, is intended only for the specific purpose and client for which it was prepared. Reuse of and improper reliance on this document without written authorization and adaptation by Kimley-Horn and Associates, Inc. shall be without liability to Kimley-Horn and Associates, Inc.

ALLOWABLE USES PER PD 193 (HC)	SUBDISTRICT I	SUBDISTRICT II
PLANNED DEVELOPMENT AREA	0.92 ACRES 39,984 SQUARE FEET	0.80 ACRES 35,007 SQUARE FEET
MAX. BUILDING HEIGHT	450 FEET	450 FEET
FLOOR AREA RATIO	12.5:1	12.5:1
MAXIMUM LOT COVERAGE	-	-
COVERAGE @ 0'-20' HT	85%	85%
COVERAGE @ 20'-175' HT	100%	100%
COVERAGE @ 175'-350' HT	85%	85%
COVERAGE @ 350' HT AND ABOVE	65%	65%

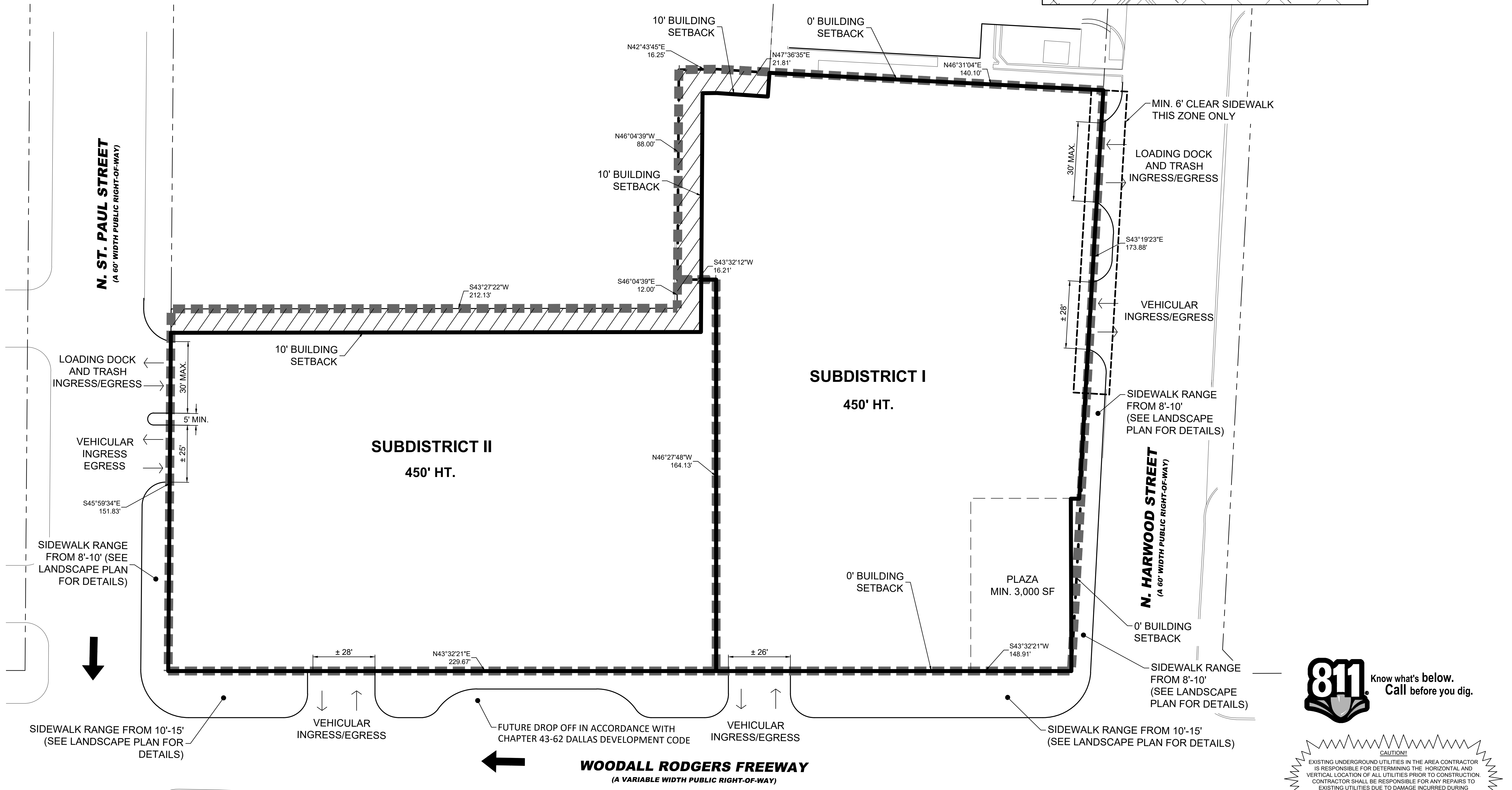
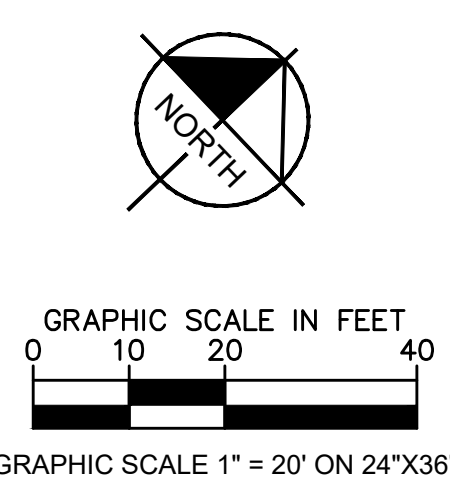
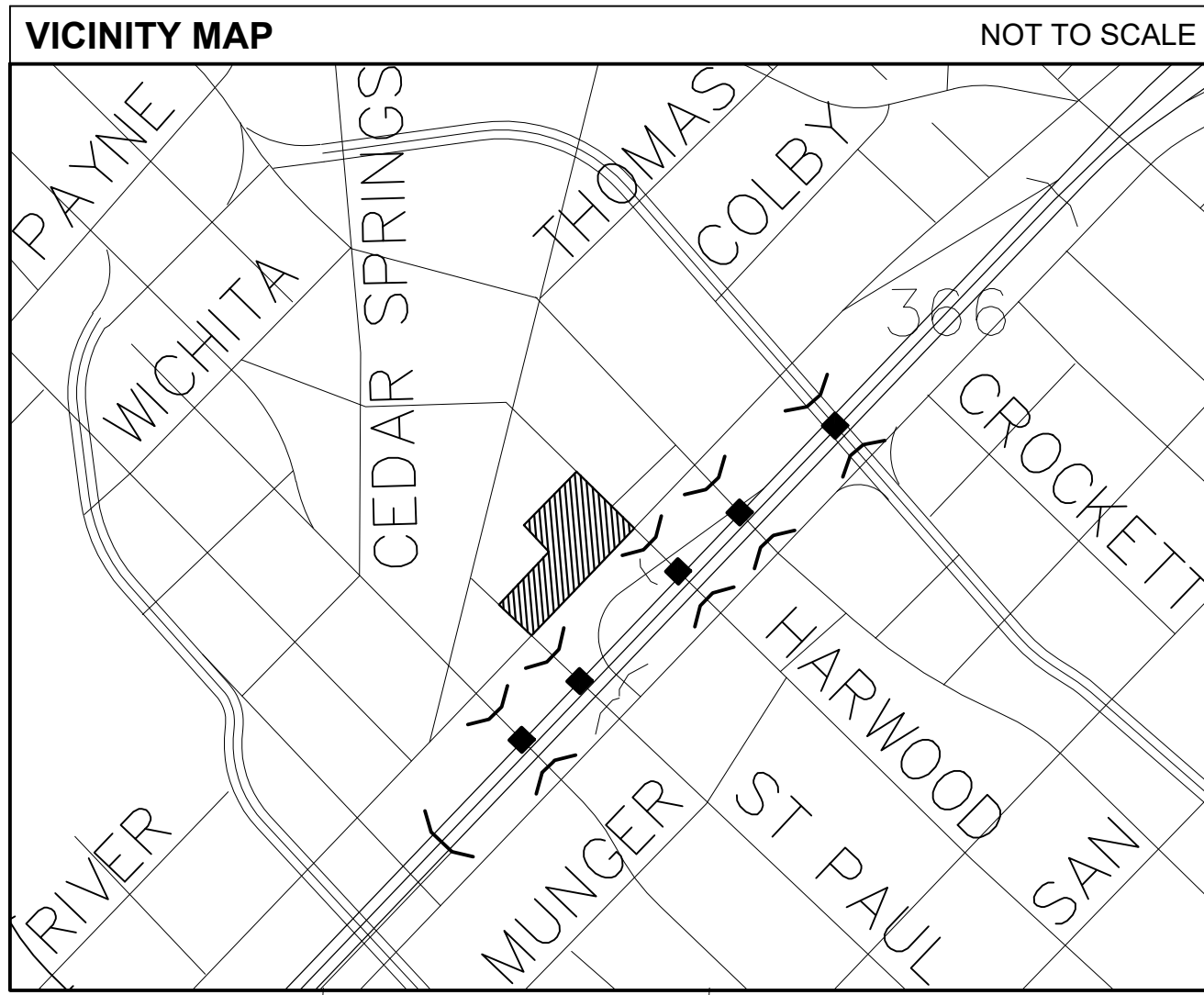
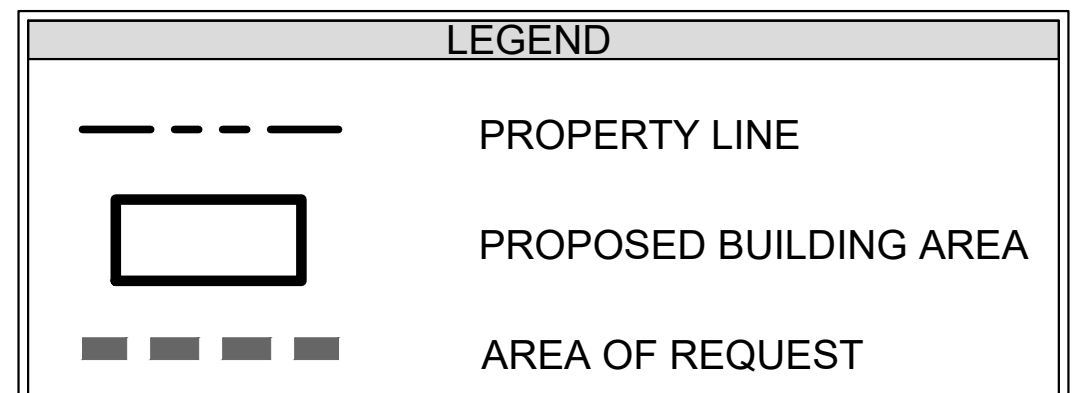

NO.	REVISIONS	DATE	BY

**Kimley-Horn**  
 13455 NOEL ROAD, TWO GALLERIA OFFICE TOWER  
 SUITE 700, DALLAS, TX 75240  
 PHONE: 972-770-1300 FAX: 972-239-8820  
 WWW.KIMLEY-HORN.COM  
 © 2020 KIMLEY-HORN AND ASSOCIATES, INC.

KHA PROJECT	DATE	SCALE	DESIGNED BY	DRAWN BY	CHECKED BY
068176077	APRIL 2020	AS SHOWN	RAE	AMK	BJM

PARKSIDE PREPARED FOR KDC  
 TEXAS  
 DALLAS

Z190-203 DEVELOPMENT PLAN  
 SHEET NUMBER 1



**CAUTION!**  
 EXISTING UNDERGROUND UTILITIES IN THE AREA CONTRACTOR IS RESPONSIBLE FOR DETERMINING THE HORIZONTAL AND VERTICAL LOCATION OF ALL UTILITIES PRIOR TO CONSTRUCTION. CONTRACTOR SHALL BE RESPONSIBLE FOR ANY REPAIRS TO EXISTING UTILITIES DUE TO DAMAGE INCURRED DURING CONSTRUCTION. CONTRACTOR SHALL NOTIFY THE ENGINEER OF ANY DISCREPANCIES ON THE PLANS.