

W 7TH STREET - ONE WAY

CASE # 2178-355

LOT AREA	16,263 SQ FT / .31 ACRES
RESTAURANT AREA	2,128 SQ FT
EXISTING BLDG AREA (HOTEL)	5,160 SQ FT
RESTAURANT BLDG HEIGHT	16'
REQUIRED PARKING SPACES	
RESTAURANT (ONE PER 125 SF)	17 PS
EXISTING BUILDING 1250 SQ FT	
PROPOSED ADDITION 848 SQ FT	
TOTAL 2128 SQ FT	
PROPOSED PARKING SPACES	
EXISTING	3 PS
PROPOSED	11 PS
ADA NEW	1 PS
VALET	- PS
W 7TH STREET	3 PS
TOTAL	18 PS

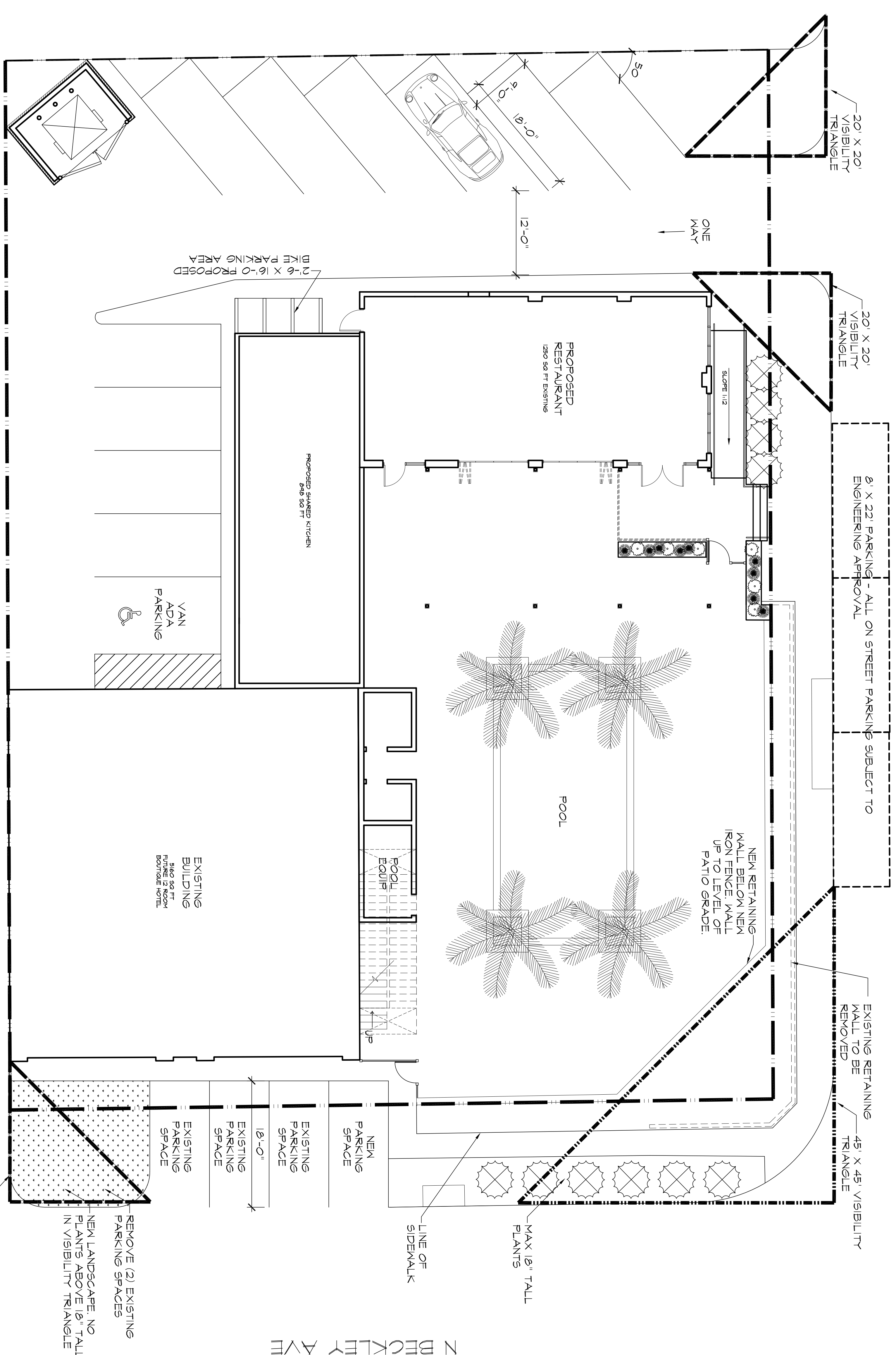

01 SITE PLAN
SCALE: 1/8" = 1'-0"

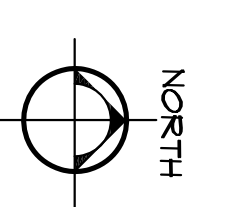

NOTE: ALL VISIBILITY TRIANGLES SHALL NOT HAVE ANY ENCROACHMENTS TALLER THAN 18"

MABEL'S
BISHOP ARTS

REMODEL OF AN EXISTING SPACE

411 N. BECKLEY AVE.
DALLAS, TX 75206

ALL RIGHTS RESERVED. NO PART OF THESE DRAWINGS OR SPECIFICATIONS MAY BE COPIED, REPRODUCED OR USED IN CONNECTION WITH ANY WORK OTHER THAN THE SPECIFIC PROJECT FOR WHICH THEY HAVE BEEN PREPARED. PERMISSION FOR ANY WRITTEN AUTHORIZATION FROM DUNCAN DESIGN GROUP.

DESIGN CONSULTANT



1850 MANUFACTURING ST.
SUITE 003
DALLAS, TX 75207
TEL: 214-786-4400 FAX: 214-398-4401
WWW.DUNCANDESIGNGROUP.COM

ISSUE:	
REVISIONS:	
DATE:	07/13/18
PROJECT #:	404
SHEET NAME:	SITE PLAN

A0.0