

W. 7TH STREET

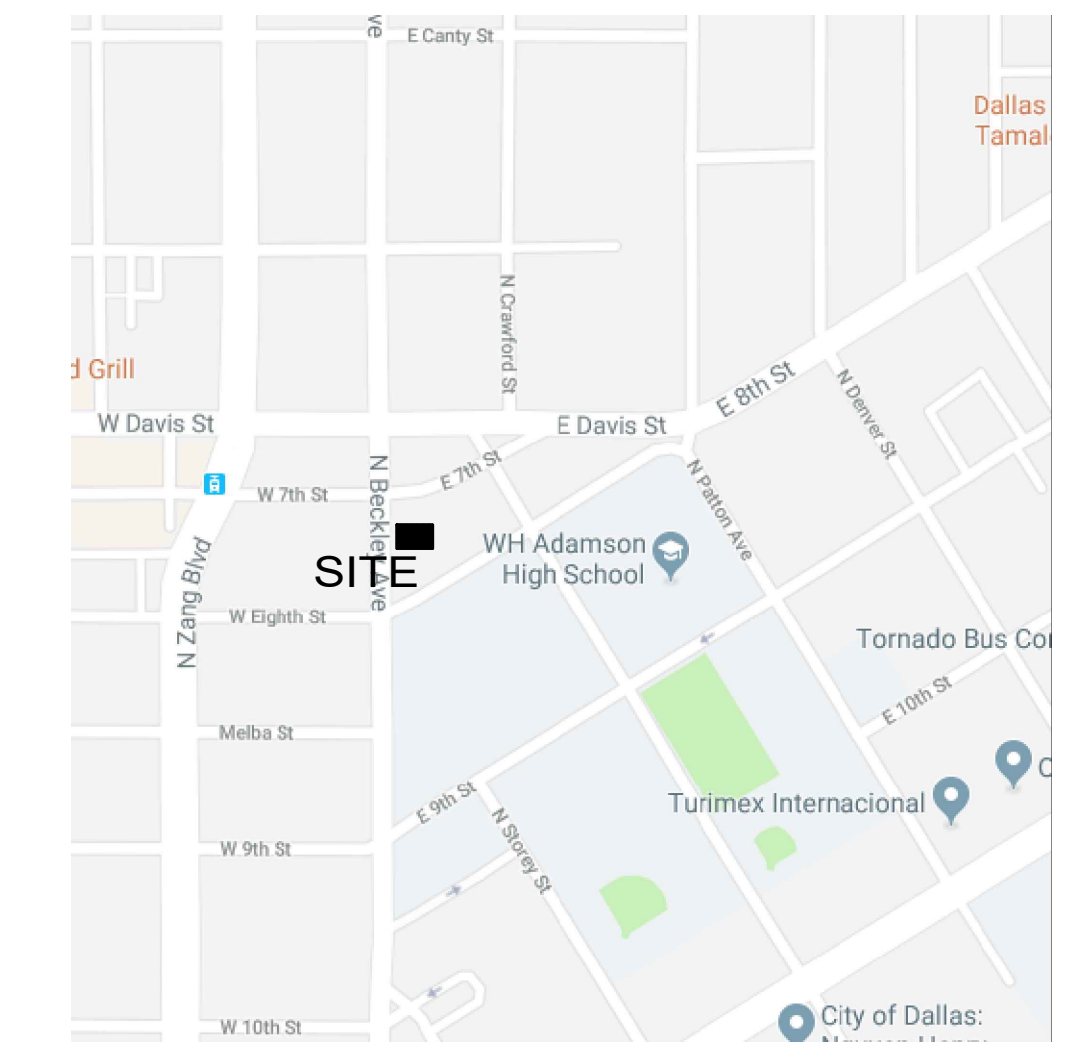

VICINITY MAP

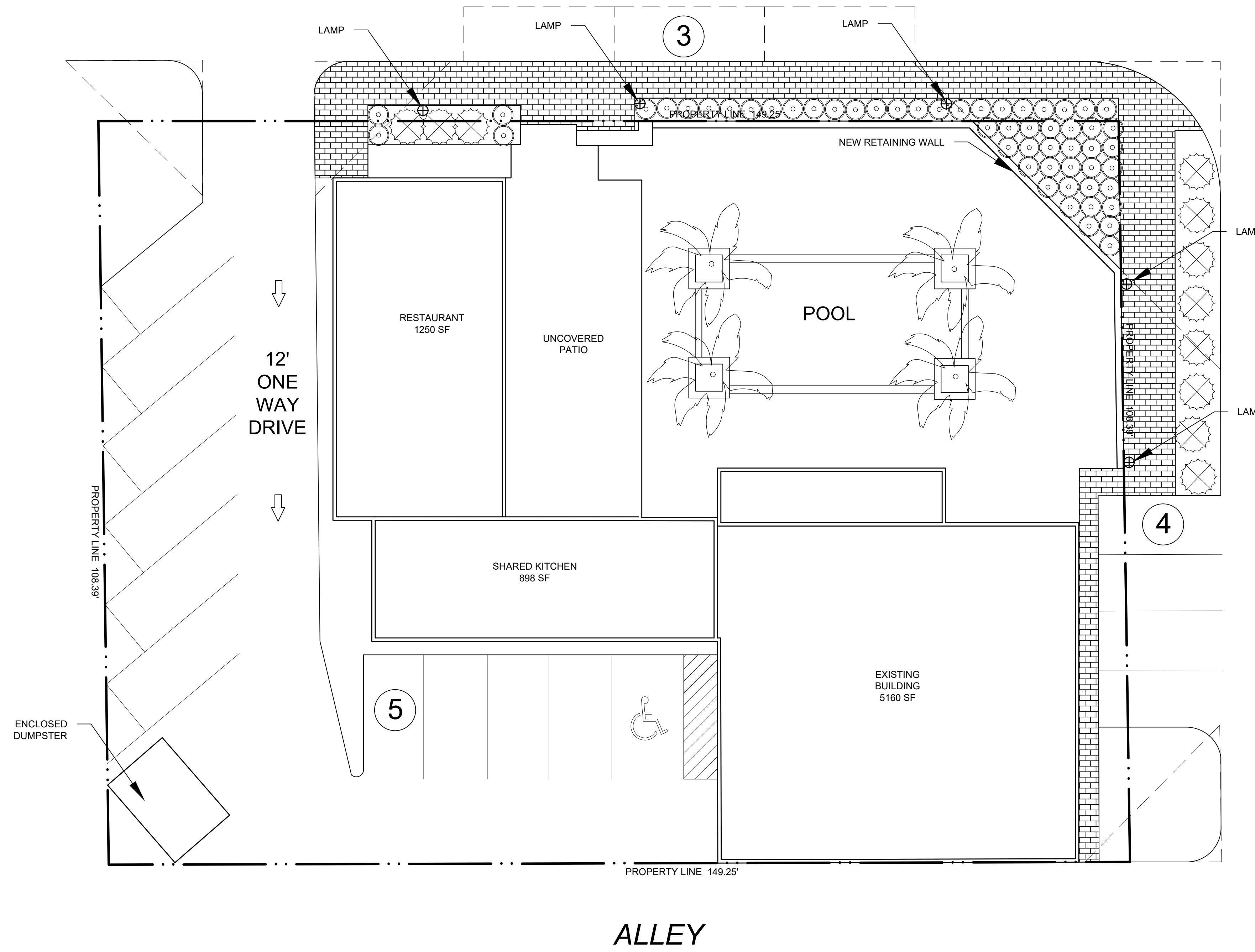
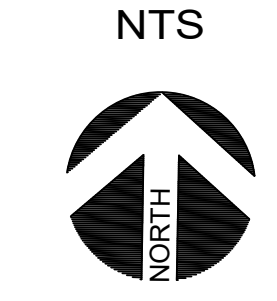

05/15/2019
PROJECT NUMBER
CASE NUMBER

BALDWIN ASSOCIATES
3904 Elm Street, Suite B
Dallas, Texas 75226
MOBILE: 214.729.7949
OFFICE: 214.824.7949
rob@baldwinplanning.com



SITE INFORMATION

SITE AREA: 16,262 SF (0.37 ACRES)
USE: RESTAURANT & BOUTIQUE HOTEL

LANDSCAPE REQUIREMENTS

TREES
SITE TREES REQUIRED: 4 TREES
($\frac{1}{4000}$ SF OF SITE AREA)
SITE TREES PROVIDED: 4 TREES

STREET TREES REQUIRED: 6 TREES
(1/40 LF OF FRONTAGE; 257.64 LF)
STREET TREES PROVIDED: 0 TREES

DESIGN OPTIONS

- (6) URBAN STREETSCAPE
- ii. PEDESTRIAN STREET LAMPS ($\frac{1}{60}$ LF OF FRONTAGE) = 5 LAMPS
- iii. ENHANCED SIDEWALK WITH STAMPED CONCRETE OR PAVERS

POINTS ACHIEVED: 10

IRRIGATION

AN AUTOMATIC IRRIGATION SYSTEM SHALL BE INSTALLED PER CITY REQUIREMENTS FOR ALL NEW LANDSCAPING

N. BECKLEY AVENUE

ALLEY

PLANT MATERIAL LIST SUMMARY CHART

QNTY	CANOPY TREES; CITY APPROVED OPTIONS		SIZE
4	WINDMILL PALM	<i>Trachycarpus fortunei 'Bulgaria'</i>	8" CAL.; 12' MIN HT; 45 GAL MIN. CONT.
	POND CYPRESS	<i>Taxodium ascendens</i>	2" CAL.; 12' MIN HT; 45 GAL MIN. CONT.
	DESERT WILLOW	<i>Chilopsis linearis</i>	2" CAL.; 12' MIN HT; 45 GAL MIN. CONT.
SHRUBS; OPTIONS			
12	SOFT LEAF YUCCA	<i>Yucca recurvifolia</i>	12" SPRD; 18" MIN HT; 5 GAL CONT
	RED YUCCA	<i>Hesperaloe parvifolia</i>	12" SPRD; 18" MIN HT; 5 GAL CONT
	REGAL MIST MUHLY	<i>Muhlenbergia capillaris</i>	12" SPRD; 18" MIN HT; 5 GAL CONT
	PARRY AGAVE	<i>Agave parryi</i>	12" SPRD; 18" MIN HT; 5 GAL CONT
55	AUTUMN SAGE	<i>Salvia greggii</i>	8" SPRD; 30" MAX HT; 1 GAL CONT
	MEXICAN FEATHER GRASS	<i>Nassella tenuissima</i>	8" SPRD; 30" MAX HT; 1 GAL CONT

HARDSCAPE MATERIALS

- ⊕ PEDESTRIAN LAMPS; TO BE CHOSEN BY OWNER; SUBJECT TO A PRIVATE LICENSE OR RELOCATED WITHIN THE PROPERTY LINES
- ◻ ENHANCED PEDESTRIAN WALKWAY PAVEMENT; SUBJECT TO PUBLIC WORKS APPROVAL

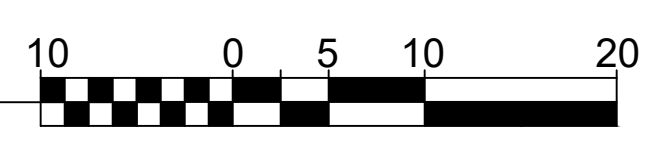
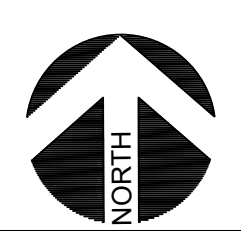

411 BECKLEY AVENUE
DALLAS, TX