

Hampton Traffic Management Plan 2019

Hampton SUP NO. 1661 Renewal

Z178-336 Dallas, Texas



Elizabeth Crowe
May 15, 2019

Prepared for
Uplift Education

Prepared by

Elizabeth Crowe Engineering Associates, PLLC
TBPE Firm Registration No. 20105

May 2019

INTRODUCTION/OVERVIEW

Hampton Preparatory School located at 8915 S. Hampton Road in Dallas, Texas operates under Special Use Permit No. 1661 (SUP). Part of the SUP renewal process includes review of the current student drop-off and pick-up operations. Observations were made in the Fall of 2018 and a TMP Update was prepared and submitted to the City of Dallas in September 2018. A proposed recommendation included in this September 2018 document was to construct a driveway extension on the Primary School campus off Westfall Drive.

Communication in March 2019 from Mr. Carlos A. Talison, MPA of the City of Dallas Planning Department, included the following comments for the Hampton Primary Campus:

- Primary School-Exhibit 5, TMP must be revised to “no queueing on Westfall Drive”.

Primary School – Exhibit 5

- Immediately after entering off of Westfall Drive queue vehicles in two lines for both arrival and dismissal to reduce queueing on Westfall Drive.
- Proposed driveway extension for the primary school must be part of the development plan.
- TMP exhibits must be revised to show “police officers only” on city right-of-way.

The City of Dallas did not prepare any comments relative to the Secondary School TMP and operations.

At the time of the Fall 2018 campus observations, the Senior Director of Campus Support was Mr. Layne Fisher of Uplift Education. Since that time, a new Operations Director, Mr. Byron Walker, has joined the Hampton Preparatory School staff and pick-up operations have improved.

In April 2019, additional observations were made during the afternoon pick-up operations at the Hampton campus by Elizabeth Crowe Engineering Associates, PLLC. No vehicles were observed queued on South Hampton Road during either afternoon of observations.

City of Dallas staff, Mr. David Nevarez, reviewed the comments from the City of Dallas, and edited the City of Dallas request of Hampton Preparatory. No extension of a driveway on campus would be required, however a police officer would be required at the entry to the Primary School campus if there were queued vehicles on Westfall Drive. It was also requested that the TMP Exhibit distinguish between Police Officers and School Staff Personnel in the legend on the TMP.

PRIMARY SCHOOL CURRENT and PROPOSED OPERATIONS

Generally, the parents line up inside the campus in two lines leaving the middle lane open. Typical operations during the afternoon pick-up are illustrated in Photos 1 and 2. A police officer is posted at the entry at Westfall Drive to provide traffic control assistance as shown in Photo 2.



Photo 1 – Two lines of Vehicles Queued inside Campus

April 15, 2019 3:25 PM

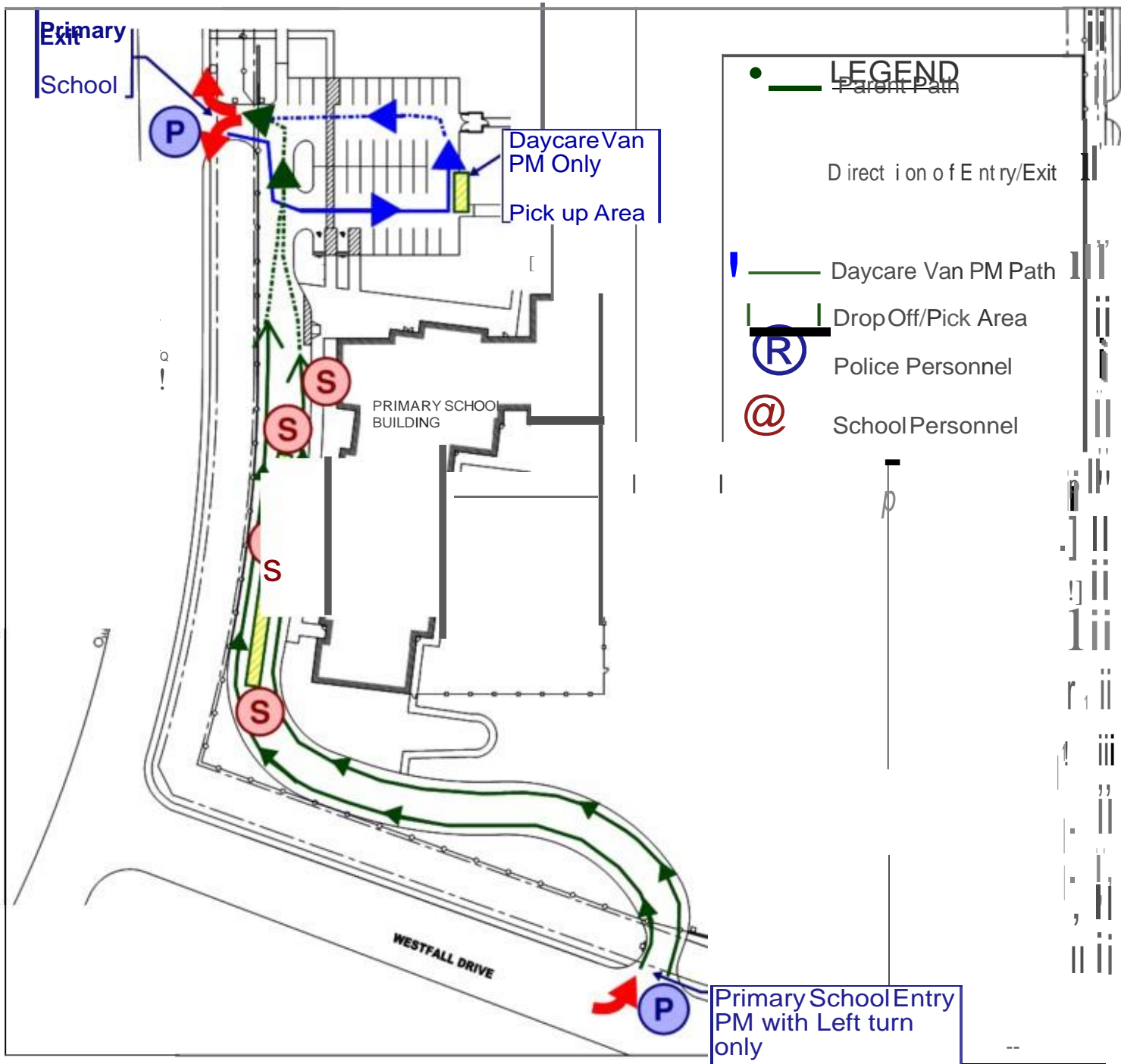

**Photo 2 – Police Assistance on Westfall Drive
April 15, 2019 3:42 PM**

The parents follow an orderly manner to pick up the students. One specific recommendation to improve the initial queuing conditions prior to school dismissal would be to have the motorists move the vehicles closer together.

Both items requested by Mr. David Nevarez have been included in the prepared TMP for Hampton Primary School as illustrated in **Exhibit 1**. In addition, the recommendation to provide entry into the Primary Campus with only a left turn movement from eastbound Westfall Drive has been made.

The Secondary School TMP has also been provided in **Exhibit 2** to illustrate the operations for both the north and the south sides of the Secondary School Building. The Middle School Scholars are typically dropped off and picked up on the north side of the school building and the Senior High School Scholars are dropped off and picked up on the south side of the school building.



Hampton

Preparatory School

Primary School TMP

Afternoon Pick up Operations

May 2019

Exhibit 1



Beckleymeade Avenue

Stoneview Drive

S. Hampton Road

Hampton Preparatory School

Secondary School TMP

May 2019
Exhibit 2

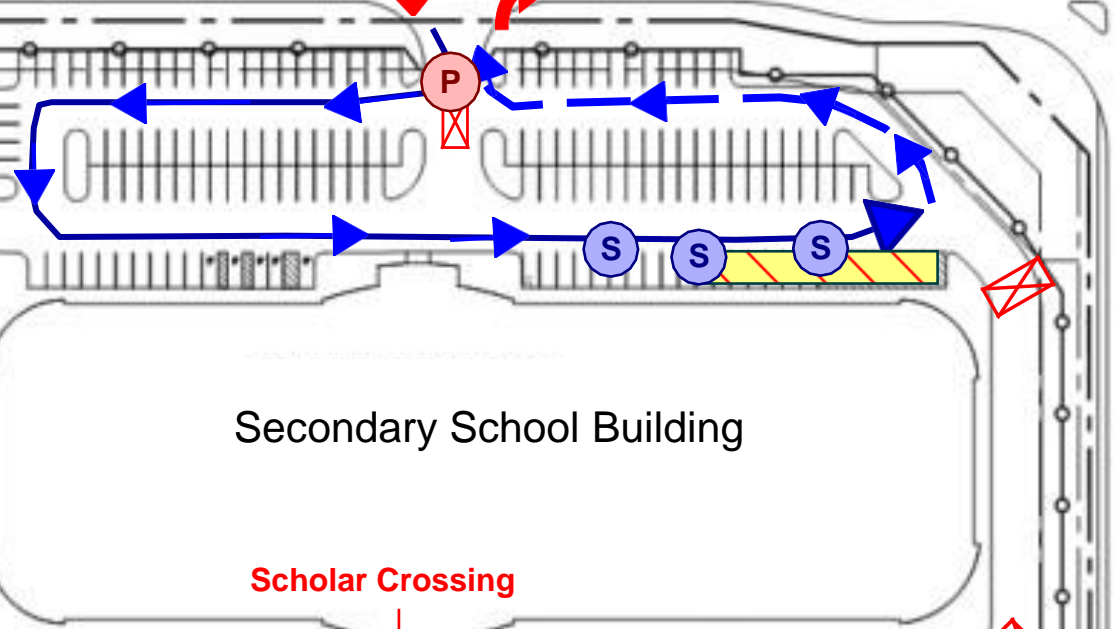

Secondary School Building

Scholar Crossing

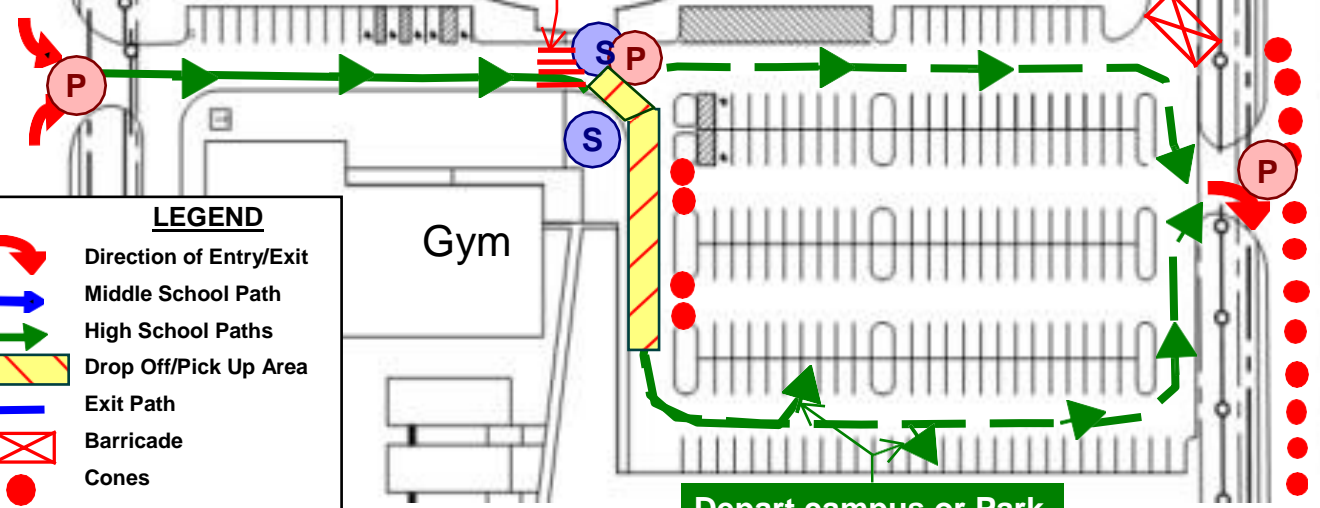

Depart campus or Park and wait for Scholar

LEGEND

-  Direction of Entry/Exit
-  Middle School Path
-  High School Paths
-  Drop Off/Pick Up Area
-  Exit Path
-  Barricade
-  Cones
-  School Staff
-  Police Personnel

SUMMARY AND RECOMMENDATIONS

Elizabeth Crowe, P.E. performed observations in April 2019 to review the existing carline operations at both the Primary and the Secondary Schools at Hampton Preparatory.

The following recommendations are provided to increase the efficiency of the Primary School carline procedures and reduce the likelihood of vehicles queued on S. Hampton Road waiting to enter the Hampton Campus.

- During the PM pick-up operations, restrict entry from westbound Westfall Drive (right turn movement) into the Primary School campus. Only allow vehicles to enter from eastbound Westfall Drive with a left turn.
- Educate the carline staff members, police assistance, parents and students of the elements in the TMP to achieve more efficient processes for the drop-off and pick-up operations.
- Have parents continue to move up in the queue line of vehicles in front of them to decrease the peak queue length. Do not leave gaps in the line; move forward. Hampton staff may need to initially “train” the parents, grandparents and those picking of the scholars on the procedures.
- Maintain an off-duty uniformed officer on campus to assist with directing school traffic when necessary.

The school administration including the Primary School Principal, Ms. Kecia Clark and Mr. Byron Walker, Operations Director at Hampton Preparatory School is acutely aware of the Transportation Management Plan; staff have also alerted the police officers who provide traffic control assistance for the school of the TMPs as illustrated in **Exhibit 1** and **Exhibit 2**.

SCHOOL OFFICIAL SIGNATURE BLOCK

Name: Mr. Byron Walker

Title: Operations Director

Signature:  _____