

VICINITY MAP  
NO SCALE

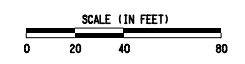

DATA:

CANOPY AREA	1,630 SQFT
4 CANOPIES TOTAL	6,520 SQFT
CANOPY HEIGHT	12'-4"
PARKING SPACES	191
ACCESSIBLE SPACES	6
BUS BAYS	4
SITE AREA	216,040 SQFT

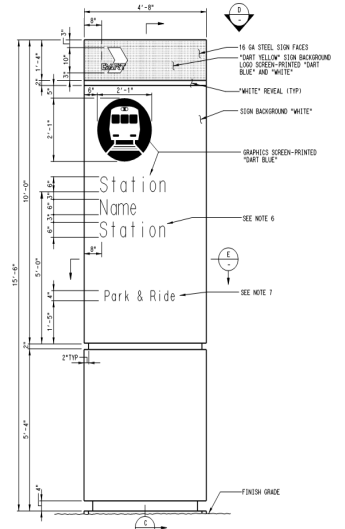
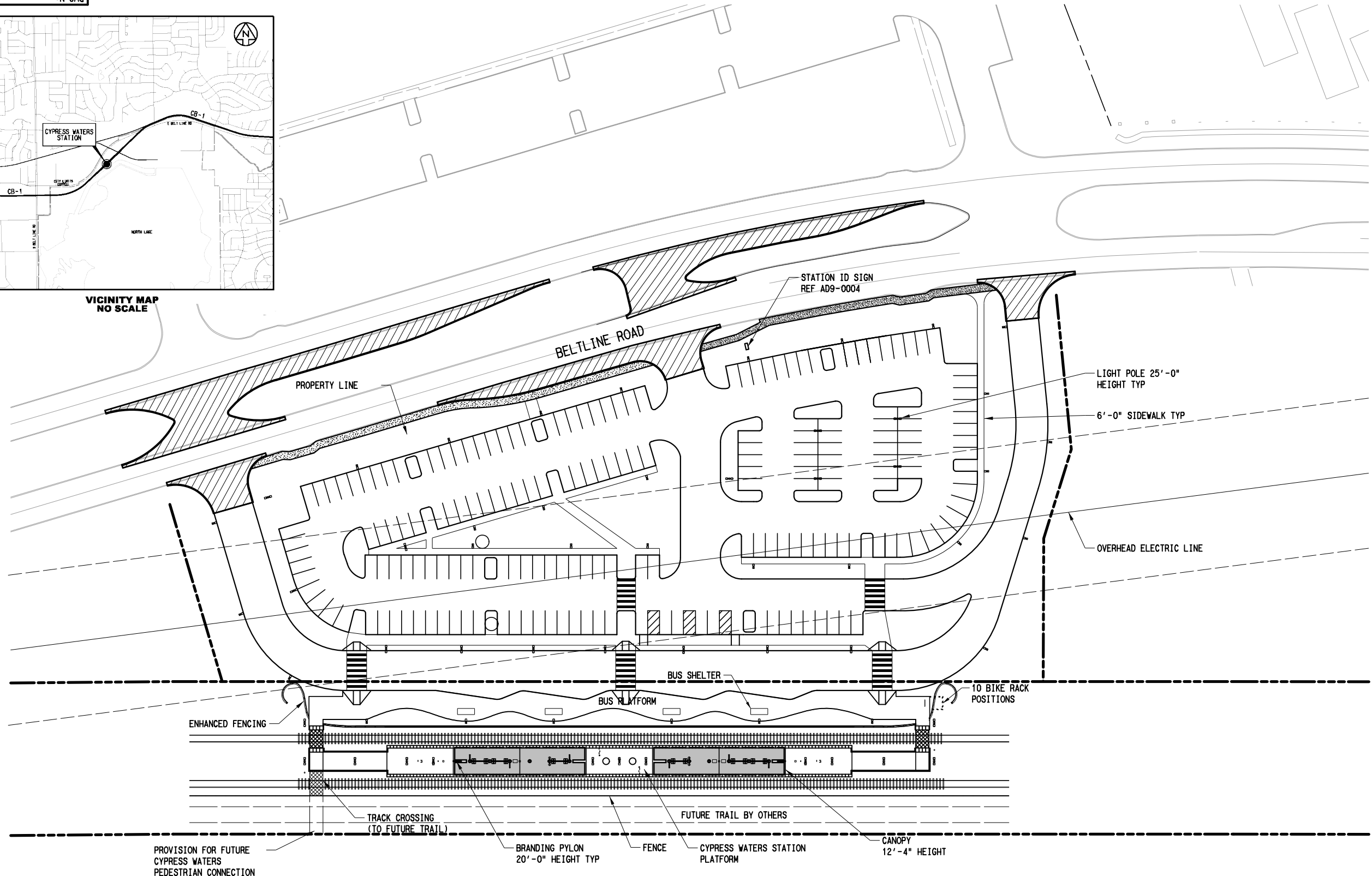

STATION NAME = CYPRESS WATERS STATION

ELEVATION 1  
SCALE: 1" = 1'-0"

**ARCHITECTURAL SITE PLAN A**  
SCALE: 1" = 40'-0"

\* CITY OF DALLAS IS RESPONSIBLE FOR FUNDING AND IMPLEMENTATION OF FUTURE TRAIL

NOT AN APPROVED DRAWING

CONTRACT SHEET No. 37 OF 92

COTTON BELT REGIONAL RAIL LINE SECTION CB-1  
CYPRESS WATERS STATION ARCHITECTURAL SITE PLAN

REV	AMEND	CR	DATE	DESCRIPTION	BY	ENG	CHK	APP

**IN-PROGRESS REVIEW**  
THIS DOCUMENT IS RELEASED FOR THE PURPOSE OF REVIEW UNDER THE AUTHORITY OF:  
ROBERT MANLEY, R.A. 20027  
ON  
30-JUL-2020 17:36  
JACOBS  
TBPE FIRM NO. F-2966  
IT IS NOT TO BE USED FOR CONSTRUCTION, BIDDING, OR PERMIT PURPOSES.



**DART PROJECT**

© DART, all rights reserved, 1987-2020

SCALE	1" = 40'-0"
DRAWN	K. SURGUINE
DESIGNED	M. DEBLIEUX
CHECKED	R. MANLEY
IN CHARGE	A. ZREET
DATE	22 JUN 20

CONTRACT C-2033270-01	DWG No. AC1-5301	REV D
-----------------------	------------------	-------

30-JUL-2020 17:36  
CB01-AC1-5301.040

DeBlieux  
Default