

DAVIS STEET

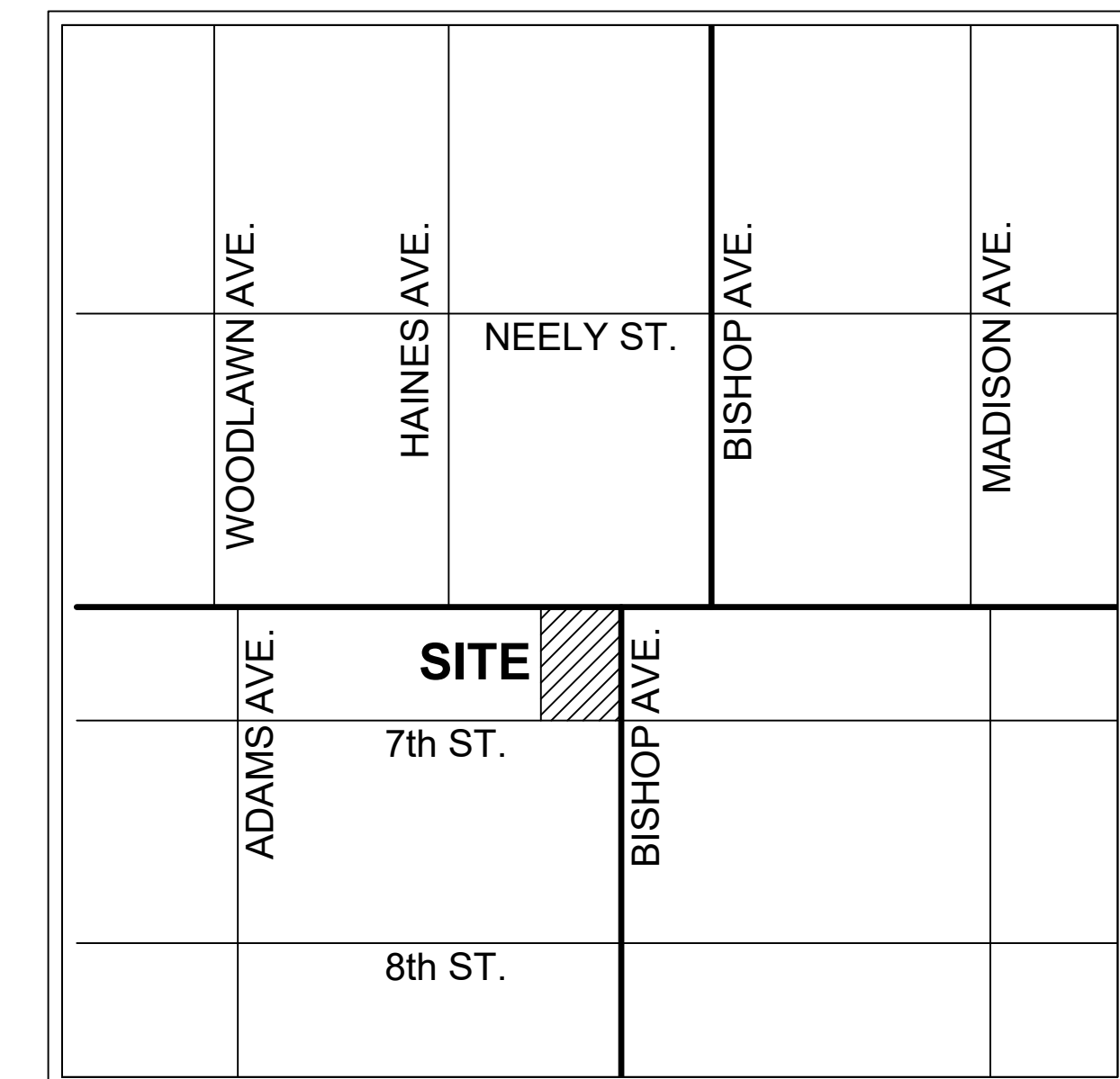

VICINITY MAP
NTS

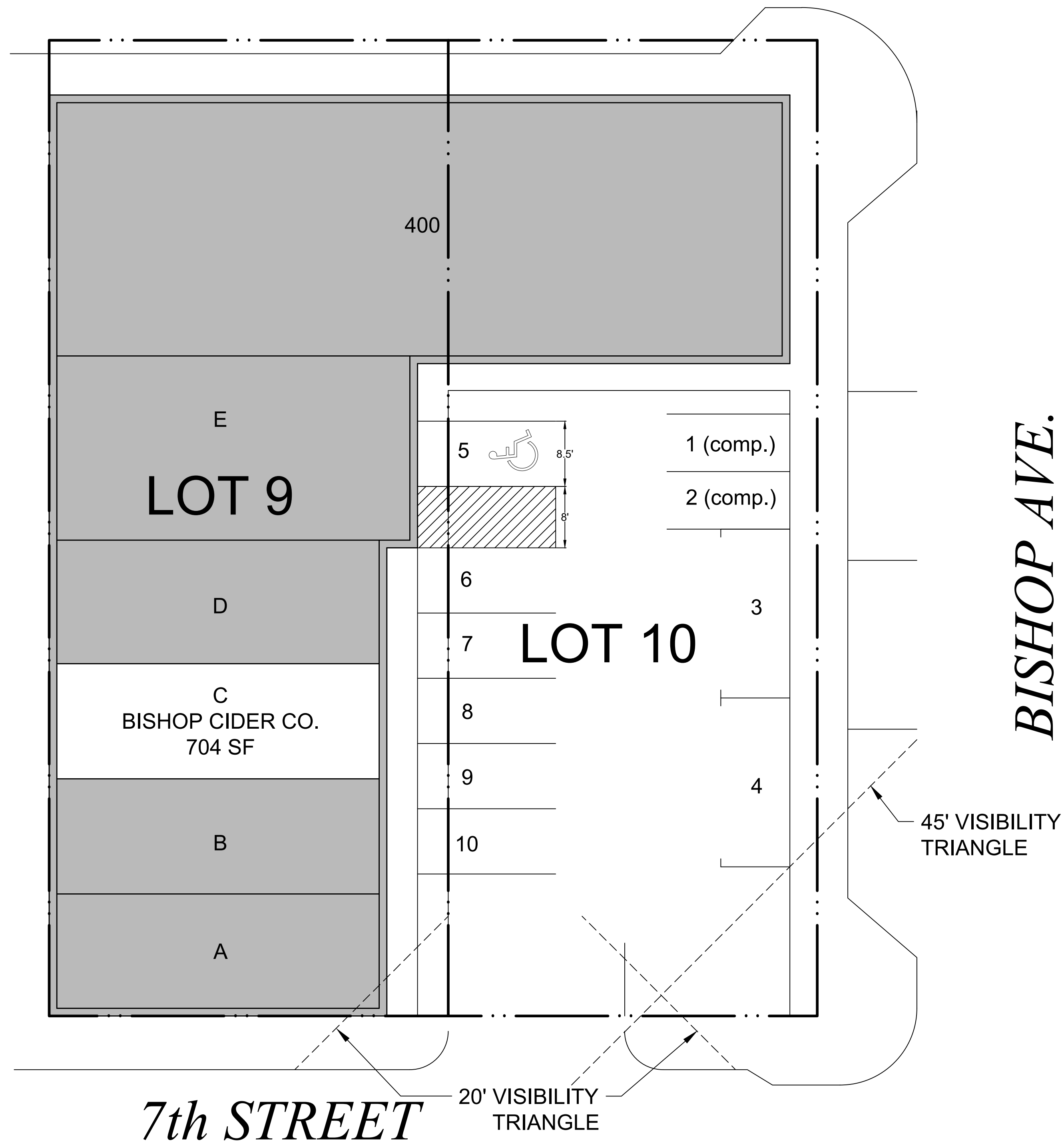
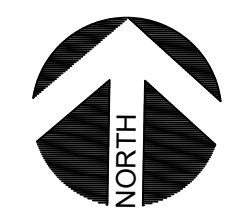

Existing Parking Analysis for 509 N Bishop/400 W Davis						
Suite	DBA	Use	SF	Ratio	Reqd	Comments
A	DJ Nails	Per. Serv	700	400	2	
B	Leg Citi	Retail	720	400	2	Boutique Hoisery
C	Prima Donna Fashion Boutique	Retail	704	400	2	
D	YaYa	Retail	800	400	2	Boutique
E	Salon on Bishop	Per. Serv	900	400	2	
400	Lockhart's	Restaurant	2,000	220	9	
Total SF			5,824		19	

Proposed Parking Analysis for 509 N Bishop/400 W Davis						
Suite	DBA	Use	SF	Ratio	Reqd	Comments
A	DJ Nails	Per. Serv	700	400	2	
B	Leg Citi	Retail	720	400	2	Boutique Hoisery; 2 Deltas
C	Bishop Cider	Winery	704	220	3	2 Deltas; 1 required
D	YaYa	Retail	800	400	2	Boutique
E	Salon on Bishop	Per. Serv	900	400	2	
400	Lockhart's	Restaurant	2,000	220	9	5 Deltas; 4 Required
Total SF			5,824		20	11 Required after Deltas

Parking Summary		Site Information	
Total Parking spaces required:	20	Base Zoning:	CD-7/CS Subarea 2
- Total Parking spaces provided on site	10	Lot Area:	12500 Sq.Ft. (.287 AC)
- Delta credits:	9	Front Yard Setback:	0'-5'
- Parking provided by agreements:	1	Side Yard Setback:	0'
Parking provided over (+) or under (-) requirement:	0	Rear Yard Setback:	0'
		Building Height:	24'
		Floor Area Ratio:	0.47 (all uses)

09/13/2018
PROJECT NUMBER
CASE NUMBER

PERMITTED DEVELOPMENT
416 S. Ervay Street
Dallas, Texas 75201
214.686.3635
www.permitteddevelopmentdfw.com

509 N. BISHOP STE. C
CITY OF DALLAS, TEXAS

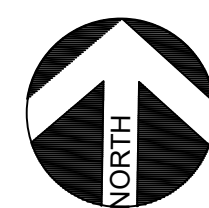

BISHOP CIDER CO. SITE PLAN

SCALE: 1" = 40'-0"

