

**LEGEND**

- EXISTING CONTOURS
- PROPERTY LINE
- 100-YEAR FLOODPLAIN EASEMENT
- EXISTING STRUCTURE
- PROPOSED LANDSCAPE AREA
- PHASE I CONSTRUCTION OF TRANSFER STATION (SEE NOTE 7)
- FUTURE EXPANSION CONSTRUCTION PREVIOUSLY APPROVED

- NOTES:**
1. WHILE THESE 34 PARKING SPACES WILL BE REMOVED, THE REMAINING PARKING SPACES EXCEED THE MINIMUM SPACES REQUIRED BY SUP CONDITION NO. 7.  
PARKING NOTE: GREATER THAN 262 OFF-STREET PARKING STALLS WILL BE PROVIDED.
  2. EXISTING ENTRANCES HAVE BEEN IMPROVED SINCE ISSUANCE OF SUP IN 2002.
  3. THE INTERIOR PROPERTY LINE ILLUSTRATES THE EXISTING PROPERTY DIVISION BETWEEN 1990 CALIFORNIA CROSSING AND 2010 CALIFORNIA CROSSING.
  4. DRAINAGE AND FLOODPLAIN EASEMENTS, ALONG WITH THE EXISTING PROPERTY LINES WERE TAKEN FROM EXISTING PLATS ON FILE WITH THE CITY OF DALLAS.
  5. FLOODPLAIN DELINEATION IS BASED ON FLOODPLAIN INSURANCE RATE MAP, DATED NOVEMBER 1999, OBTAINED FROM CITY OF DALLAS FLOODPLAIN ADMINISTRATOR'S OFFICE ON MAY 11, 2001.
  6. EXISTING CONTOURS WERE TAKEN FROM AN AERIAL SURVEYS PERFORMED BY METROPOLITAN AERIAL SURVEYS ON APRIL 27, 2001.
  7. PHASE I CONSTRUCTION OF THE TRANSFER STATION WILL BE TOTALLY WITHIN THE APPROVED 20,000 S.F. FOOTPRINT.

10/2/2019 2:48 PM G:\001\18218013.00\_T10 - Civil Design for Maintenance Building\_DWG SITE PLAN

CASE NO: M189-035  
CASE HISTORY: Z178-229

**PREPARER**  
SCS ENGINEERS  
1901 CENTRAL DRIVE, SUITE 550  
BEDFORD, TEXAS 76021  
(817) 571-2288  
CONTACT: KEVIN YARD, P.E.

**APPLICANT/  
OWNER/DEVELOPER**  
COMMUNITY WASTE DISPOSAL, LP  
2010 CALIFORNIA CROSSING  
DALLAS, TEXAS 75220  
(972) 392-3900  
CONTACT: GREG A. ROEMER

REV	DATE	DESCRIPTION	DWN BY	DES BY	CHK BY	APP BY
Δ	08/19	PHASE I OF TRANSFER STATION	JLJ	KDY	KDY	KDY
	08/2019		JLJ	KDY	KDY	KDY

**SCS ENGINEERS**  
STEARNS, CONRAD AND SCHMIDT  
CONSULTING ENGINEERS  
1901 CENTRAL DRIVE, SUITE 550, BEDFORD, TX 76021  
PH (817) 571-2288 FAX NO. (817) 571-2188

FOR PERMITTING PURPOSES ONLY

COMMUNITY WASTE DISPOSAL  
DALLAS, TEXAS  
2010 CALIFORNIA CROSSING  
TRANSFER STATION AND MRF ADDITION  
**SITE PLAN**

DRAWING NO.  
**1**  
16218013.00 T11

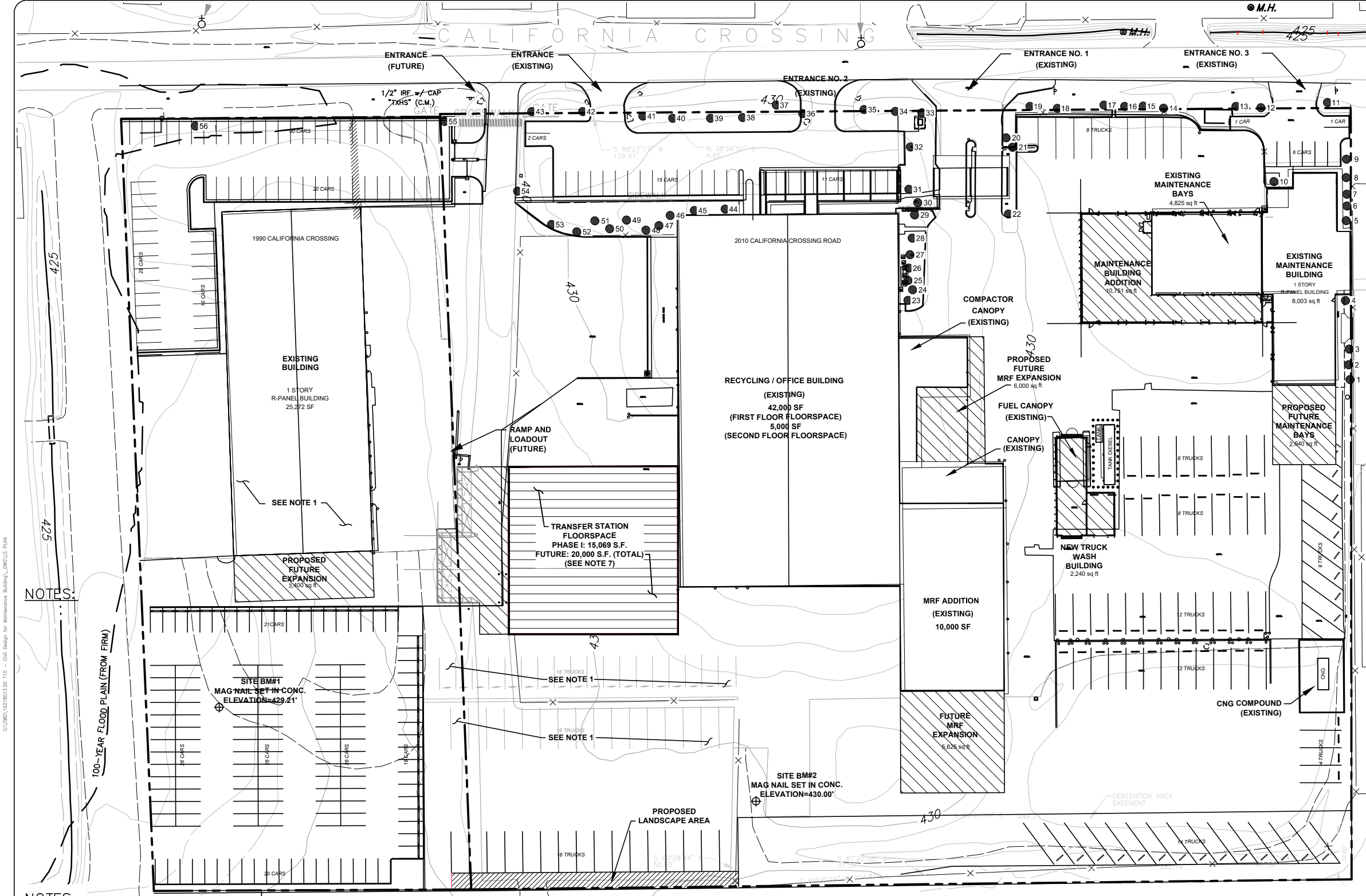

0 40 80  
SCALE IN FEET

**LEGEND**

- 11 EXISTING TREES
- 4.30 EXISTING CONTOURS
- - - - - PROPERTY LINE
- - - - - 100-YEAR FLOODPLAIN EASEMENT
- EXISTING STRUCTURE
- ▨ PROPOSED LANDSCAPE AREA
- ▩ PHASE I CONSTRUCTION OF TRANSFER STATION (SEE NOTE 7)
- ▧ FUTURE EXPANSION CONSTRUCTION PREVIOUSLY APPROVED

**TREE SURVEY CHART**

Point Table			Point Table (Cont.)		
Point #	Raw Description	DIA. (IN.) 2018	Point #	Raw Description	DIA. (IN.) 2018
1	Bald Cypress	12	29	Cedar Elm	7
2	Bald Cypress	10	30	Cedar Elm	6
3	Bald Cypress	10	31	Red Oak	17
4	Live Oak	16	32	Red Oak	18
5	Eastern Red Cedar	9	33	Live Oak	15
6	Eastern Red Cedar	10	34	Live Oak	13
7	Eastern Red Cedar	10	35	Live Oak	15
8	Eastern Red Cedar	8	36	Live Oak	15
9	Eastern Red Cedar	7	37	Post Oak	32
10	Crepe Myrtle	8	38	Live Oak	16
11	Live Oak	15	39	Live Oak	12
12	Live Oak	9	40	Live Oak	16
13	Live Oak	10	41	Live Oak	16
14	Live Oak	9	42	Live Oak	15
15	Live Oak	10	43	Live Oak	16
16	Live Oak	11	44	Live Oak	10
17	Live Oak	10	45	Live Oak	10
18	Live Oak	10	46	Eastern Red Cedar	8
19	Live Oak	10	47	Eastern Red Cedar	8
20	Cedar Elm	5	48	Eastern Red Cedar	8
21	Sugarberry	6	49	Eastern Red Cedar	8
22	Chinese Pistache	10	50	Eastern Red Cedar	8
23	Cedar Elm	12	51	Eastern Red Cedar	6
24	Cedar Elm	7	52	Eastern Red Cedar	9
25	Cedar Elm	9	53	Eastern Red Cedar	12
26	Cedar Elm	10	54	Bur Oak	32
27	Cedar Elm	9	55	Cedar Elm	12
28	Cedar Elm	11	56	American Elm	12
Summary		645	Summary		645

**NOTES:**

- WHILE THESE 34 PARKING SPACES WILL BE REMOVED, THE REMAINING PARKING SPACES EXCEED THE MINIMUM SPACES REQUIRED BY SUP CONDITION NO. 7.  
PARKING NOTE: GREATER THAN 262 OFF-STREET PARKING STALLS WILL BE PROVIDED.
- EXISTING ENTRANCES HAVE BEEN IMPROVED SINCE ISSUANCE OF SUP IN 2002.
- THE INTERIOR PROPERTY LINE ILLUSTRATES THE EXISTING PROPERTY DIVISION BETWEEN 1990 CALIFORNIA CROSSING AND 2010 CALIFORNIA CROSSING.
- DRAINAGE AND FLOODPLAIN EASEMENTS, ALONG WITH THE EXISTING PROPERTY LINES WERE TAKEN FROM EXISTING PLATS ON FILE WITH THE CITY OF DALLAS.
- FLOODPLAIN DELINEATION IS BASED ON FLOODPLAIN INSURANCE RATE MAP, DATED NOVEMBER 1999, OBTAINED FROM CITY OF DALLAS FLOODPLAIN ADMINISTRATOR'S OFFICE ON MAY 11, 2001.
- EXISTING CONTOURS WERE TAKEN FROM AN AERIAL SURVEYS PERFORMED BY METROPOLITAN AERIAL SURVEYS ON APRIL 27, 2001.
- PHASE I CONSTRUCTION OF THE TRANSFER STATION WILL BE TOTALLY WITHIN THE APPROVED 20,000 S.F. FOOTPRINT.

**PREPARER**  
SCS ENGINEERS  
1901 CENTRAL DRIVE,  
SUITE 550  
BEDFORD, TEXAS 76021  
(817) 571-2288  
CONTACT: KEVIN YARD, P.E.

**APPLICANT/  
OWNER/DEVELOPER**  
COMMUNITY WASTE DISPOSAL, LP  
2010 CALIFORNIA CROSSING  
DALLAS, TEXAS 75220  
(972) 392-3900  
CONTACT: GREG A. ROEMER

CASE NO: M189-035  
CASE HISTORY: Z178-229

REV	DATE	DESCRIPTION	DWN BY	DES BY	CHK BY	APP BY	
Δ	08/19	PHASE I OF TRANSFER STATION	JLJ	KDY	KDY	KDY	
DATE OF ISSUE	08/20/2019	DWN BY	JLJ	CHK BY	KDY	APP BY	KDY

**SCS ENGINEERS**  
STEARNS, CONRAD AND SCHMIDT  
CONSULTING ENGINEERS  
1901 CENTRAL DRIVE, SUITE 550, BEDFORD, TX 76021  
PH (817) 571-2288 FAX NO. (817) 571-2188

FOR PERMITTING PURPOSES ONLY

COMMUNITY WASTE DISPOSAL  
DALLAS, TEXAS  
2010 CALIFORNIA CROSSING  
TRANSFER STATION AND MRF ADDITION  
LANDSCAPE PLAN

DRAWING NO.  
**2**  
16218013.00 T11

10/2/2019 2:46 PM C:\DW\16218013.00 T11 - Civil Design for Maintenance Building\_LANDSCAPE PLAN