

CALCULATIONS

1. The lot coverage calculation

Building footprint = 21,433 (sf)
 Gas Canopy = 2,750 (sf)
 Total = 24,183 (sf)

The lot area = 100,377 (sf)

The lot coverage coefficient:

$A = 21,433 / 100,377 = 0.21$

2. The impervious surface calculation

a. All other impervious surfaces = 54,169 (sf)

b. The impervious surface = 21,433 + 2,750 + 54,169 = 78,352 (sf)

c. Coefficient

$B = 78,352 / 100,377 = 0.78$

3. Parking calculation:

Parking Provided = 108
 Parking Required = 107

4. Fencing = 6 feet high solid (wood) fencing

NOTES

1. Any general merchandise or food store will be 3,500 s.f. or less

2. Landscaping will comply with Article X with an additional 5' of landscaping provided along the northwestern property line and an additional 3' of landscaping provided along the southwestern property line as shown on the site plan.

3. No parking or vehicular traffic along the northeast of the property.

4. No parking along the west of the property.

5. An additional landscape buffer will be provided as follows:
 § 5' along the northeast
 § 3' along the west

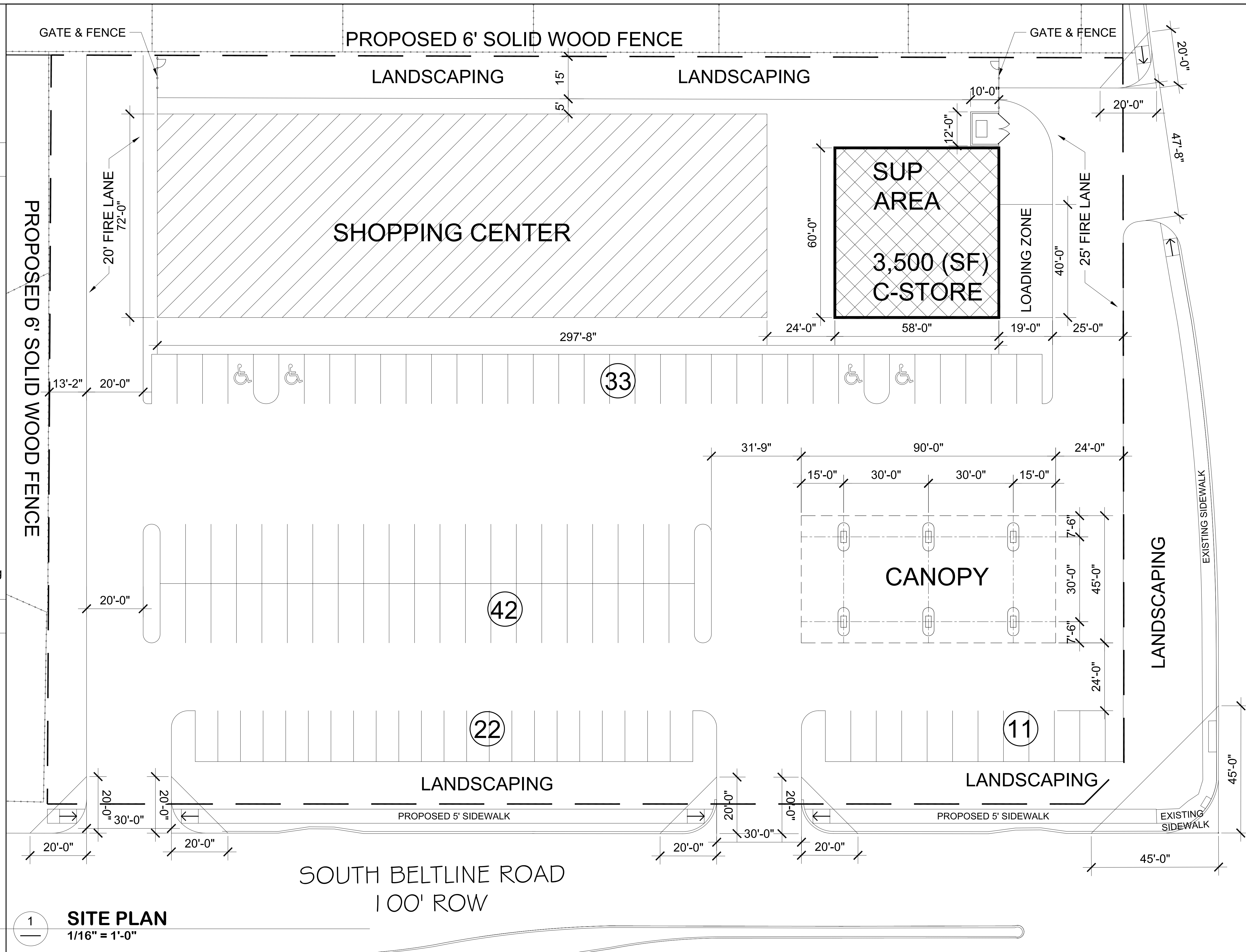

1 **SITE PLAN**
 1/16" = 1'-0"

DRAWN BY:	DATE: 05/24/2016	APPROVED BY:	REVISIONS	PROJECT	SHT. NAME	SHT. NO.
	DWG. NO.:	PROJ. NO.				
	DWG.					
1500 S BELTLINE ROAD, DALLAS, TX 75253				SITE PLAN		