

Existing Buildings and Buildings Under Development	Use	SF/Units	Zoning Required Parking Spaces	Locations of Required Parking Spaces	Provided Number of Spaces
American Airlines Center (AAC) 2500 Victory Ave.	Entertainment Complex Restaurant	832,979 SF 8,021 SF	5,000 0**	Lot A-13 (3098 Olive St.) K Block Garage (2223 Victory Ave.) Lot F (2721 N. Houston) Lot E (2617 Victory Ave.) Block D (2401 Victory Park Ln.) North Garage (2503 Victory Ave.) Platinum Garage (2620 N. Houston)	147 177 147 847 425 (152 **) 1257 2,000 5,000
Total AAC		841,000 SF Floor Area	5,000		5,000
Icon/Cirque - 2500 N. Houston Street 2900 & 2990 Olive Street Total Icon	Residential Restaurant General Merchandise/ Office	254 Units 7,649 SF 2,249 SF	286 **** 69 **** 4	Icon Garage Block D (2401 Victory Park Lane) One Victory Park Garage (2323 Victory Ave.)	392 4 69 *** 465
Total Icon		359,500 SF Floor Area	359		465
W Dallas Victory - 2400-2440 Victory Park Ln. (even numbers) Total W Dallas Victory	Hotel Residential Restaurant General Merchandise Banquet Hallstop	252 Rooms 153 Units 8,998 SF 13,600 SF 11,600 SF 1 Hallstop	113 **** 173 **** 81 **** 24 **** 52 **** 2	W Dallas Victory Garage Block D (2401 Victory Park Lane) One Victory Park Garage (2323 Victory Ave.)	520 37 68 *** 625
Total W Dallas Victory		707,300 SF Floor Area	445		625
The Residences at Victory/ Vista & Terrace - 2300-2350 Victory Park Ln. (even numbers) 3030 High Market Place, 2323 & 2345 N. Houston St. Total The Residences	Residential General Merchandise Restaurant	224 Units 23,484 SF 28,114 SF	252 **** 42 **** 254 ****	Residences Garage Block D (2401 Victory Park Lane) K Block Garage (2223 Victory Ave.) One Victory Park Garage (2323 Victory Ave.)	374 117 22 157 *** 670
Total The Residences		369,000 SF Floor Area	548		670
Victory Plaza Buildings - 3030 & 3090 Olive St., 2501 N. Houston St. Total Victory Plaza Buildings	Office Commercial TV Station Restaurant General Merchandise	192,900 SF 6,400 SF 39,800 SF 4,400 SF	347 **** 6 358 **** 8	Plaza Garage (420 Olive Street) Block D (2401 Victory Park Lane) One Victory Park Garage (2323 Victory Ave.)	220 257 (152 **) 242 *** 719
Total Victory Plaza Buildings		243,500 SF Floor Area	719		719
The House - 2200 Victory Ave., 3001-3023 Lamar St. Total The House	Residential General Merchandise Restaurant	133 Units 5,749 SF 21,149 SF	166 11 211	The House Garage K Block Garage (2223 Victory Ave.) One Victory Park Garage (2323 Victory Ave.)	384 29 110 *** 523
Total The House		332,000 SF Floor Area	388		523
Block L/One Victory Park - 2323 Victory Ave. Total One Victory Park	Office General Merchandise Restaurant	468,448 SF 8,484 SF 565 SF	937 17 6	One Victory Park Garage (2323 Victory Ave.)	1,179 (762 ***) 1,179
Total One Victory Park		477,497 SF Floor Area	960		1,179
Victory Center (Construction not Started) Total Victory Center	Office Restaurant	494,333 SF 9,154 SF	989 92	Victory Center	1,273 92 1,365
Total Victory Center		503,487 SF Floor Area	1,081		1,365
Victory Avenue Apartments - Lot N 2425 Victory Ave. Total Victory Ave. Apts.	Club/Leasing Office Residential	6,000 SF 378 Units	30 473	Block N Garage	570 570
Total Victory Ave. Apts.		440,000 SF Floor Area	503		570
Victory Apartments 1855 Payne Street Total Victory Apartments	Retail Residential	3,057 SF 119 Units	15 149	Blocks P & Q Garage	164 164
Total Victory Apartments		129,840 SF Floor Area	164		164
Camden Victory Park 2787 N. Houston St. (Construction not complete) Total Camden Victory Park	Residential	423 Units	529	Camden Garage	707 707
Total Camden Victory Park		486,236 SF Floor Area	529		707
Victory Place Lot G (1610 Payne St.) (Construction not Complete) Total Victory Place	Residential Retail	352 Units 8,250 SF	438 17	Victory Place Garage	490 17 507
Total Victory Place		365,000 SF Floor Area	455		507
Greystar Victory Apartments (Construction not Complete) Total Greystar Victory Apts.	Residential Restaurant	302 Units 3,000 SF	378 30	Greystar Victory Garage	466 30 496
Total Greystar Victory Apts.		360,000 SF Floor Area	408		496
Katy Station Lot H (2815 N. Houston St.) (Construction not Complete) Total Katy Station	Residential Retail Restaurant	461 Units 1,400 SF 600 SF	576 3 6	Katy Station Garage	628 3 6 637
Total Katy Station		498,895 SF Floor Area	585		637
Victory Block G (600 Museum Way) (Construction not Started) Total Victory Block G	Residential Cinema Restaurant Retail	283 Units 763 Seats 14,400 SF 8,403 SF	319 **** 138 **** 130 **** 15 ****	Victory Block G Garage	607 607
Total Victory Block G		430,000 SF Floor Area	602		607
Block D (2401 Victory Park Lane) (Construction not Complete) Total Block D	Retail Restaurant	9,096 SF 12,934 SF	16 **** 116 ****	Block D (2401 Victory Park Lane) One Victory Park Garage (2323 Victory Ave.)	16 116 *** 132
Total Block D		22,030 SF Floor Area	132		132
Additional Parking				DART Plaza Lot Block D (2401 Victory Park Lane) Lot C (1351 Broom St.) Lot M (2371 Victory Ave.) Lot B (600 Museum Way) Lot E (2617 Victory Ave.)	90 81 337 394 184 563 1,649
TOTAL DISTRICT		6,565,285 SF Floor Area	12,878		16,015

The Victory Place; Camden Victory Park; Victory Avenue Apartments; Victory Apartments; Icon Building; Residences at Victory and The House; One Victory Park; Two Victory Park; Block D, K Block and North Garage; W Dallas Victory, American Airlines Center and Victory Plaza Buildings; Greystar Victory Apartments; Katy Station; and Victory Block G floor area, use and structured parking garage information is provided by the Architects of Record for such projects (SRSA, Inc., Bury+Partners, Hensley Lamkin Rachel, Inc., Page Southerland Page, LLP, WDG Architecture, Inc., Boka Powell, HKS, Inc., VAI, Inc., Good Fulton and Farrel, Inc.; EDI International, Inc. and RTKL, respectively).

Currently, standard parking spaces on Lots A-13, E, F and North Garage are striped 9 feet wide, which exceeds the minimum requirements of the City of Dallas. The 9 feet wide standard parking spaces on said lots can be restriped to 8.5 feet wide standard spaces and to 7.5 feet wide compact spaces (compact spaces can account for 35% of all parking spaces), and accessible spaces on Lot F in excess of the minimum number of accessible spaces required Texas Accessibility Standards can be restriped to standard spaces. The Provided Number of Spaces for American Airlines Center on said parking lots assumes that a portion of the spaces on these lots are restriped to the minimum required by the City of Dallas.

The floor area and use information for the existing buildings and buildings under development is taken from the most recent City-approved development plans for such buildings.

The 841 spaces required to be within 400 feet from the American Center building are located on Lot E, Lot F, Block D, and Lot A-13, and in the Plaza Garage and the North Garage. The number of spaces located within 400 feet from the American Center building exceeds the required 841 spaces.

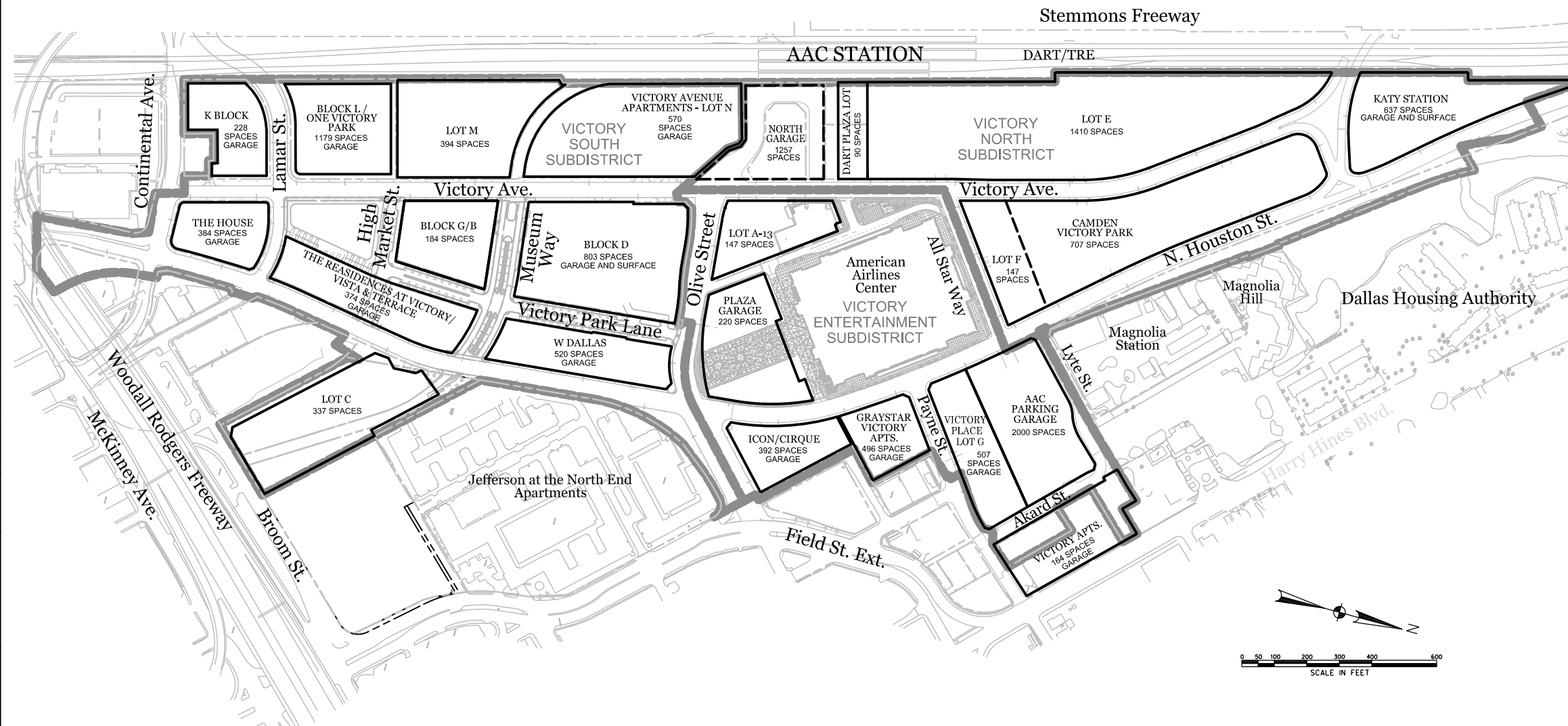

MASTER PARKING AND FLOOR AREA PLAN No. 11

Victory

Dallas, Texas

SEPTEMBER 25, 2015

SUBMITTED, IF APPLICABLE, WITH DEVELOPMENT PLAN/MINOR AMENDMENT: VICTORY BLOCK D

* 152 shared spaces between office and Entertainment Complex uses
 ** This establishment is an accessory use to the American Airlines Center and therefore has no separate parking requirement
 *** 762 shared spaces between office and restaurant uses
 **** spaces affected by 10% DART light rail reduction