

VICINITY MAP

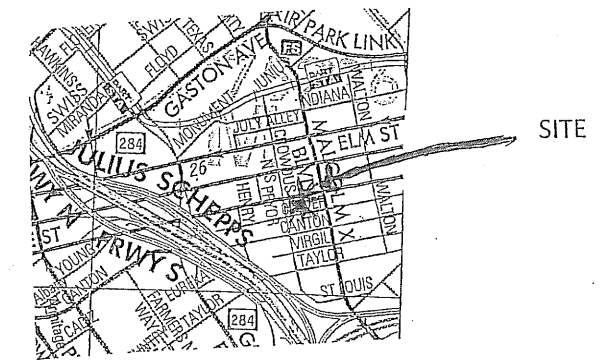

COMMERCE STREET

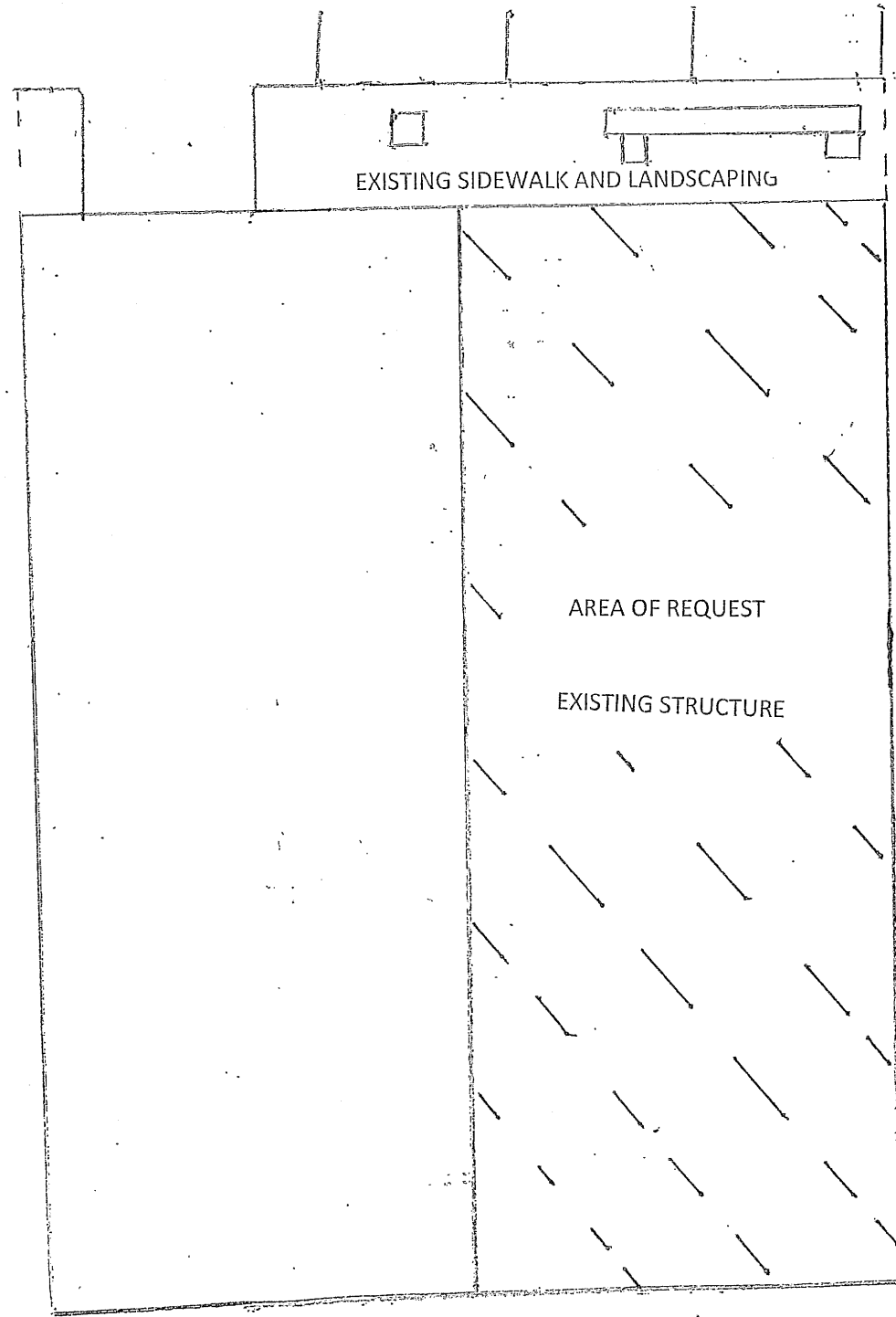

EXISTING SIDEWALK AND LANDSCAPING

AREA OF REQUEST

EXISTING STRUCTURE

125'

50'

CLOVER STREET

SITE SUMMARY

ZONING: PDD 269 (TRACT A)

USE: Microbrewery, microdistillery, or winery

FLOOR AREA: 6250

REQUIRED PARKING: 1

PROVIDED PARKING: 2

SCALE: 1" = 20'

Z167-346
SITE PLAN