

ABBREVIATIONS

M.R.D.C.T.= MAP RECORDS DALLAS COUNTY, TEXAS
 D.R.D.C.T.= DEED RECORDS DALLAS COUNTY, TEXAS
 O.P.R.D.C.T.= OFFICIAL PUBLIC RECORDS DALLAS COUNTY, TEXAS
 P.R.D.C.T.= PLAT RECORDS DALLAS COUNTY, TEXAS
 IRF= IRON ROD FOUND
 CIR5= 5/8" IRON ROD WITH CAP STAMPED "ADAMS SURVEYING COMPANY LLC"
 CIRF=CAPPED IRON ROD FOUND
 RAIL ROAD SPIKE FOUND
 R.O.W.= RIGHT-OF-WAY
 S.S.E.= STORM SEWER EASEMENT
 S.W.E.= STORM WATER EASEMENT
 W.E.= WATER EASEMENT
 U.E.= UTILITY EASEMENT

LEGEND

■ DRAIN
 ⊙ STORM SEWER MANHOLE
 ⊕ FIRE HYDRANT
 ⊙ SANITARY SEWER MANHOLE
 ⊕ WATER VALVE
 ⊙ WM WATER METER

LINE TABLE

LINE	BEARING	DISTANCE
L1	N 40°52'40" E	64.55'
L2	N 86°31'22" E	97.94'
L3	N 88°58'27" E	80.05'
L4	N 66°55'46" E	78.08'
L5	S 44°08'09" W	14.07'

CURVE TABLE

CURVE	RADIUS	ARC LENGTH	CHORD LENGTH	CHORD BEARING	DELTA ANGLE
C1	458.83'	96.36'	96.18'	N 07°45'19" E	12°01'56"
C2	564.25'	22.35'	22.35'	N 73°01'26" W	2°16'11"
C3	683.75'	240.03'	238.80'	N 09°06'37" E	20°06'49"
C4	720.23'	464.26'	456.27'	N 68°03'21" E	36°55'59"
C5	890.94'	337.15'	335.14'	N 75°29'19" E	21°40'53"
C6	5769.58'	199.49'	199.48'	S 17°40'37" E	1°58'52"
C7	532.93'	164.33'	163.68'	S 09°48'54" E	17°40'04"
C8	20.00'	39.15'	33.19'	S 56°59'32" E	112°09'24"

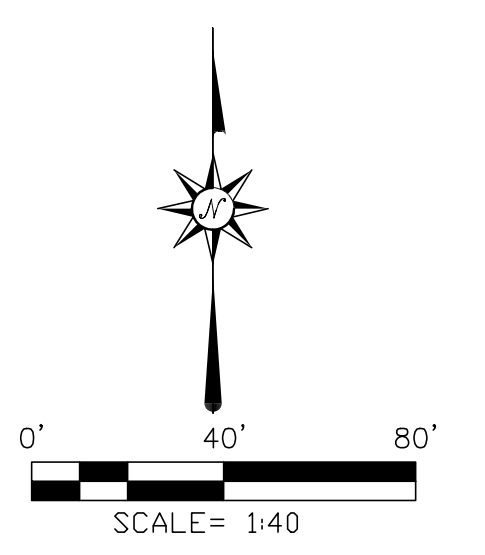
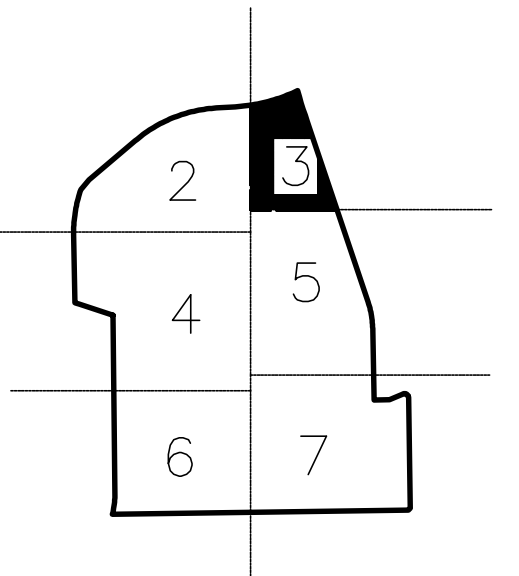
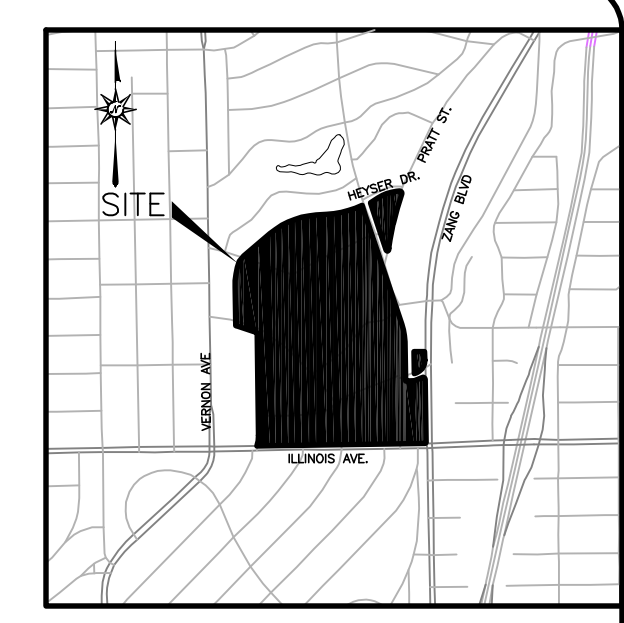

PURPOSE OF PLAT IS THE CREATION OF 1 LOT FROM A PLATTED PARCEL AND UNPLATTED LANDS

PRELIMINARY PLAT
WYNNEWOOD SHOPPING VILLAGE ADDITION
LOT 1A, BLOCK A/5973
 65.661 ACRES

BEING A REPLAT OF WYNNEWOOD SHOPPING VILLAGE ADDITION, AN ADDITION TO THE CITY OF DALLAS AS RECORDED IN VOLUME 22, PAGE 249 M.R.D.C.T.

PART OF LLEWELLYN AVE, WYNNEWOOD PLAZA, LUDLOW DR, ILLINOIS AVE. ABANDONED BY CITY ORD. NO. 19797 VOLUME 88034, PAGE 3178 D.R.D.C.T.

AND ACREAGE SET FORTH BY INSTRUMENT NO. 2010002337 BEING PART OF CITY BLOCKS A/5973, 52/5973, C/5973, D/5973, E/5973, F/5973 CITY OF DALLAS, DALLAS COUNTY, TEXAS SHEET 3 OF 8

CITY PLAN FILE NUMBER S178-004
 CITY ENGINEER FILE NO. SEPTEMBER ____, 2017

SURVEYOR
 ADAMS SURVEYING COMPANY, LLC
 P.O. BOX 260392
 PLANO, TEXAS 75026
 PH: (469) 317-0250
 CONTACT: Paul Hubert, R.P.L.S.
 Email: phubert@txasc.com

ENGINEER
 BOHLER ENGINEERING
 6017 MAIN STREET,
 FRISCO, TEXAS 75034
 PH: (469) 458-7300
 CONTACT: DEAN CARDWELL
 Email: dcardwell@bohlereng.com

OWNER
 BRIXMOR HOLDINGS 12 SPE, LLC.
 450 LEXINGTON AVE FL 13
 NEW YORK, NEW YORK 10017
 PH: (646) 344-8840
 CONTACT: RICK RAMSEY
 Email: rick.ramsey@brixmor.com

Adams
 surveying company, LLC
 TBPLS Firm Registration No. 10177500