

Block B 77289
Highland Hills Addition, Eleventh Installment
Vol 69143, Pg 2373
THE HOLLOWAYS NORTH
Vol 77046, Pg 1256

Lot 1-A, Block A, 7289
Highland Hills Addition Tenth Installment
Vol 69121, Pg 1798
HIGH HILLS CONDOMINIUMS
Vol 80142, Pg 243

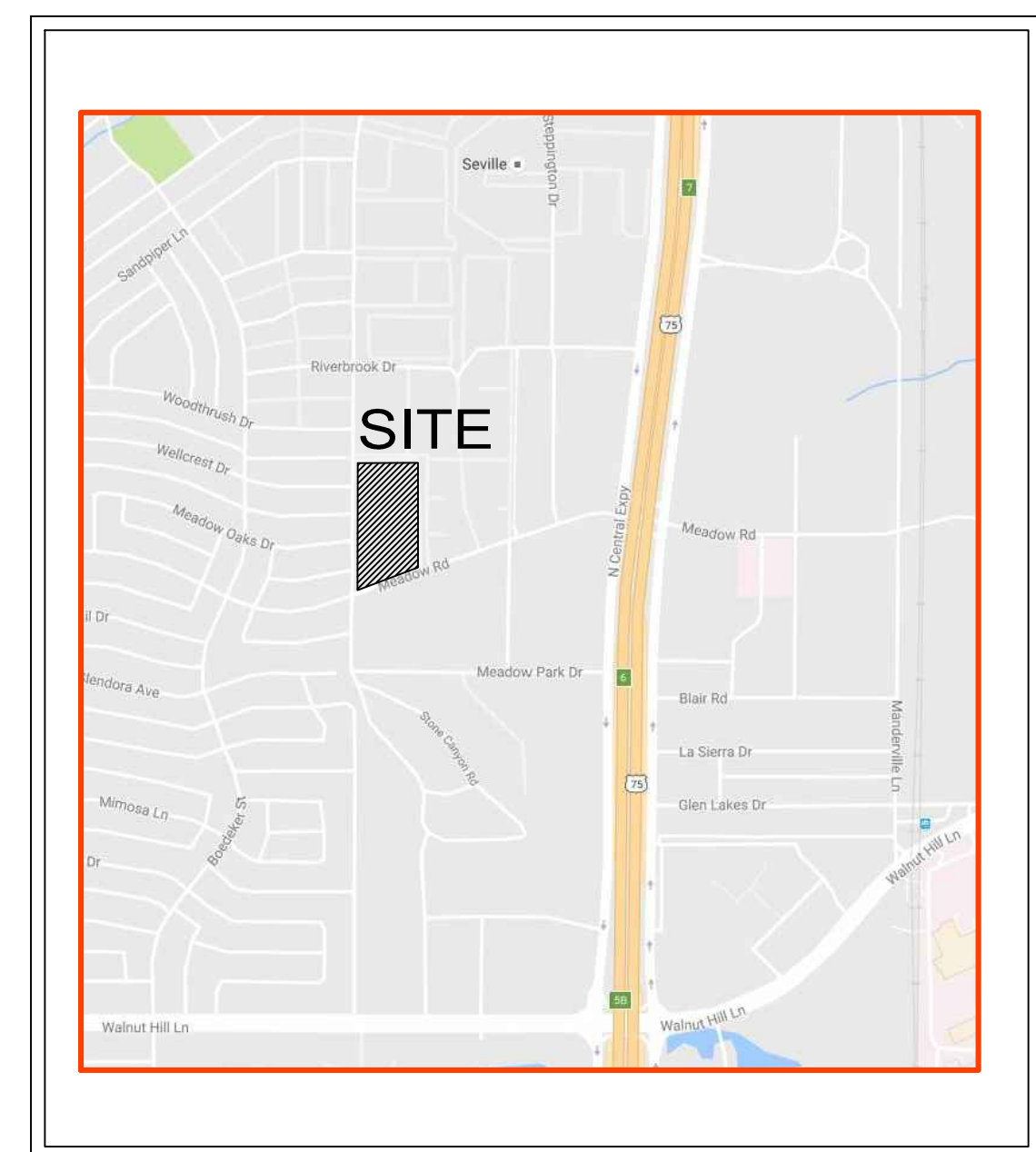
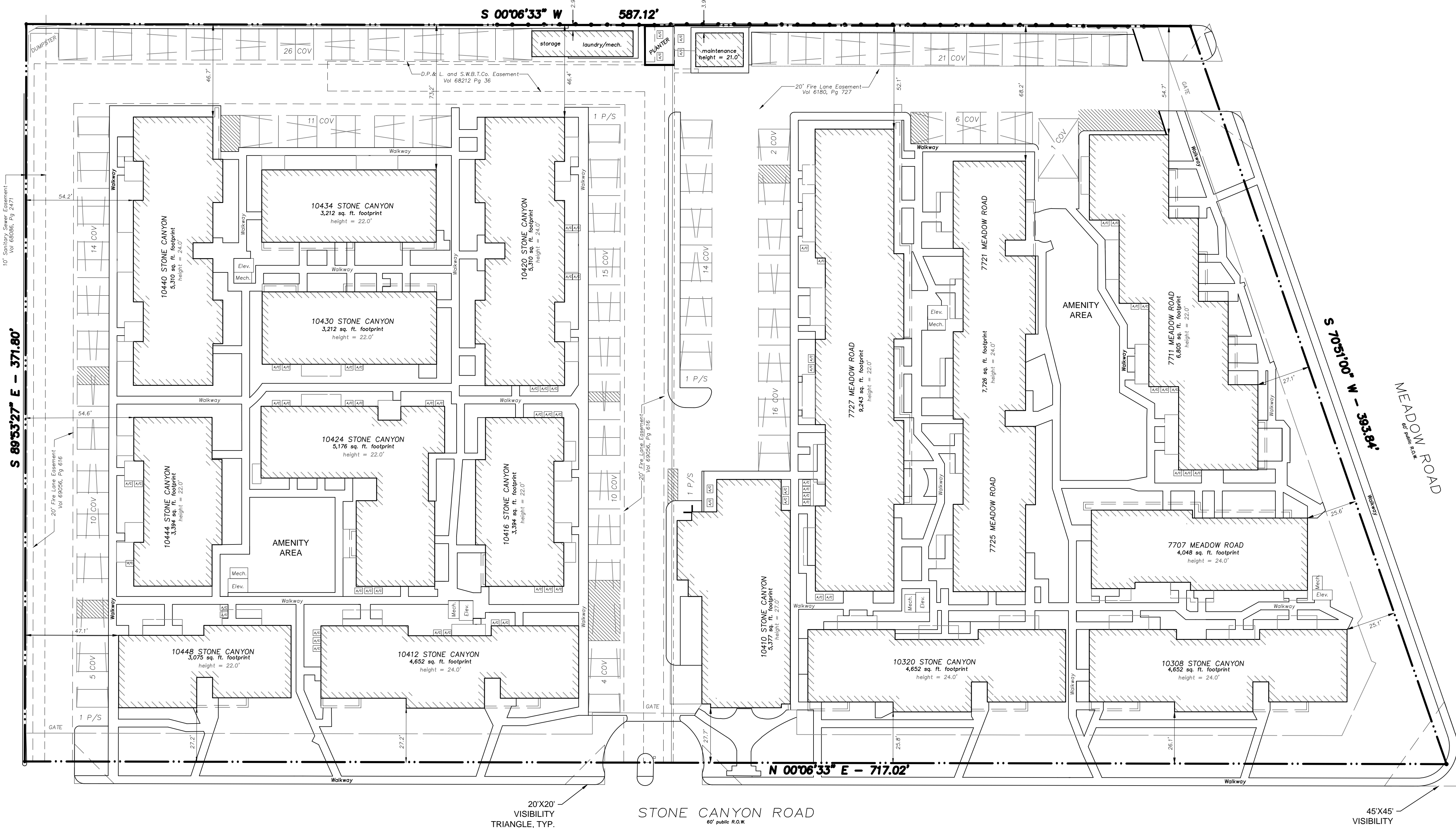

VICINITY MAP

NTS



DATE 12/01/2016
DATE REVISED 12/01/2016
CASE NUMBER

BALDWIN ASSOCIATES
3904 Elm Street, Suite B
Dallas, Texas 75226
MOBILE: 214.729.7949
OFFICE: 214.824.7949
rob@baldwinplanning.com



SITE INFORMATION:

SITE DATA TABLE

| | | |
|--------------------------------------|--------------------|---------------|
| TOTAL SITE AREA | 242,438 SF | 5.566 AC |
| LAND USE | RETIREMENT HOUSING | |
| TOTAL DENSITY | 142 UNITS | 25.5 UNITS/AC |
| | MAX. | PROVIDED |
| BUILDING HEIGHT | 36 FT | 36 FT |
| BUILDING STORIES | 3 | 2 |
| LOT COVERAGE | 50% | 50% |
| SETBACKS | | |
| | MIN. | PROVIDED |
| FRONT SETBACK | 15 FT | 25 FT |
| SIDE & REAR SETBACK | 10 FT | 10 FT |
| SIDE & REAR FOR ACCESSORY STRUCTURES | 0 | 0 |
| PARKING | | |
| PARKING RATIO 1/ UNIT | REQ. | PROVIDED |
| PARKING | 140 | 159 |
| HANDICAP PARKING | 6 | 6 |

NOTES:

1) RAISED WALKWAYS ARE NOT SHOWN ON PLANS

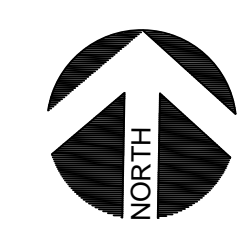

1

MEADOWSTONE PLACE PD DEVELOPMENT PLAN

SCALE: 1" = 30'-0"



10410 STONE CANYON ROAD
CITY OF DALLAS, TEXAS

CASE NUMBER: Z167-165