

PD SUBDISTRICT 18 LANDSCAPE REQUIREMENTS: PHASE V

SITE AREA:	46,251 S.F. (1.1 AC)	
SUBAREA 'A'		
	REQUIRED	PROVIDED
LANDSCAPE AREA	6,300	6,400
PARKWAY TREES (1/25 L.F.)	16	16

PD SUBDISTRICT 193 LANDSCAPE REQUIREMENTS

	REQUIRED	PROVIDED
PARKING GARAGE SCREENING		
SHRUBS	YES	YES
TREES (1/25 L.F.)	22	22

PLANTING LEGEND

SYMBOL	DESCRIPTION
	LANDSCAPE AREAS

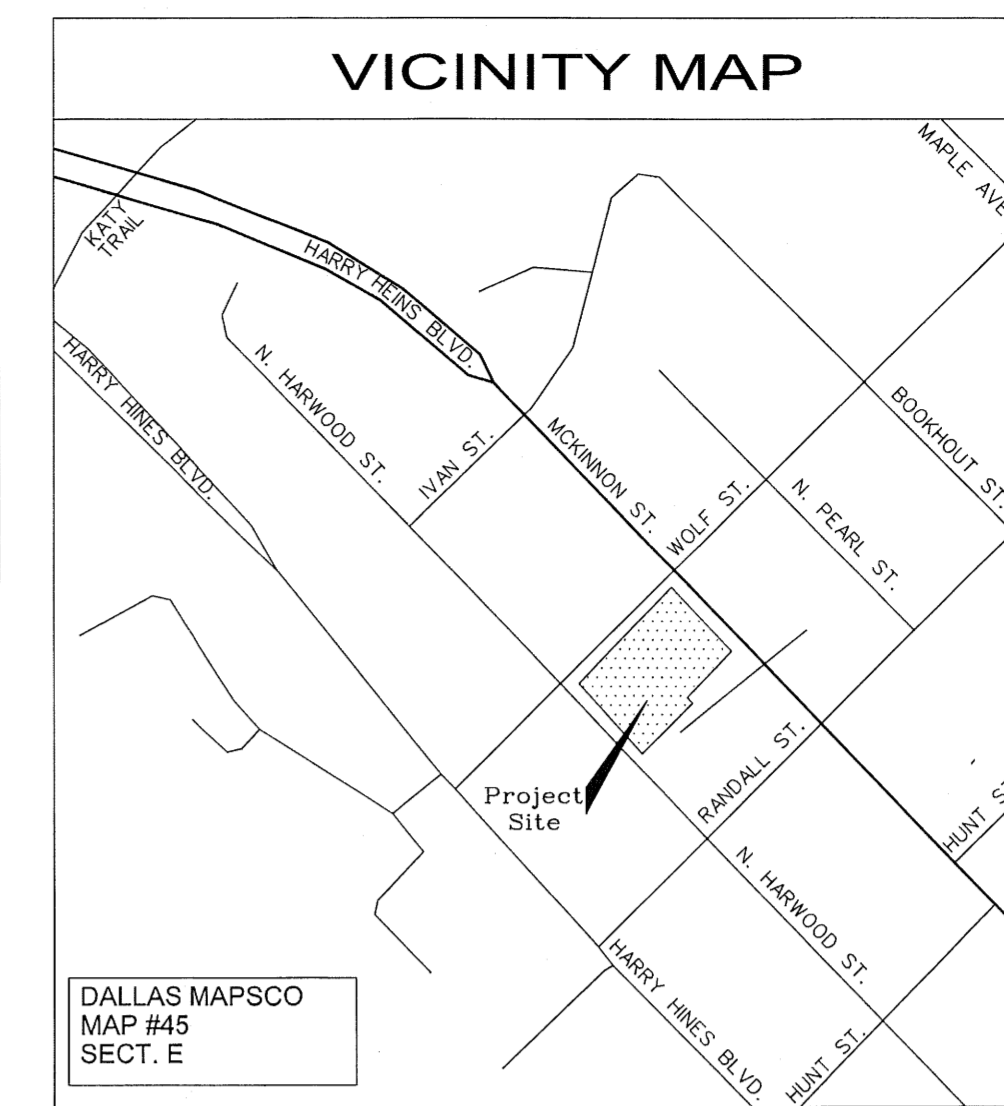

2501 N. Harwood Street  
Dallas, TX 75201  
214-871-0871

LANDSCAPE PLAN FOR  
**HARWOOD BTS  
PHASE V**  
2850 N. HARWOOD STREET  
DALLAS, TEXAS 75201

THESE DRAWINGS AND COPIES ARE THE COPYRIGHTED PROPERTY OF THE ARCHITECT. THEY MAY NOT BE USED FOR PROJECTS OTHER THAN THE DESIGNATED PROJECT WITHOUT THE SPECIFIC WRITTEN APPROVAL OF THE ARCHITECT.

REVISIONS:

PRELIMINARY ISSUES:

PROJECT ARCHITECT:  
BEN CORTEZ

ISSUE DATE:  
01-20-16

APPROVED BY:  
RW/LH

DRAWN BY:  
SMR

JOB AND SHEET NO.:

**1** LANDSCAPE PLAN  
SCALE: 1" = 20'-0"  
**Harwood BTS  
Phase V**  
Lot 6A, Block 2/930  
PD-193 - PDS-79 - Subarea A

**Planned Development  
District No. 193  
PDS No. 79 Subarea A**

DXXX-XXX

**LS1.1**