

URS

ARCHITECTURE / ENGINEERING
PLANNING
URS CORP., INC.
1950 NORTH SIMMONS FREEWAY
SUITE 6000
DALLAS, TX 75207
(214) 741-7777
(214) 741-9413 (FAX)
www.urscorp.com

MEP
BASHARQAH ENGINEERING
INCORPORATED
921 N. INDUSTRIAL BLVD
DALLAS, TX 75207
(214) 659-9000
www.beltexas.com

CIVIL
CRIADO & ASSOCIATES, INC.
4141 BLUE LAKE CIR
SUITE 155
DALLAS, TX 75244
(972) 392-9092

STRUCTURE
CHARLES GOER AND
ASSOCIATES, INC.
11615 FOREST CENTRAL DRIVE
SUITE 303
DALLAS, TX 75243
(214) 340-1189

LANDSCAPE ARCHITECT
CAYE COOK & ASSOCIATES
12700 HILLCREST ROAD,
SUITE 140
DALLAS, TX 75230
(817) 913-3799

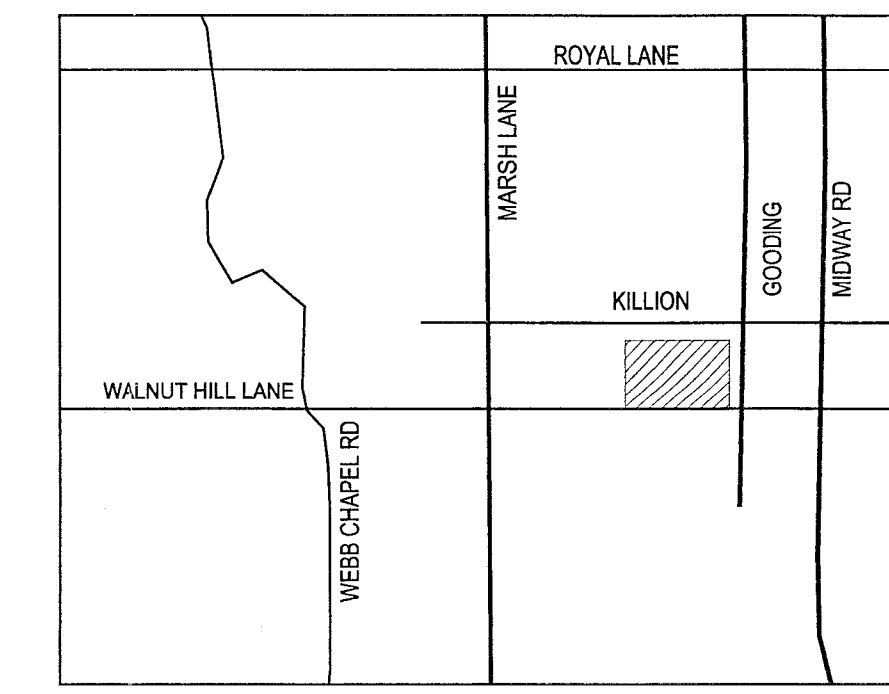

VICINITY MAP

SITE SUMMARY:	
LOT AREA:	22.74 AC.
EXISTING BUILDING AREA:	201,900 SF
EXPANSION AREA:	26,225 SF
PROPOSED CAFETERIA EXPANSION:	4,200 SF
CLASSROOMS:	83
PARKING:	562 SPACES
BUILDING HEIGHT:	55'-0" MAX.
LOT COVERAGE:	18%

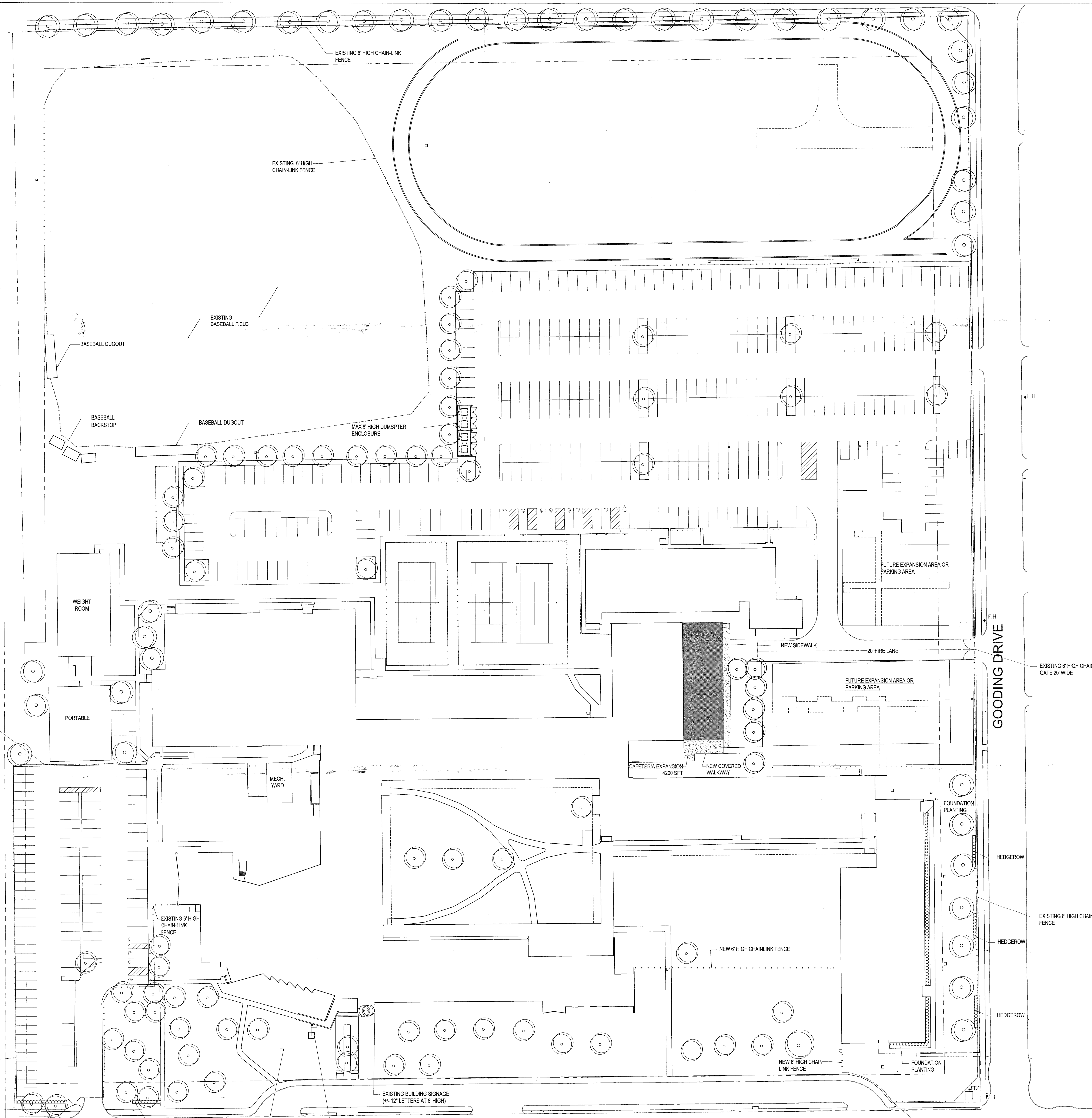

WALNUT HILL LANE

GOODING DRIVE

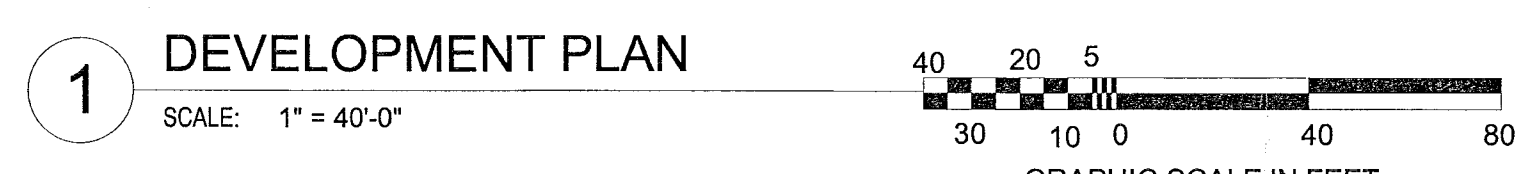

APPROVED BY CITY PLAN COMMISSION
IN ACCORDANCE WITH THE PROVISIONS OF
SECTION 51A-4.702 OF THE DALLAS DEVELOPMENT
CODE
DATE: 8/22/10
PLANNED DEVELOPMENT DISTRICT NO. 705
FILE NO. 081-274

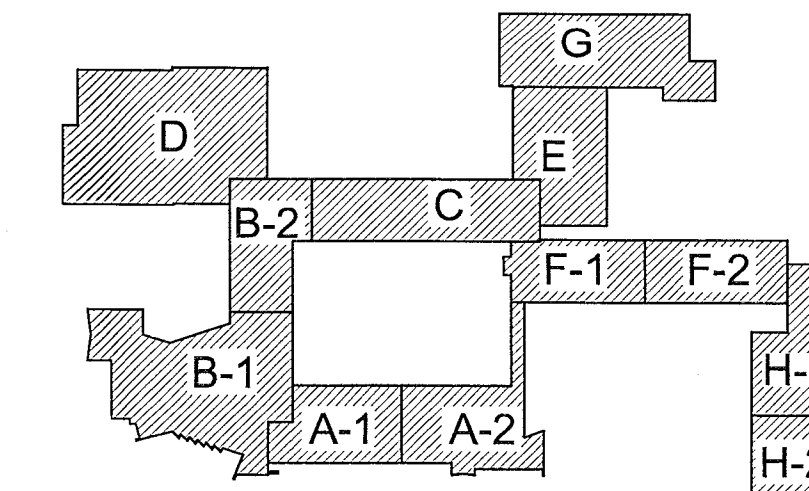

THOMAS JEFFERSON HIGH SCHOOL (007)
DALLAS INDEPENDENT
SCHOOL DISTRICT (BP030)
4001 WALNUT HILL LANE
DALLAS, TEXAS 75229

**NOT FOR
REGULATORY
APPROVAL, BIDDING
OR CONSTRUCTION**

ISSUE DATE:
PROJECT NUMBER
25338300.0002
SHEET NAME:
**DEVELOPMENT
PLAN**
SHEET NUMBER:
DP1.00

Drawing: 04.03 Project: Dallas ISD - 080101 THOMAS JEFFERSON HS 007 GOODING SITE PARKING et al. 01_2010-0-17.dwg by WJL_jsmc
 Layout: 0401.dwg Date: 8/22/10 Project: 04.03 THOMAS JEFFERSON HS 007 GOODING SITE PARKING et al. 01_2010-0-17.dwg by WJL_jsmc
 Date: 8/22/10 Project: 04.03 THOMAS JEFFERSON HS 007 GOODING SITE PARKING et al. 01_2010-0-17.dwg by WJL_jsmc