

OWNER'S DEDICATION

NOW THEREFORE, KNOW ALL MEN BY THESE PRESENTS:

That Park Cities Presbyterian Church, acting by and through its duly authorized agent, does hereby adopt this plat, designating the herein described property as **Park Cities Presbyterian Church Addition**, an addition to the City of Dallas, Dallas County, Texas, and do hereby dedicate, in fee simple, to the public use forever any streets, alleys, and floodway management areas shown thereon. The easements shown thereon are hereby reserved for the purposes indicated. The utility and fire lane easements shall be open to the public, fire and police units, garbage and rubbish collection agencies, and all public and private utilities for each particular use. The maintenance of paving on the utility and fire lane easements is the responsibility of the property owner. No buildings, fences, trees, shrubs, or other improvements or growths shall be constructed, reconstructed or placed upon, over or across the easements as shown. Said easements being hereby reserved for the mutual use and accommodation of all public utilities using or desiring to use same. All, and any public utility shall have the right to remove and keep removed all or parts of any building, fences, trees, shrubs, or other improvements or growths which in any way may endanger or interfere with the construction, maintenance or efficiency of its respective system on the easements, and all public utilities shall at all times have the full right of ingress and egress to or from the said easements for the purpose of constructing, reconstructing, inspecting, patrolling, maintaining and adding to or removing all or parts of its respective systems without the necessity at any time of procuring the permission of anyone. (Any public utility shall have the right of ingress and egress to private property for the purpose of reading meters and any maintenance or service required or ordinarily performed by that utility).

Water main and wastewater easements shall also include additional area of working space for construction and maintenance of the systems. Additional easement area is also conveyed for installation and maintenance of manholes, cleanouts, fire hydrants, water services and wastewater services from the main to the curb or pavement line, and description of such additional easements herein granted shall be determined by their location as installed.

This plat approved subject to all platting ordinances, rules, regulations, and resolutions of the City of Dallas.

Witness my hand this ____ day of _____, 2016.

By: _____
Park Cities Presbyterian Church officer

STATE OF TEXAS §
COUNTY OF DALLAS §

BEFORE ME, the undersigned, a Notary Public in and for the said County and State, on this day personally appeared _____, known to me to be the person whose name is subscribed to the foregoing instrument and acknowledged to me that he executed the same for the purpose therein expressed and under oath stated that the statements in the foregoing certificate are true.

Witness under my hand and seal this ____ day of _____, 2016.

Notary Public in and for the State of Texas

Witness my hand this ____ day of _____, 2016.

By: _____
Robert Kinsel Smith, Jr.

STATE OF TEXAS §
COUNTY OF DALLAS §

BEFORE ME, the undersigned, a Notary Public in and for the said County and State, on this day personally appeared Robert Kinsel Smith, Jr., known to me to be the person whose name is subscribed to the foregoing instrument and acknowledged to me that he executed the same for the purpose therein expressed and under oath stated that the statements in the foregoing certificate are true.

Witness under my hand and seal this ____ day of _____, 2016.

Notary Public in and for the State of Texas

Witness my hand this ____ day of _____, 2016.

By: _____
Jill Guest Smith

STATE OF TEXAS §
COUNTY OF DALLAS §

BEFORE ME, the undersigned, a Notary Public in and for the said County and State, on this day personally appeared Jill Guest Smith, known to me to be the person whose name is subscribed to the foregoing instrument and acknowledged to me that he executed the same for the purpose therein expressed and under oath stated that the statements in the foregoing certificate are true.

Witness under my hand and seal this ____ day of _____, 2016.

Notary Public in and for the State of Texas

Witness my hand this ____ day of _____, 2016.

By: _____
Gregory S. Colletti

STATE OF TEXAS §
COUNTY OF DALLAS §

BEFORE ME, the undersigned, a Notary Public in and for the said County and State, on this day personally appeared Gregory S. Colletti, known to me to be the person whose name is subscribed to the foregoing instrument and acknowledged to me that he executed the same for the purpose therein expressed and under oath stated that the statements in the foregoing certificate are true.

Witness under my hand and seal this ____ day of _____, 2016.

Notary Public in and for the State of Texas

Witness my hand this ____ day of _____, 2016.

By: _____
Rene Scherr

STATE OF TEXAS §
COUNTY OF DALLAS §

BEFORE ME, the undersigned, a Notary Public in and for the said County and State, on this day personally appeared Rene Scherr, known to me to be the person whose name is subscribed to the foregoing instrument and acknowledged to me that he executed the same for the purpose therein expressed and under oath stated that the statements in the foregoing certificate are true.

Witness under my hand and seal this ____ day of _____, 2016.

Notary Public in and for the State of Texas

Witness my hand this ____ day of _____, 2016.

By: _____
Michael Warrior

STATE OF TEXAS §
COUNTY OF DALLAS §

BEFORE ME, the undersigned, a Notary Public in and for the said County and State, on this day personally appeared Michael Warrior, known to me to be the person whose name is subscribed to the foregoing instrument and acknowledged to me that he executed the same for the purpose therein expressed and under oath stated that the statements in the foregoing certificate are true.

Witness under my hand and seal this ____ day of _____, 2016.

Notary Public in and for the State of Texas

Witness my hand this ____ day of _____, 2016.

By: _____
CMWOC Properties II, LLC officer

STATE OF TEXAS §
COUNTY OF DALLAS §

BEFORE ME, the undersigned, a Notary Public in and for the said County and State, on this day personally appeared _____, known to me to be the person whose name is subscribed to the foregoing instrument and acknowledged to me that he executed the same for the purpose therein expressed and under oath stated that the statements in the foregoing certificate are true.

Witness under my hand and seal this ____ day of _____, 2016.

Notary Public in and for the State of Texas

Witness my hand this ____ day of _____, 2016.

By: _____
Timothy E. Cronin

STATE OF TEXAS §
COUNTY OF DALLAS §

BEFORE ME, the undersigned, a Notary Public in and for the said County and State, on this day personally appeared Timothy E. Cronin, known to me to be the person whose name is subscribed to the foregoing instrument and acknowledged to me that he executed the same for the purpose therein expressed and under oath stated that the statements in the foregoing certificate are true.

Witness under my hand and seal this ____ day of _____, 2016.

Notary Public in and for the State of Texas

Witness my hand this ____ day of _____, 2016.

By: _____
Wilson K. Mason, III

STATE OF TEXAS §
COUNTY OF DALLAS §

BEFORE ME, the undersigned, a Notary Public in and for the said County and State, on this day personally appeared Wilson K. Mason, III, known to me to be the person whose name is subscribed to the foregoing instrument and acknowledged to me that he executed the same for the purpose therein expressed and under oath stated that the statements in the foregoing certificate are true.

Witness under my hand and seal this ____ day of _____, 2016.

Notary Public in and for the State of Texas

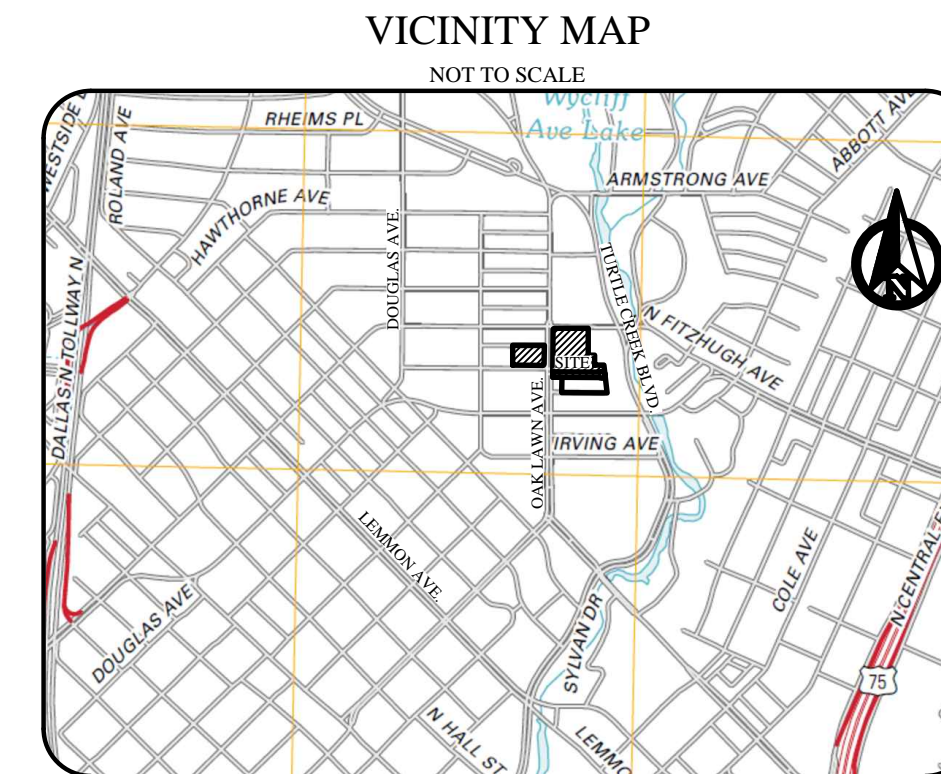

THE PURPOSE OF THIS PLAT IS TO COMBINE
LOTS 6 - 14, BLOCK 2064, TALTY'S SUBDIVISION
LOT 1A, BLOCK 3/2064, PARK CITIES PRESBYTERIAN CHURCH ADDITION
THOSE TRACTS DESCRIBED IN DEEDS TO PARK CITIES PRESBYTERIAN CHURCH
RECORDED IN VOL. 99231, PG. 2329; VOL. 2000-191, PG. 8971; VOL. 94199, PG. 1400;
VOL. 94199, PG. 1448; VOL. 94199, PG. 1452; VOL. 94199, PG. 1460; VOL. 94199, PG. 1476;
VOL. 94199, PG. 1480; VOL. 94199, PG. 1484; & VOL. 94199, PG. 1488, D.R.D.C.T.
AND NEWTON COURT INTO A SINGLE LOT.

**PRELIMINARY PLAT
PARK CITIES PRESBYTERIAN
CHURCH ADDITION
LOT 1A-1, BLOCK 2064**

BEING
LOTS 6 - 14, BLOCK 2064, TALTY'S SUBDIVISION
VOLUME 2, PAGE 388, D.R.D.C.T.
LOT 1A, BLOCK 3/2064
PARK CITIES PRESBYTERIAN CHURCH ADDITION
VOLUME 95123, PAGE 1447, D.R.D.C.T.
NEWTON COURT
VOLUME 2, PAGE 388, D.R.D.C.T.
TRACTS TO PARK CITIES PRESBYTERIAN CHURCH
RECORDED IN VOL. 99231, PG. 2329; VOL. 2000-191, PG. 8971; VOL. 94199, PG. 1400;
VOL. 94199, PG. 1448; VOL. 94199, PG. 1452; VOL. 94199, PG. 1460; VOL. 94199, PG. 1476;
VOL. 94199, PG. 1480; VOL. 94199, PG. 1484; & VOL. 94199, PG. 1488, D.R.D.C.T.

SITUATED IN THE
WILLIAM GRIGSBY SURVEY, ABSTRACT NO. 501
5.205 ACRES
CITY OF DALLAS, DALLAS COUNTY, TEXAS - CITY PLAN FILE NO. S156-148
PAGE TWO OF TWO

Drafter: JDJ - 2016/03/21
Drafter/Revision:
Drafter/Revision:
Drafter/Revision:
Drafter/Revision:
Drafter/Revision:
Drafter/Revision:

Date of Preparation & Revisions
March 21, 2016 preliminary planning drawing



JPH Job No.
2013.031.006 Park Cities Presbyterian - PRELIM PLAT.dwg
© 2016 JPH Land Surveying, Inc. - All Rights Reserved
807 Bluebonnet Drive, Suite C Keller, Texas 76248
Telephone (817) 431-4971 www.jpHLandsurveying.com
TBPLS Firm #10019500 #10194073 #10193867
DFW | Austin | Abilene

Existing Owner
Park Cities Presbyterian Church
4124 Oak Lawn Avenue
Dallas, TX 75219
Jeff Barber
Executive Director
jeff.barber@pcpc.org

Surveyor
JPH Land Surveying, Inc.
Jewel Chadd, R.P.L.S.
Dallas, TX 75219
807 Bluebonnet Drive, Suite C
Keller, Texas 76248
jewel@jphs.com

Engineer
Walter P. Moore & Associates, Inc.
Shana L. Heffler, P.E.
1845 Woodall Rodgers Freeway, Suite 1650
Dallas, Texas 75201
sheffler@walterpmoore.com