

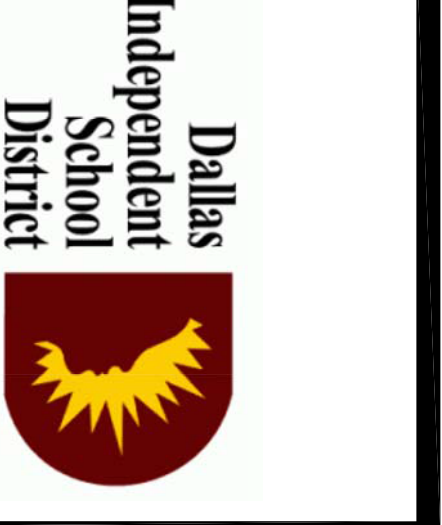

JACOBS & ASSOCIATES
 Architecture Planning Interiors
 701 Canyon Drive, Suite 110
 Coppell, TX 75019
 T. 972.331.5699



Dallas ISD
 Bid Package 405
STONEMALL JACKSON ES
 O.R.G. NO. 162

PROJECT ADDRESS:
STONEMALL JACKSON ES
 5828 MOCKINGBIRD LN.
 DALLAS, TEXAS 75226

DEVELOPMENT PLAN

JOB NO.	19036	
DATE	ISSUE FOR	DRAWN BY
12/01/15	BECK/JP	

SHEET NO.
SP2
 OF

Z156-198

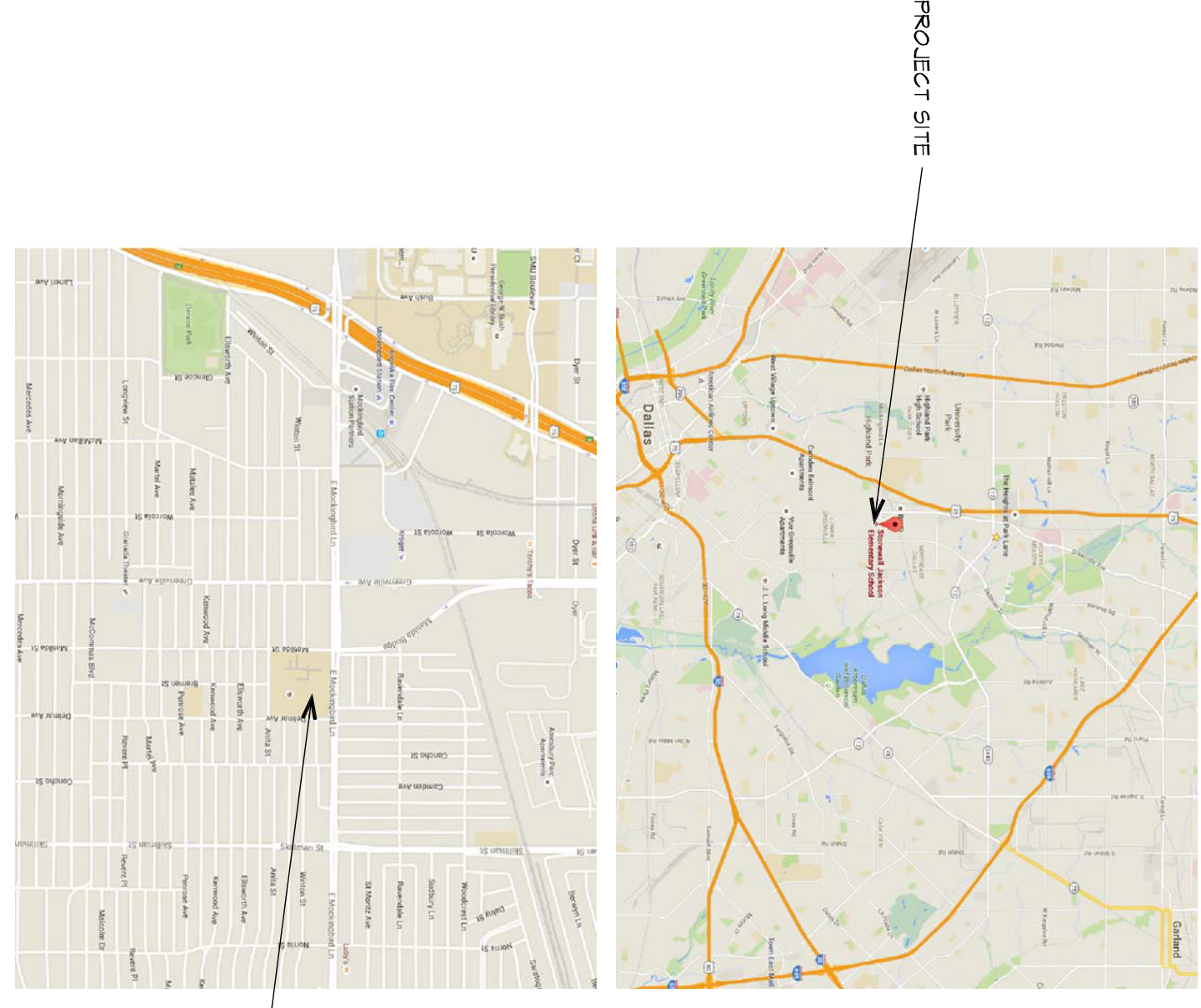

VICINITY MAPS

USE: PUBLIC SCHOOL, OTHER THAN OPEN ENROLLMENT CHARTER SCHOOL	
LAND AREA:	8.722 ACRES
EXISTING FLOOR AREA:	47,480 SQ. FT.
PROPOSED FLOOR AREA:	19,040 SQ. FT.
EXISTING PORABLES REMAINING FLOOR AREA:	11,535 SQ. FT.
TOTAL FLOOR AREA:	78,055 SQ. FT.
LOT COVERAGE:	17%
LOT COVERAGE W/EXPANSION AREA:	28%
PROPOSED BUILDING HEIGHT:	31'
EXISTING CLASSROOMS:	23
NEW CLASSROOMS:	11
EXISTING PORTABLES:	12
TOTAL CLASSROOMS:	46
REQUIRED PARKING SPACES:	69
EXISTING PARKING SPACES :	88

DATA

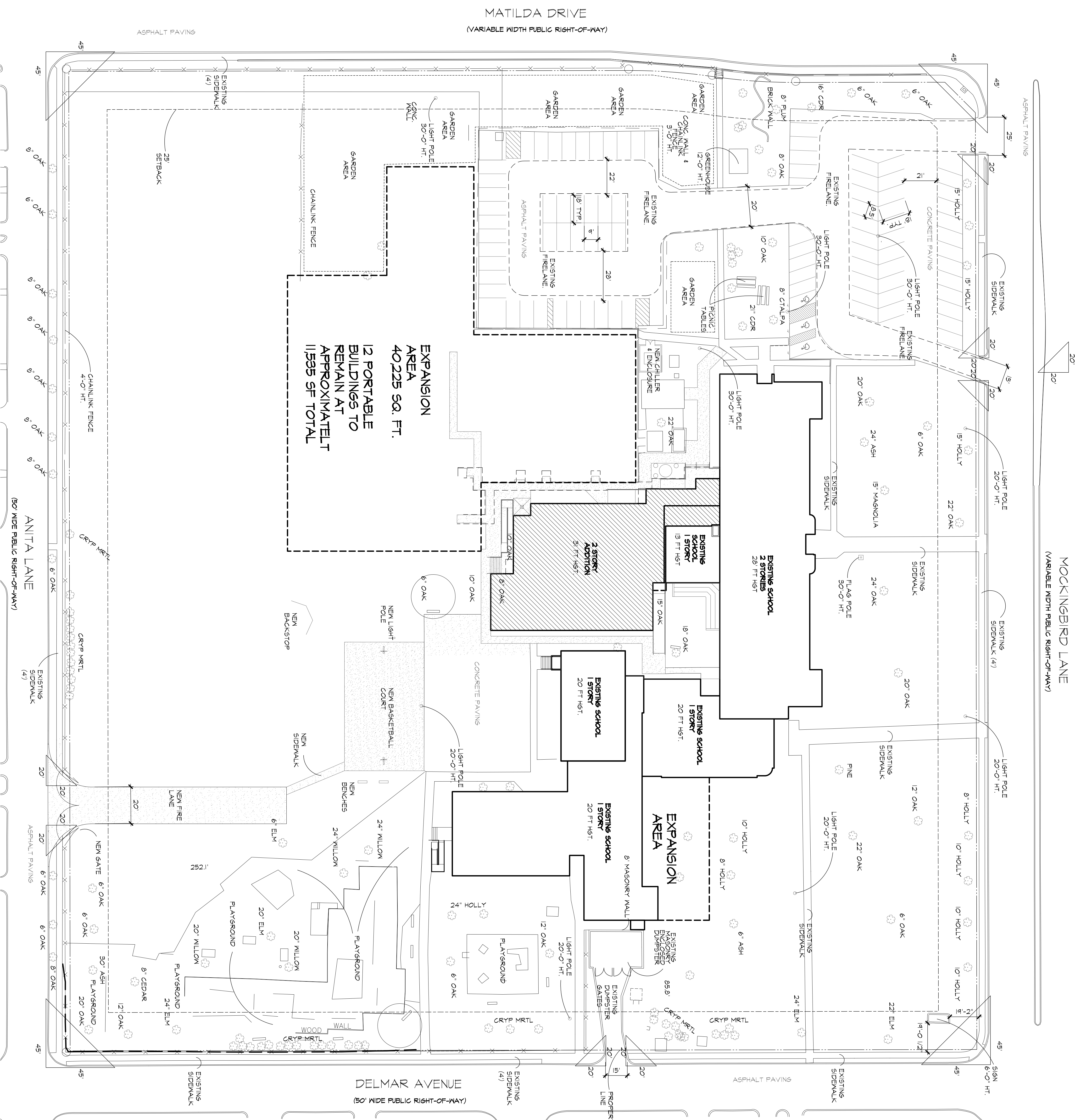

DEVELOPMENT PLAN
 SCALE 1"=30'-0"
 SCALE 1"=30'-0"