

VICINITY MAP

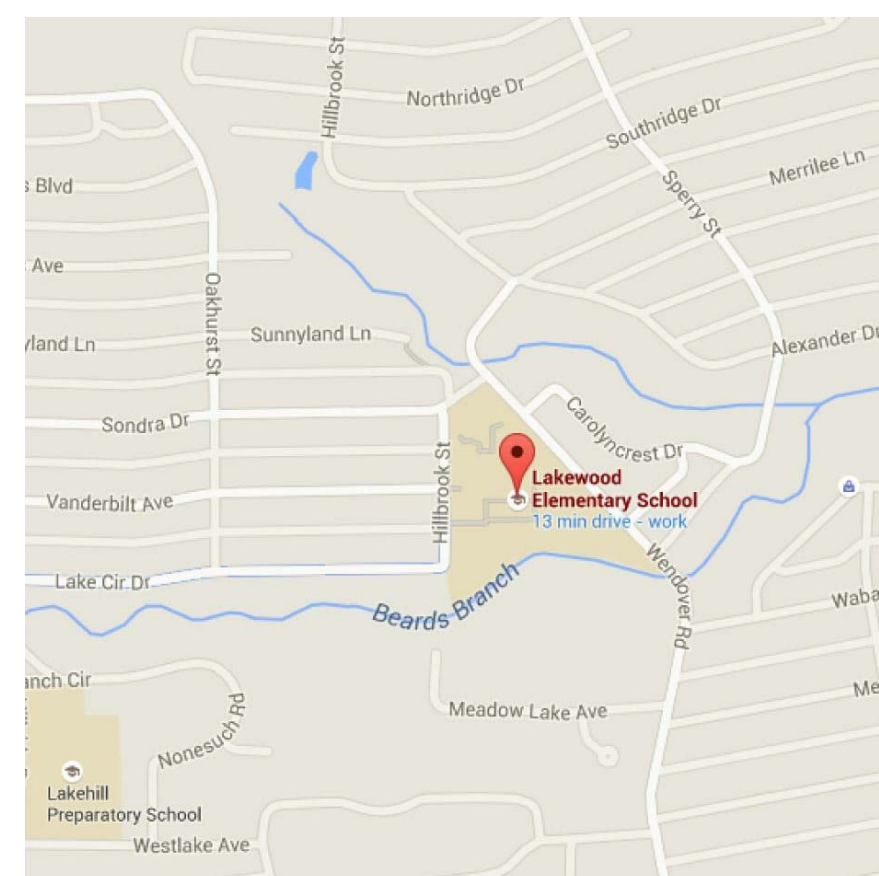

BUILDING INFORMATION

USE/OCCUPANCY: E	SITE AREA: 7.897 ACRES = 343,993 SF		
	EXISTING:	NEW ADDITION	TOTAL
	+ MODULARS	+ CLASSROOM RENOVATIONS	
	+ PORTABLES	+ CAFETERIA EXPANSION	
HEIGHT:	31'-6"	34'-6"	34'-6"
STORIES:	2	2	2
FLOOR AREA:	45,876 SF = MAIN BLDG. 11,383 SF = MODULARS 11,095 SF = PORTABLES 70,353 SF	52,480 SF = NEW ADDITION 5,349 SF = CLASSROOM RENOV. 2,203 SF = CAFE. EXP. 60,032 SF	45,876 SF = MAIN BLDG. 52,480 SF = NEW ADDITION 2,203 SF = CAFE. EXP. 100,559 SF
CORE CLASSROOMS:	21 = MAIN BLDG. 13 = MODULARS 14 = PORTABLES 48	26 = NEW ADDITION 5 = CLASSROOM RENOV. 31	26 = NEW ADDITION 21 = MAIN BLDG. 47
LOT COVERAGE:	9.64% = MAIN BLDG. 6.52% = MODULARS & PORTABLES 16.16%	7.64% = NEW ADDITION 0.61% = CAFE. EXPANSION 8.25%	17.89%
OFF-STREET PARKING:	59 SPACES	65 NEW SPACES	65 TOTAL SPACES

* AFTER CONSTRUCTION IS COMPLETE, TEMPORARY PORTABLES WILL BE REMOVED FROM THE BLACKTOP AREA AND NO PORTABLES OR MODULARS WILL EXIST ON-SITE.

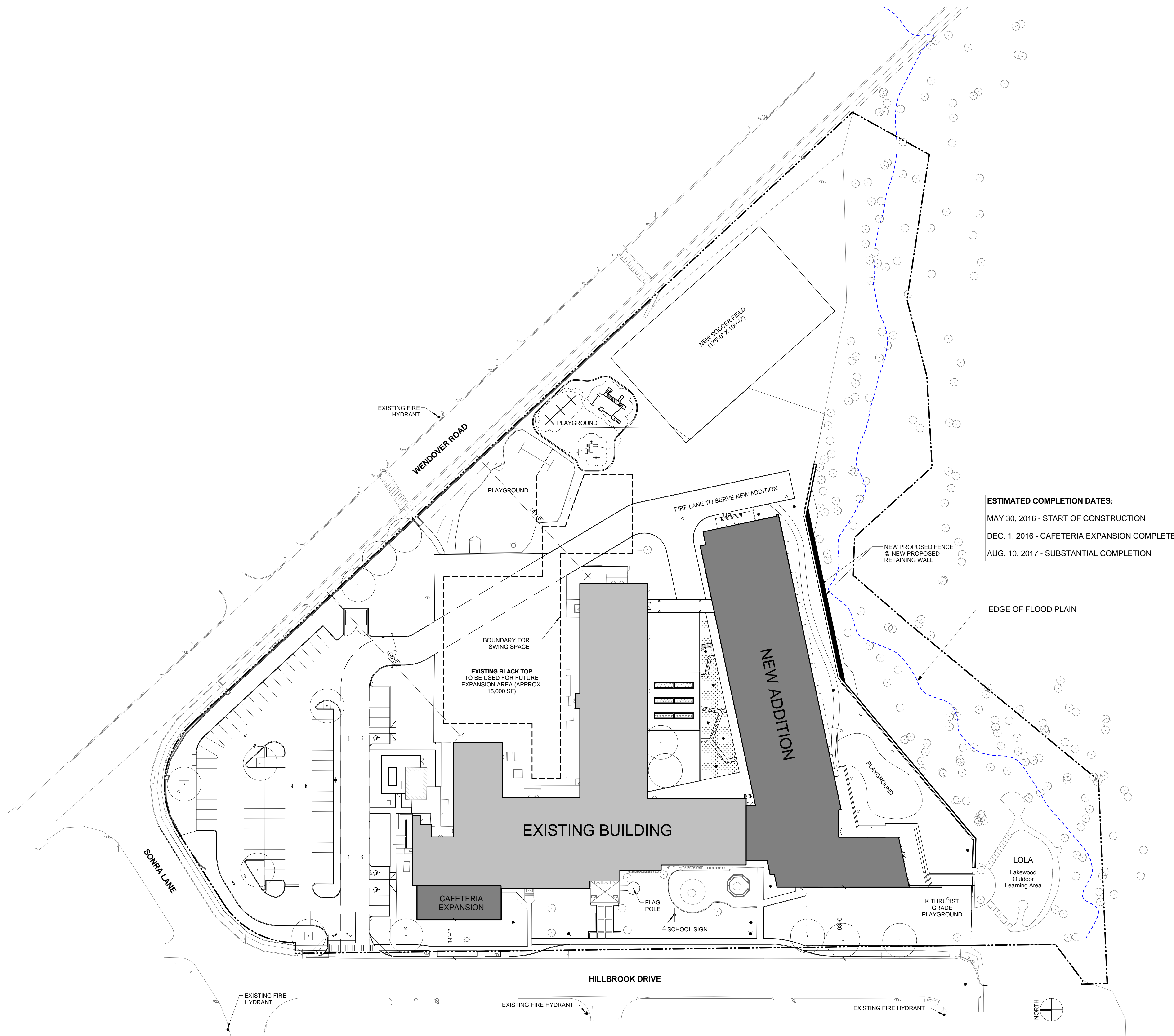

ESTIMATED COMPLETION DATES:
 MAY 30, 2016 - START OF CONSTRUCTION
 DEC. 1, 2016 - CAFETERIA EXPANSION COMPLETE
 AUG. 10, 2017 - SUBSTANTIAL COMPLETION

1 DEVELOPMENT PLAN
1" = 40'-0"



1506 w. griffin street
dallas, texas 75215
214.522.1100 T
www.thaarch.com



PROGRAM MANAGER
JACOBS

Lakewood Elementary (ORG 171)
 3000 Hillbrook Street, Dallas, Texas 75214

Issue description:
ISSUE FOR BID

Issue date:
02/26/16

Drawn by: Author
checked by: Checker

revision schedule

date	description



02/26/16

project number: 2015-013

DEVELOPMENT PLAN

DP.01