

VICINITY MAP

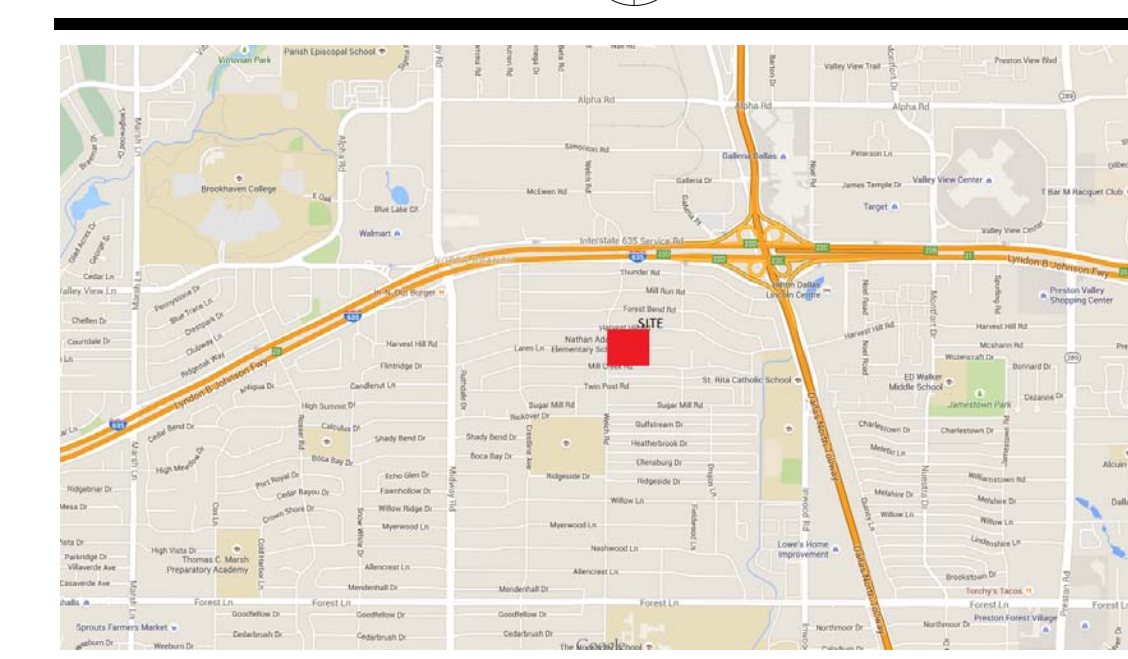

SHEET NOTES

USE/OCCUPANCY: E  
SITE AREA: 9.306 ACRES

	EXISTING:	NEW ADDITION:
HEIGHT:	25'-0" WITHOUT CHIMNEY 35'-0" WITH CHIMNEY	28'
STORIES:	1	1
FLOOR AREA:	49,566 SF	19,000 SF
CLASSROOMS:	25	12
LOT COVERAGE:	13%	5%
OFF-STREET PARKING:	56 EXISTING SPACES	23 NEW SPACES

1 DEVELOPMENT PLAN  
1" = 30'-0"

Nathan Adams Elementary (233) Addition and Renovations  
12600 Welch Rd, Dallas, TX 75244

Issue description:  
**ISSUE FOR CONSTRUCTION**  
Issue date:  
03/16/2016  
Drawn by: CSH  
Checked by: LJ  
Revision schedule

date	description



Z156.199  
project number: 15-045  
DEVELOPMENT PLAN

DP.01

THIS DOCUMENT IS AN INSTRUMENT OF SERVICE FOR USE SOLELY WITH RESPECT TO THIS PROJECT. L. Howard + associates, inc. SHALL RETAIN ALL COMMON LAW STATUTORY AND OTHER RESERVED RIGHTS, INCLUDING THE COPYRIGHT. THE CLIENT SHALL NOT REUSE, TRANSFER, OR SELL OR PERMIT THE REUSE, TRANSFER, OR SELL OR PERMIT THE REUSE, TRANSFER, OR SELL OF L. Howard + associates, inc. DOCUMENTS EXCEPT BY MUTUAL AGREEMENT IN WRITING.