

06/06/2016
PROJECT NUMBER
CASE NUMBER

BALDWIN ASSOCIATES
3904 Elm Street, Suite B
Dallas, Texas 75226
MOBILE: 214.729.7949
OFFICE: 214.824.7949
rob@baldwinplanning.com

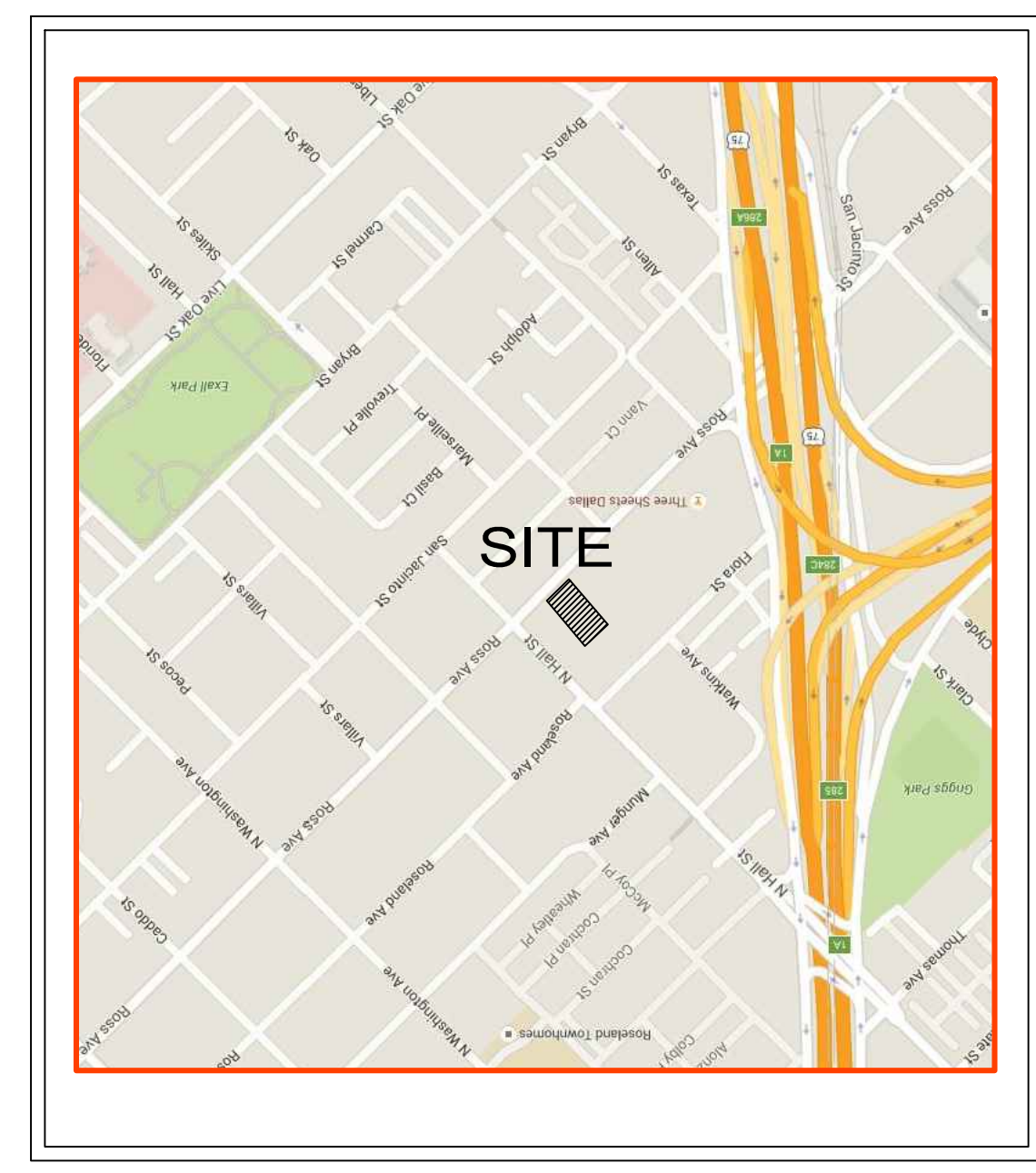

3310 - 3312 ROSS
CITY OF DALLAS, TEXAS



VICINITY MAP

NTS

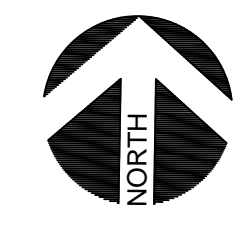

SITE INFORMATION

ZONING DISTRICT: PD 298
SUBAREA 1
USE: RETAIL - LIQUOR STORE
SUITE A FLOOR AREA: 2,300 SF
PARKING REQUIRED:
1/200SF = 12 P/S

CASE NUMBER: Z156-242

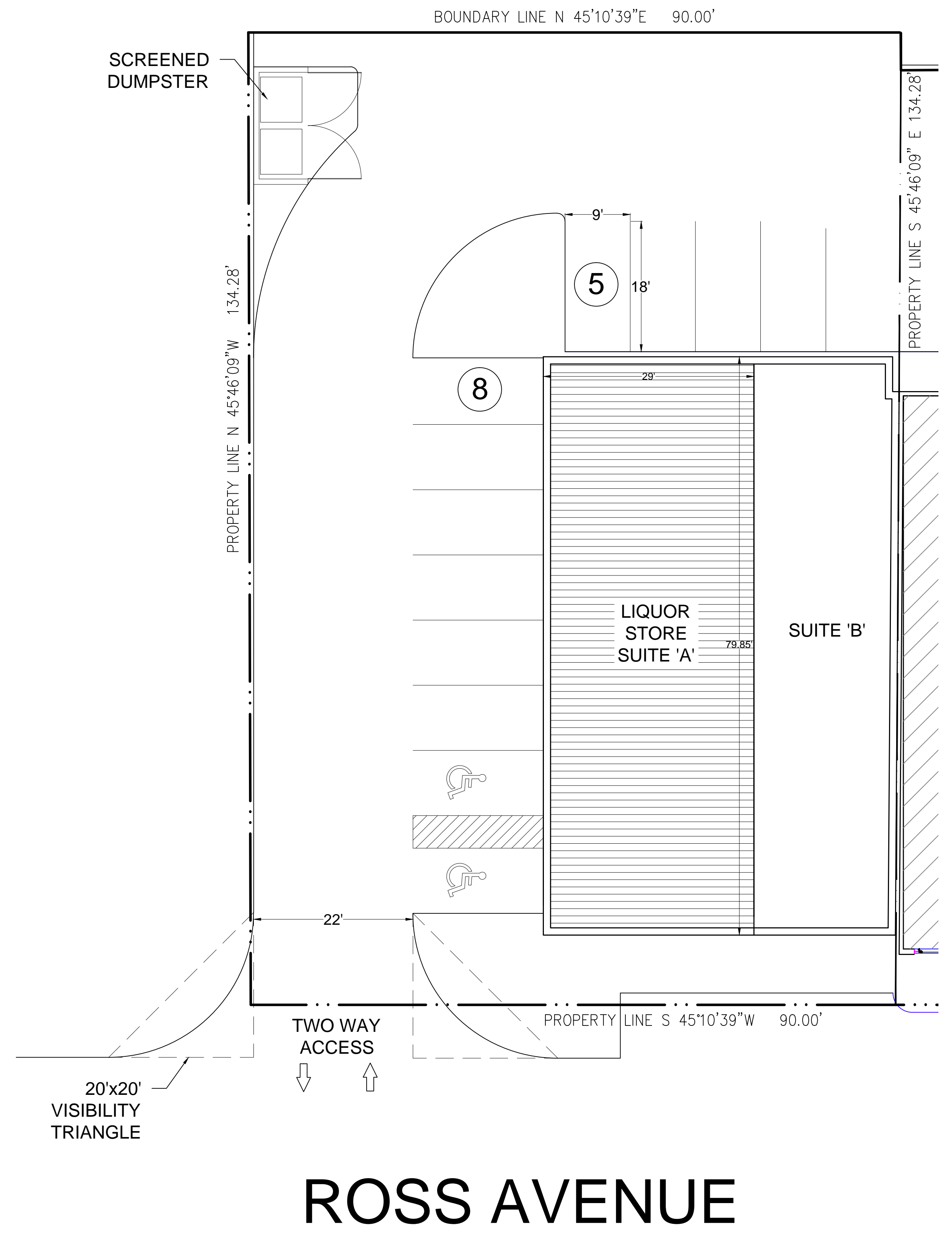

1 SUP SITE PLAN
SCALE: 1" = 10'-0"

