

LEGEND

- EXISTING CONTOURS
- PROPERTY LINE
- 100-YEAR FLOODPLAIN EASEMENT
- EXISTING STRUCTURE
- EXISTING STRUCTURE
- NEW CONSTRUCTION (PLANNED)
- FUTURE EXPANSION (PREVIOUSLY APPROVED)
- PROPOSED FUTURE EXPANSION (PREVIOUSLY APPROVED)
- PROPOSED LANDSCAPE AREA

- NOTES:**
1. THIS 25,000 SF BUILDING WAS CONSTRUCTED PRIOR TO 1984. SINCE THIS BUILDING IS PLANNED FOR REMOVAL AT THE TIME WHEN THE PROPOSED TRANSFER STATION IS TO BE CONSTRUCTED, IT WAS NOT INCLUDED IN THE PRIOR PLANS FOR THE SPECIFIC USE PERMIT.
 2. EXISTING ENTRANCES HAVE BEEN IMPROVED SINCE ISSUANCE OF SUP IN 2002.
 3. THE INTERIOR PROPERTY LINE ILLUSTRATES THE EXISTING PROPERTY DIVISION BETWEEN 1990 CALIFORNIA CROSSING AND 2010 CALIFORNIA CROSSING.
 4. DRAINAGE AND FLOODPLAIN EASEMENTS, ALONG WITH THE EXISTING PROPERTY LINES WERE TAKEN FROM EXISTING PLATS ON FILE WITH THE CITY OF DALLAS.
 5. FLOODPLAIN DELINEATION IS BASED ON FLOODPLAIN INSURANCE RATE MAP, DATED NOVEMBER 1999, OBTAINED FROM CITY OF DALLAS FLOODPLAIN ADMINISTRATOR'S OFFICE ON MAY 11, 2001.
 6. EXISTING CONTOURS WERE TAKEN FROM AN AERIAL SURVEYS PERFORMED BY METROPOLITAN AERIAL SURVEYS ON APRIL 27, 2001.

4.12.2018, 11:16 AM
 C:\WORK\ESTABLISHMENT\18 - Code Drawings for Reproachment Buildings - DWG\1801.PLR

PREPARER
 SCS ENGINEERS
 1901 CENTRAL DRIVE, SUITE 550
 BEDFORD, TEXAS 76021
 (817) 571-2288
 CONTACT: KEVIN YARD, P.E.

**APPLICANT/
 OWNER/DEVELOPER**
 COMMUNITY WASTE DISPOSAL, LP
 2010 CALIFORNIA CROSSING
 DALLAS, TEXAS 75220
 (972) 392-3900
 CONTACT: GREG A. ROEMER

REV	DATE	DESCRIPTION	DWN BY	DES BY	CHK BY	APP BY
03/2018			JLJ	KDY	KDY	KDY

SCS ENGINEERS
 STEARNS, CONRAD AND SCHMIDT
 CONSULTING ENGINEERS
 1901 CENTRAL DRIVE, SUITE 550, BEDFORD, TX 76021
 PH (817) 571-2288 FAX NO. (817) 571-2188

FOR PERMITTING PURPOSES ONLY

COMMUNITY WASTE DISPOSAL
 DALLAS, TEXAS
 2010 CALIFORNIA CROSSING
 TRANSFER STATION AND MRF ADDITION
 SITE PLAN

DRAWING NO.
1
 16218013.00 T3

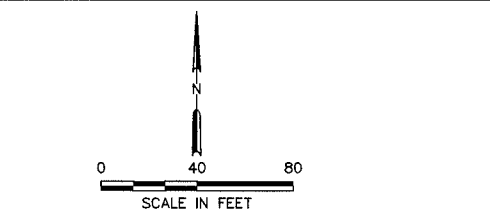
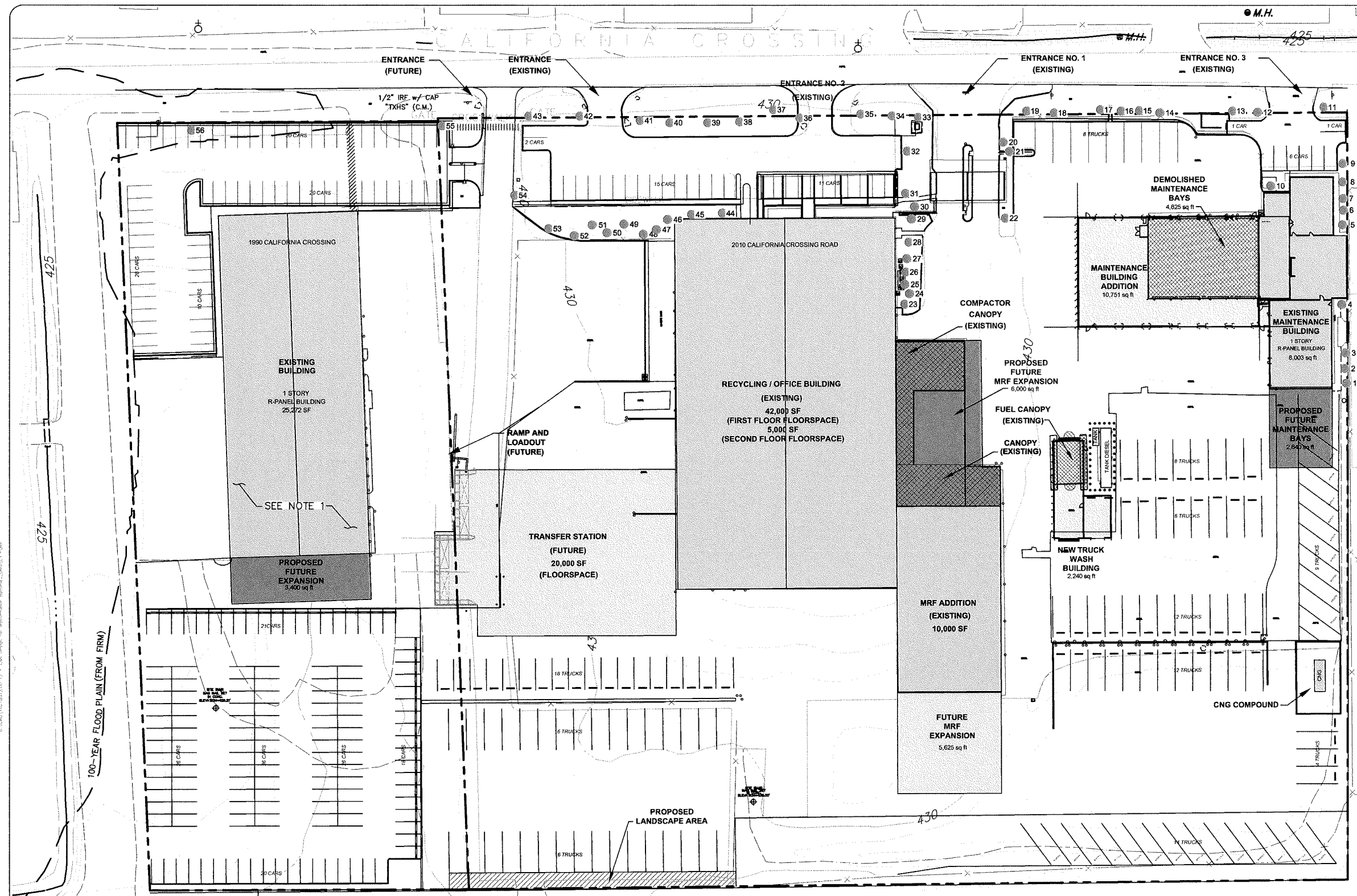

LEGEND

- 11 EXISTING TREES
- 430 EXISTING CONTOURS
- PROPERTY LINE
- - - 100-YEAR FLOODPLAIN EASEMENT
- [Hatched Box] EXISTING STRUCTURE
- [Cross-hatched Box] EXISTING STRUCTURE
- [White Box] NEW CONSTRUCTION (PLANNED)
- [Light Gray Box] FUTURE EXPANSION (PREVIOUSLY APPROVED)
- [Dark Gray Box] PROPOSED FUTURE EXPANSION
- [Diagonal Lines Box] PROPOSED LANDSCAPE AREA

TREE SURVEY CHART

Point Table			Point Table (Cont.)		
Point #	Raw Description	DIA. (IN.) 2018	Point #	Raw Description	DIA. (IN.) 2018
1	Bald Cypress	12	29	Cedar Elm	7
2	Bald Cypress	10	30	Cedar Elm	6
3	Bald Cypress	10	31	Red Oak	17
4	Live Oak	16	32	Red Oak	18
5	Eastern Red Cedar	9	33	Live Oak	15
6	Eastern Red Cedar	10	34	Live Oak	13
7	Eastern Red Cedar	10	35	Live Oak	15
8	Eastern Red Cedar	8	36	Live Oak	15
9	Eastern Red Cedar	7	37	Post Oak	32
10	Crepe Myrtle	8	38	Live Oak	16
11	Live Oak	15	39	Live Oak	12
12	Live Oak	9	40	Live Oak	16
13	Live Oak	10	41	Live Oak	16
14	Live Oak	9	42	Live Oak	15
15	Live Oak	10	43	Live Oak	16
16	Live Oak	11	44	Live Oak	10
17	Live Oak	10	45	Live Oak	10
18	Live Oak	10	46	Eastern Red Cedar	8
19	Live Oak	10	47	Eastern Red Cedar	8
20	Cedar Elm	5	48	Eastern Red Cedar	8
21	Sugarberry	6	49	Eastern Red Cedar	8
22	Chinese Pistache	10	50	Eastern Red Cedar	8
23	Cedar Elm	12	51	Eastern Red Cedar	6
24	Cedar Elm	7	52	Eastern Red Cedar	9
25	Cedar Elm	9	53	Eastern Red Cedar	12
26	Cedar Elm	10	54	Bur Oak	32
27	Cedar Elm	9	55	Cedar Elm	12
28	Cedar Elm	11	56	American Elm	12
Summary		645			

- NOTES:**
- CONTAINER STORAGE BUILDING HAS BEEN CREATED FROM THE EXISTING BUILDING LOCATED AT 1990 CALIFORNIA CROSSING.
 - EXISTING ENTRANCES WILL BE IMPROVED.
 - THE INTERIOR PROPERTY LINE ILLUSTRATES THE EXISTING PROPERTY DIVISION BETWEEN 1990 CALIFORNIA CROSSING AND 2010 CALIFORNIA CROSSING.
 - DRAINAGE AND FLOODPLAIN EASEMENTS, ALONG WITH THE EXISTING PROPERTY LINES WERE TAKEN FROM EXISTING PLATS ON FILE WITH THE CITY OF DALLAS.
 - FLOODPLAIN DELINEATION IS BASED ON FLOODPLAIN INSURANCE RATE MAP, DATED NOVEMBER 1999, OBTAINED FROM CITY OF DALLAS FLOODPLAIN ADMINISTRATOR'S OFFICE ON MAY 11, 2001.
 - EXISTING CONTOURS WERE TAKEN FROM AN AERIAL SURVEYS PERFORMED BY METROPOLITAN AERIAL SURVEYS ON APRIL 27, 2001.

PREPARER
 SCS ENGINEERS
 1901 CENTRAL DRIVE, SUITE 550
 BEDFORD, TEXAS 76021
 (817) 571-2288
 CONTACT: KEVIN YARD, P.E.

APPLICANT/ OWNER/DEVELOPER
 COMMUNITY WASTE DISPOSAL, LP
 2010 CALIFORNIA CROSSING
 DALLAS, TEXAS 75220
 (972) 392-3900
 CONTACT: GREG A. ROEMER

REV	DATE	DESCRIPTION	DWN BY	DES BY	CHK BY	APP BY

DATE OF ISSUE: 03/2018
 DWN BY: JJJ
 DES BY: KDY
 CHK BY: KDY
 APP BY: KDY

SCS ENGINEERS
 STEARNS, CONRAD AND SCHMIDT
 CONSULTING ENGINEERS
 1901 CENTRAL DRIVE, SUITE 550, BEDFORD, TX 76021
 PH (817) 571-2288 FAX NO. (817) 571-2188

FOR PERMITTING PURPOSES ONLY

COMMUNITY WASTE DISPOSAL
 DALLAS, TEXAS
 2010 CALIFORNIA CROSSING
 TRANSFER STATION AND MRF ADDITION
 LANDSCAPE PLAN

DRAWING NO.
2
 16218013.00 T3