

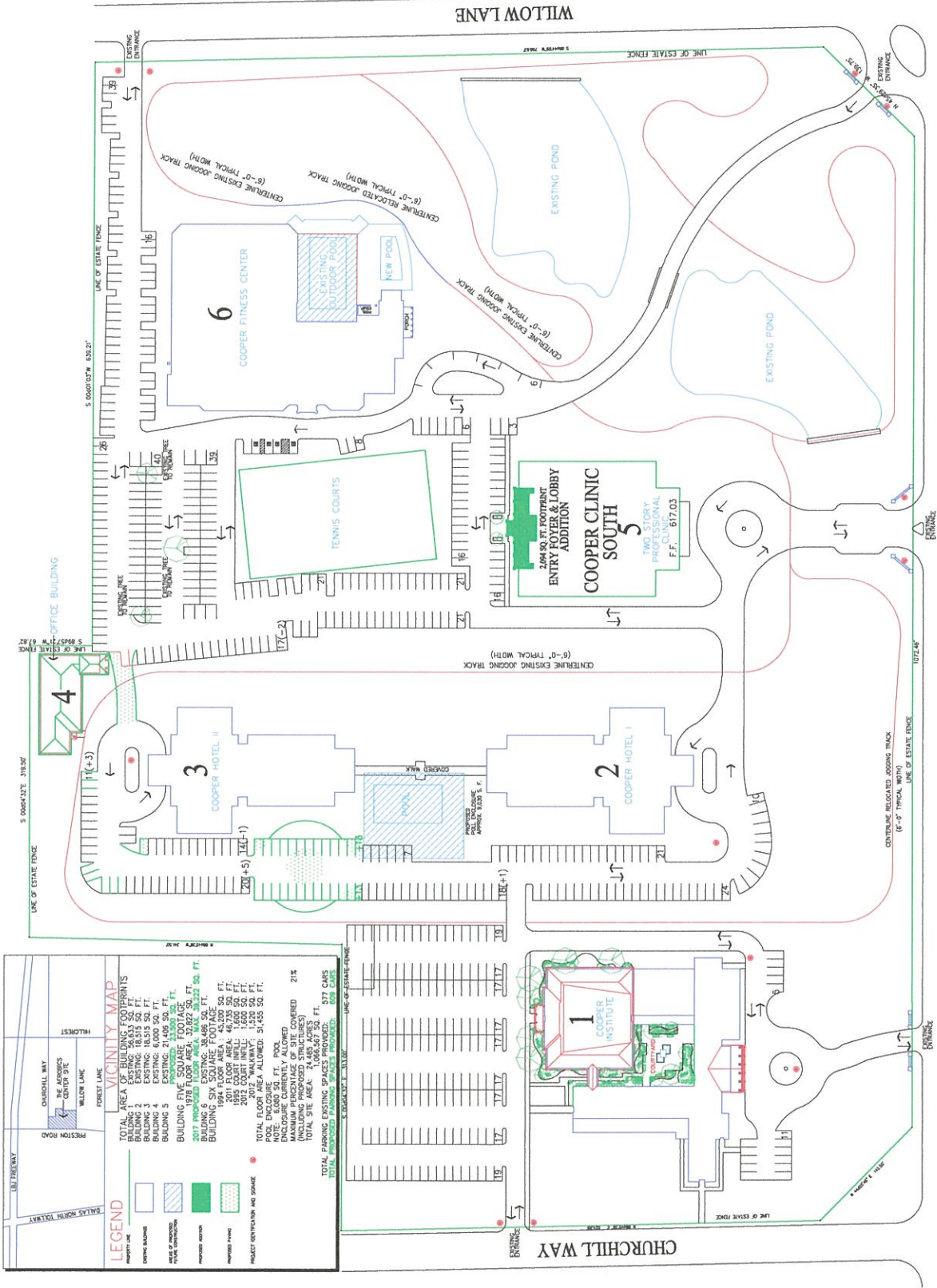

HUDSON LOCKETT III, ARCHITECT
 616 NORTH CENTRAL EXPRESSWAY, SUITE ONE TEN
 DALLAS, TEXAS 75206-5101
 214-559-2095 hudson@hudsonlockett.com

PROPOSED AMENDED SITE PLAN FOR
THE AEROBICS CENTER
 12100, 12200, 12230, 12300 PRESTON ROAD
 DALLAS, TEXAS

MP-1



PRESTON ROAD
 (100'-0" R.O.W.)

PROPOSED SITE PLAN

1" = 50'-0"

LEGEND

- PROPERTY LINE
- EXISTING BUILDING
- NEW BUILDING
- AREA OF IMPROVED FUTURE DEVELOPMENT
- IMPROVED DRIVEWAY
- IMPROVED DRIVEWAY AND DRIVEWAY
- IMPROVED DRIVEWAY AND DRIVEWAY

VICINITY MAP

TOTAL AREA EXISTING COMMENTS

BUILDING 1: EXISTING 30,633 SQ. FT.
 BUILDING 2: EXISTING 18,319 SQ. FT.
 BUILDING 3: EXISTING 6,000 SQ. FT.
 BUILDING 4: EXISTING 2,140 SQ. FT.
 BUILDING 5: EXISTING 1,400 SQ. FT.
 BUILDING 6: EXISTING 38,486 SQ. FT.

BUILDING FIVE SQUARE FOOTAGE

2017 PROPOSED FLOOR AREA: 39,222 SQ. FT.
 2011 FLOOR AREA: 46,735 SQ. FT.
 1994 FLOOR AREA: 10,420 SQ. FT.
 2012 COURT INLET: 1,600 SQ. FT.
 2012 COURT INLET: 1,600 SQ. FT.

TOTAL FLOOR AREA ALLOWED: 51,425 SQ. FT.

TOTAL FLOOR AREA ALLOWED: 51,425 SQ. FT.

POOL ENCLOSURE: 21% ENCLOSURE CURRENTLY ALLOWED

MAXIMUM PERCENTAGE OF SITE COVERED: 21%

TOTAL SITE AREA: 24,450 ACRES

TOTAL PROPOSED PARKING SPACES PROVIDED: 609 CARS