

- NOTES:
1. ONLY STAKE TREES THAT ARE NOT CAPABLE OF STANDING UPRIGHT WITHOUT FALLING OR LEANING.
 2. USE (3) TREE STABILIZER TREE TUBES PER TREE. PLACE +/- 120 DEGREES APART.
 3. INSTALL INSPECTION TUBE CAPS AND TREE TIES PER MANUFACTURER'S SPECIFICATIONS.
 4. REF. PLANTING NOTES FOR MORE INFORMATION.

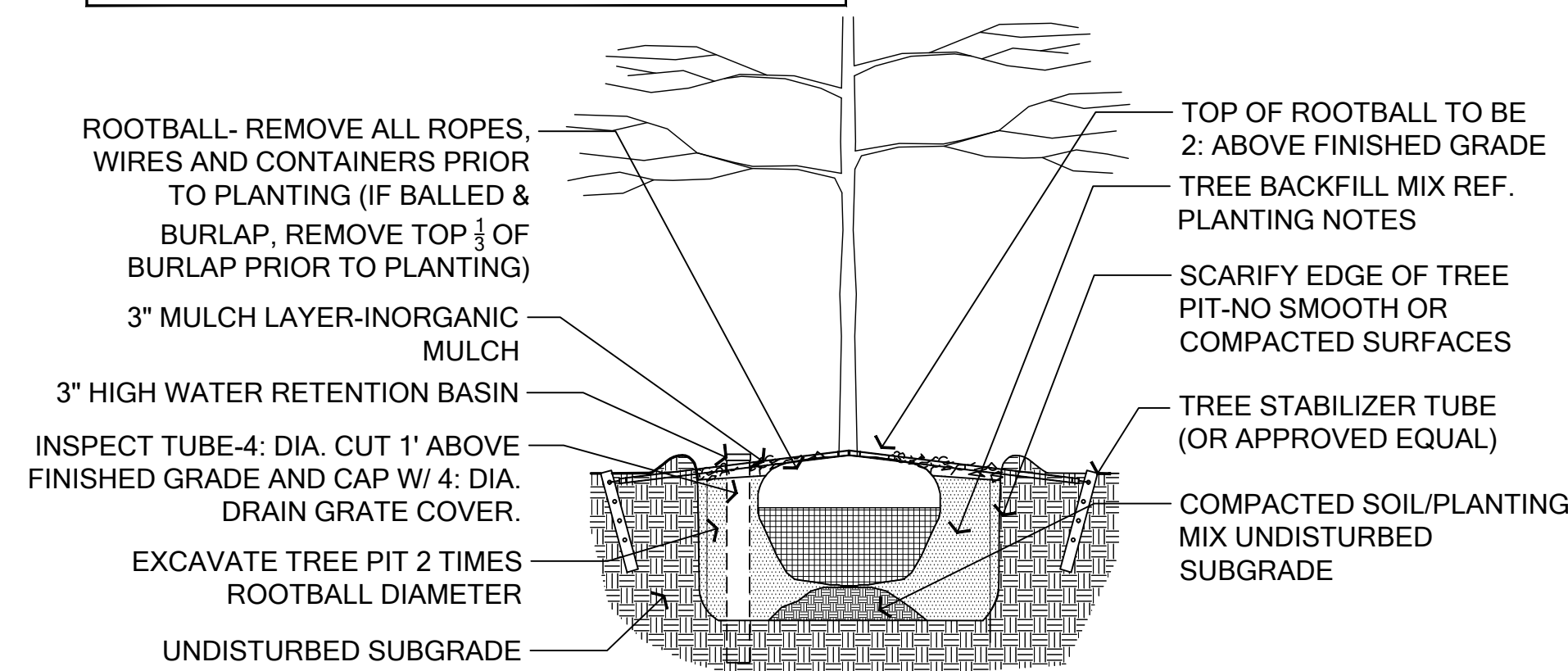

01-DETAIL: TYPICAL TREE PLANTING

SCALE: 1/2"= 1'-0"

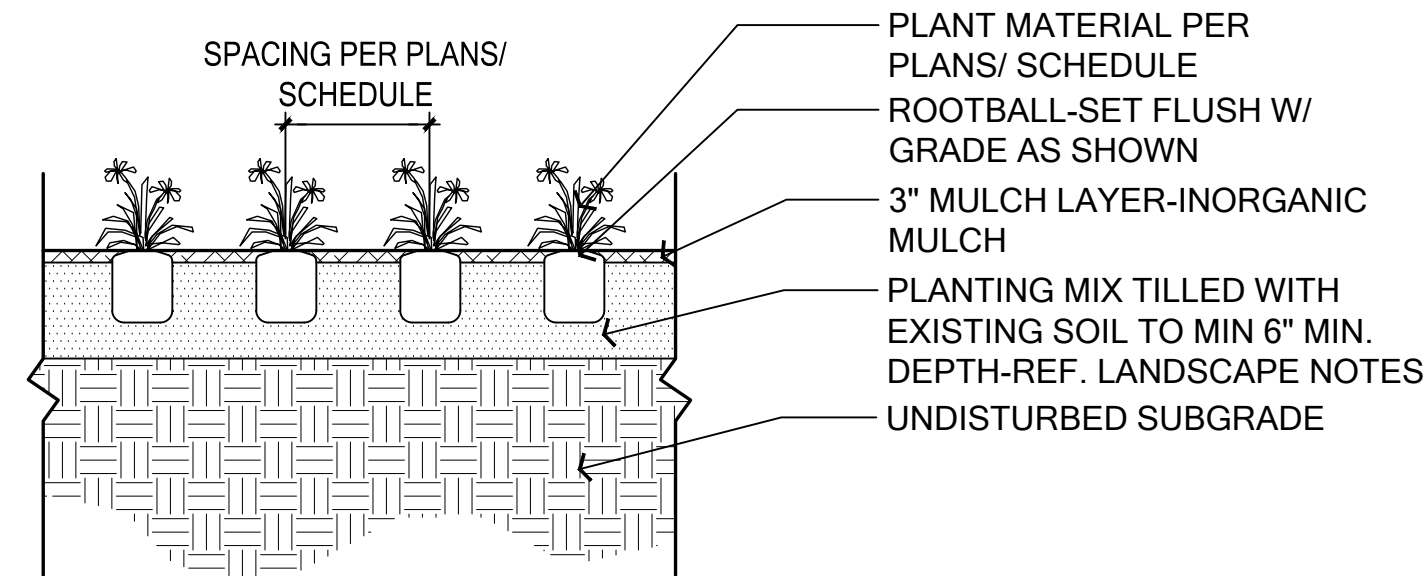

NOTE: THIS DETAIL REFERS TO ALL GROUND COVER, PERENNIAL, AND SEASONAL COLOR PLANTINGS UNLESS OTHERWISE NOTED.

02-DETAIL: TYPICAL GROUND COVER PLANTING

SCALE: 1/2"= 1'-0"

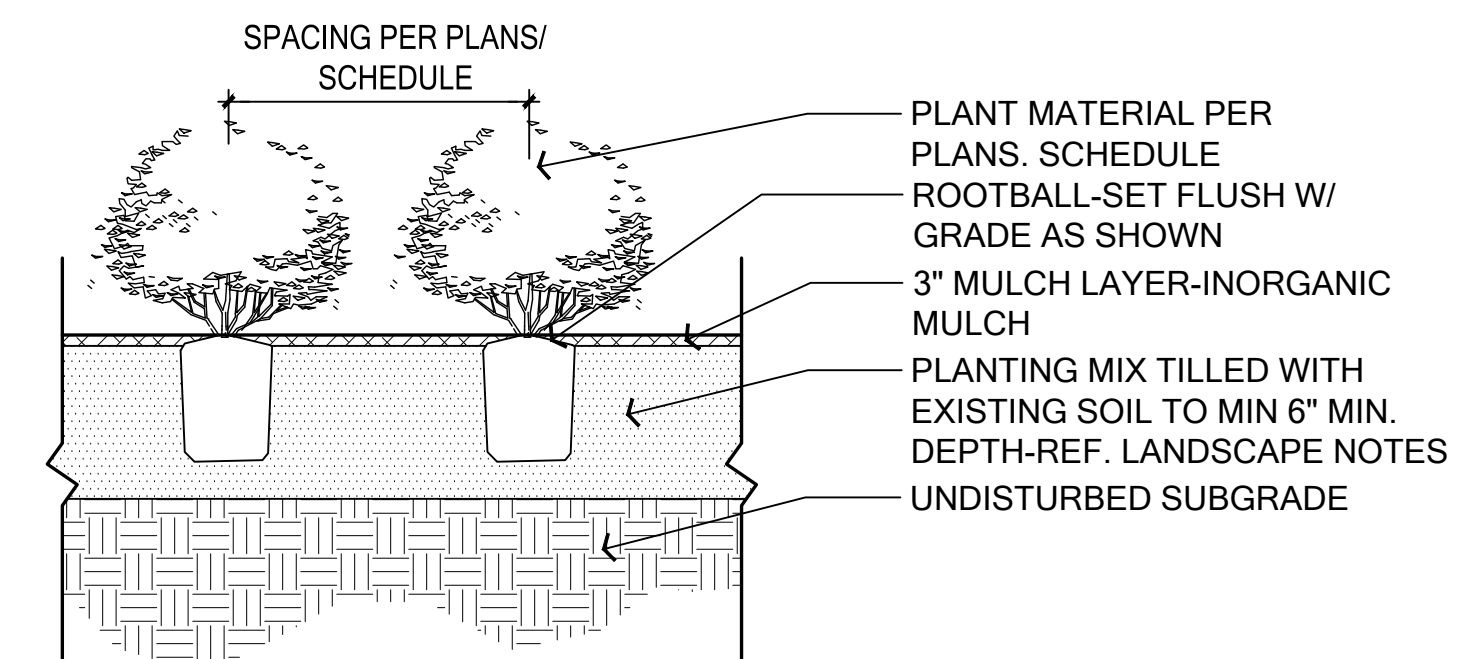

NOTE: THIS DETAIL REFERS TO ALL SHRUB AND ORNAMENTAL GRASS PLANTINGS UNLESS OTHERWISE NOTED.

03-DETAIL: TYPICAL SHRUB PLANTING

SCALE: 1/2"= 1'-0"



DEVELOPMENT PLAN FOR PD 758,
SUBAREA C:
5.80 ACRES
LOT1, BLOCK C/8125
LAKE HIGHLANDS TOWN CENTER
CITY OF DALLAS, DALLAS COUNTY, TEXAS

CASE NO. _____

DEVELOPMENT PLAN
FOR PD 758
LANDSCAPE DETAILS

LAKE HIGHLANDS TOWN CENTER
SKILLMAN STREET AND WALNUT HILL LANE
DALLAS, TEXAS

OWNER:
PCLH Land Partners, LP
Dallas, Texas

Kimley»Horn

1750 Chesapeake Court, Suite 200
Frisco, Texas 75034
State of Texas Registration No. F-4928
Tel. No. (972) 335-5869
Fax No. (972) 335-5779

Scale: AS SHOWN
Designed by: MSB
Drawn by: MSB
Checked by: MSB
Date: 06/30/2017
Project No.: GFF 14208

LS 2.1