

**TOWER ELEVATION**

FOR 24" X 36" PLOT - 1/8" = 1' 0" 2' 4" 8" 16"  
 FOR 11" X 17" PLOT - 1/16" = 1'

**OVERALL SITE PLAN**

PARKING REQUIREMENTS		
Parking quantities are noted in parenthesis beside documented concrete parking areas All parking at is typical 8 1/2 by 18 foot spaces		
CITY OF DALLAS ZONING ORDINANCE		
A. POLICE STATION		
a.	1 SPACE FOR 150 SF OF FLOOR AREA	
b.	1 OFF STREET LOADING SPACE	
B. FUELING STATION		
a.	2 SPACES	
b.	1 LOADING SPACE FOR FUEL TRUCK	
C. MICROWAVE TOWER		
a.	2 SPACES	
POLICE STATION (36250 SF)		
	• 255 SPACES	
	• 1 OFF STREET LOADING SPACE	
FUELING STATION		
	• 2 SPACES	
	• FUEL TRUCK LOADING SPACE	
MICROWAVE TOWER		
	• 2 SPACES	
TOTAL: 259 SPACES		
	1 OFF STREET LOADING SPACE	
	1 FUEL TRUCK LOADING SPACE	
PARKING CALCULATIONS		
STAFF PARKING		
STANDARD SPACES	118	
ACCESSIBLE SPACES	5	
DPD FLEET PARKING		
STANDARD SPACES	73	
SALLY PORT PARKING		
STANDARD SPACES	28	
PUBLIC PARKING		
STANDARD SPACES	33	
ACCESSIBLE SPACES	3	
PARKING TOTALS		
STANDARD SPACES	252	252
ACCESSIBLE SPACES	7	8
GRAND TOTALS	259	260

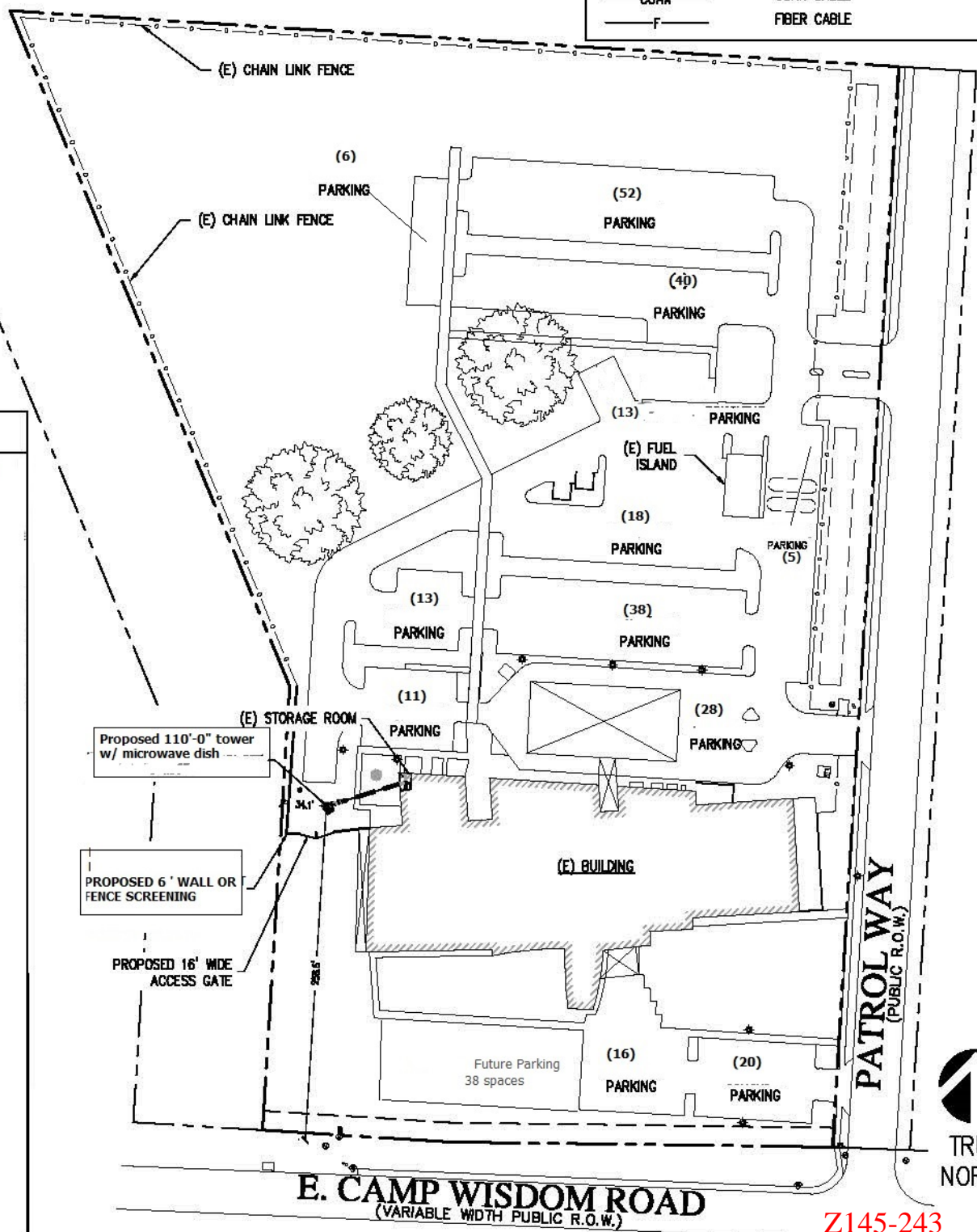

LEGEND	
PROPOSED (E)	NEW EXISTING
---	CENTER LINE
---	PROPERTY LINE
-X-	FENCE LINE
---	GROUND WIRE
-OHP-	OVERHEAD POWER
-OHT-	OVERHEAD TELCO
-P-	UNDERGROUND POWER CONDUIT
-T-	UNDERGROUND TELCO CONDUIT
-COAX-	COAX CABLE
-F-	FIBER CABLE

CLIENT:

CITY OF DALLAS

APPLICANT:

Alcatel-Lucent  
 3400 WEST PLANO PARKWAY  
 PLANO, TEXAS 75075

CONSULTANT:

ALLPRO  
 CONSULTING GROUP, INC.  
 9221 LYNDON B. JOHNSON FREEWAY  
 SUITE 204, DALLAS, TX 75248  
 PHONE: 972-231-8893  
 FAX: 972-231-8375  
 WWW.ALLPROCONS.COM  
 FIRM REGISTRATION # 5242

SITE NAME:  
**DPD SOUTH CENTRAL**

SITE ADDRESS:  
 1999 E. CAMP WISDOM RD  
 DALLAS, TX 75241

STAMP HERE:

NOT VALID WITHOUT P.E. STAMP & SIGNATURE

DRAWN BY:	R. MADLOCK
APPROVED BY:	J. GEORGE
ACGI JOB #:	15-2318

NO	DESCRIPTION	BY	DATE
A	ISSUED FOR REVIEW	RM	05/26/15

SHEET TITLE:  
**OVERALL SITE PLAN**

SHEET NUMBER:  
**C-1**

FOR 24" X 36" PLOT - 1" = 40' 0" 20' 40' 80'  
 FOR 11" X 17" PLOT - 1" = 80'