

TREE PRESERVATION LEGEND

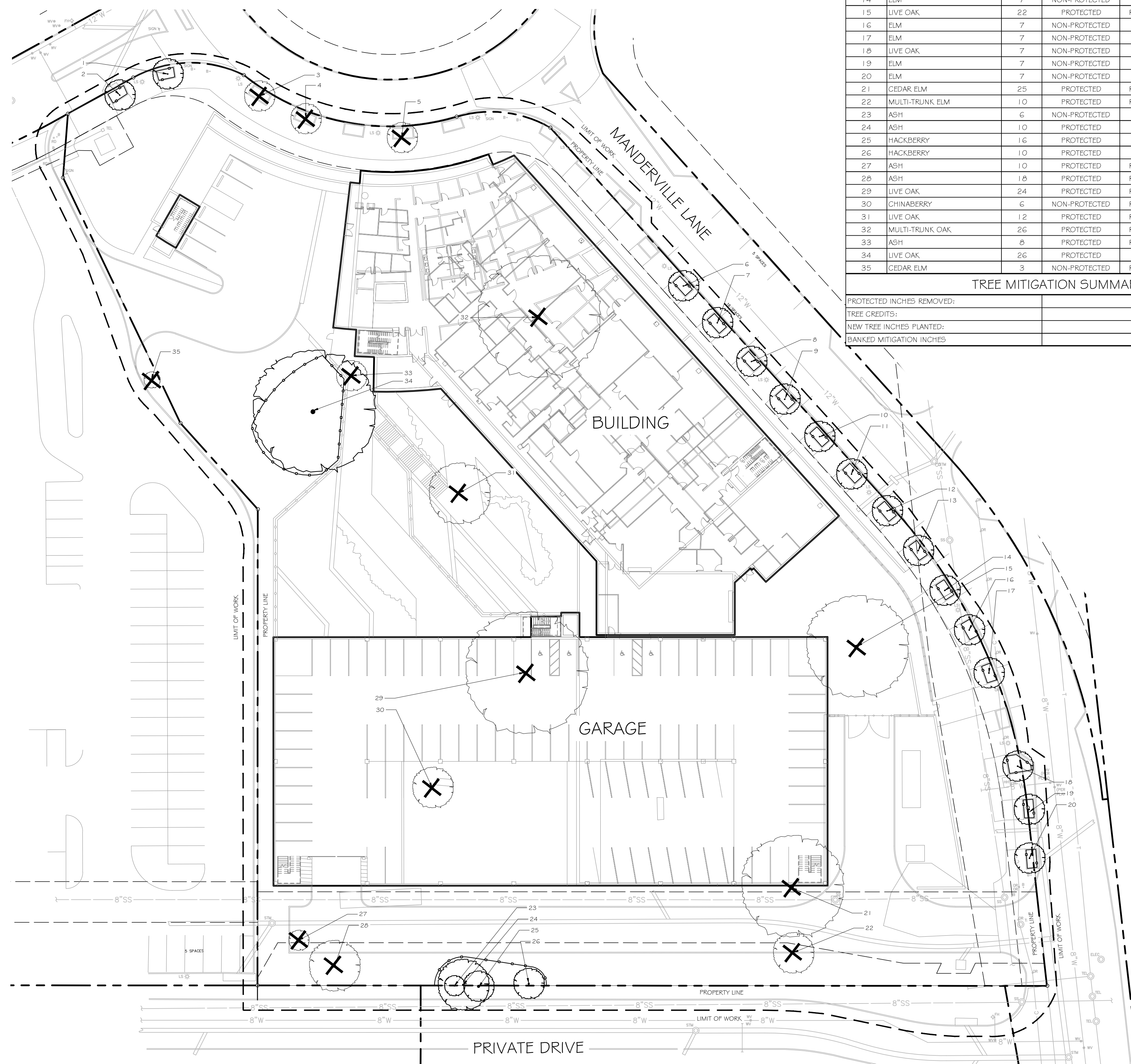

TREE SURVEY FIELD DATA						
TREE NUMBER	TREE SPECIES	CAULIPER (INCH)	STATUS	REMOVE / REMAIN	INCHES TO BE MITIGATED	TREE CREDITS
1	LIVE OAK	6	NON-PROTECTED	REMAIN	0	1
2	LIVE OAK	6	NON-PROTECTED	REMAIN	0	1
3	DEAD TREE	8	NON-PROTECTED	REMOVE	0	0
4	DEAD TREE	8	NON-PROTECTED	REMOVE	0	0
5	DEAD TREE	6	NON-PROTECTED	REMOVE	0	0
6	ELM	6	NON-PROTECTED	REMAIN	0	1
7	ELM	6	NON-PROTECTED	REMAIN	0	1
8	ELM	6	NON-PROTECTED	REMAIN	0	1
9	ELM	7	NON-PROTECTED	REMAIN	0	1
10	ELM	6	NON-PROTECTED	REMAIN	0	1
11	ELM	6	NON-PROTECTED	REMAIN	0	1
12	ELM	7	NON-PROTECTED	REMAIN	0	1
13	ELM	7	NON-PROTECTED	REMAIN	0	1
14	ELM	7	NON-PROTECTED	REMAIN	0	1
15	LIVE OAK	22	PROTECTED	REMOVE	22	0
16	ELM	7	NON-PROTECTED	REMAIN	0	1
17	ELM	7	NON-PROTECTED	REMAIN	0	1
18	LIVE OAK	7	NON-PROTECTED	REMAIN	0	1
19	ELM	7	NON-PROTECTED	REMAIN	0	1
20	ELM	7	NON-PROTECTED	REMAIN	0	1
21	CEDAR ELM	25	PROTECTED	REMOVE	25	0
22	MULTI-TRUNK ELM	10	PROTECTED	REMOVE	10	0
23	ASH	6	NON-PROTECTED	REMAIN	0	1
24	ASH	10	PROTECTED	REMAIN	0	2
25	HACKBERRY	16	PROTECTED	REMAIN	0	4
26	HACKBERRY	10	PROTECTED	REMAIN	0	2
27	ASH	10	PROTECTED	REMOVE	10	0
28	ASH	18	PROTECTED	REMOVE	18	0
29	LIVE OAK	24	PROTECTED	REMOVE	24	0
30	CHINABERRY	6	NON-PROTECTED	REMOVE	0	1
31	LIVE OAK	12	PROTECTED	REMOVE	12	0
32	MULTI-TRUNK OAK	26	PROTECTED	REMOVE	26	0
33	ASH	8	PROTECTED	REMOVE	8	0
34	LIVE OAK	26	PROTECTED	REMOVE	0	10
35	CEDAR ELM	3	NON-PROTECTED	REMOVE	0	0

TREE MITIGATION SUMMARY	
PROTECTED INCHES REMOVED:	155
TREE CREDITS:	36
NEW TREE INCHES PLANTED:	172
BANKED MITIGATION INCHES	17

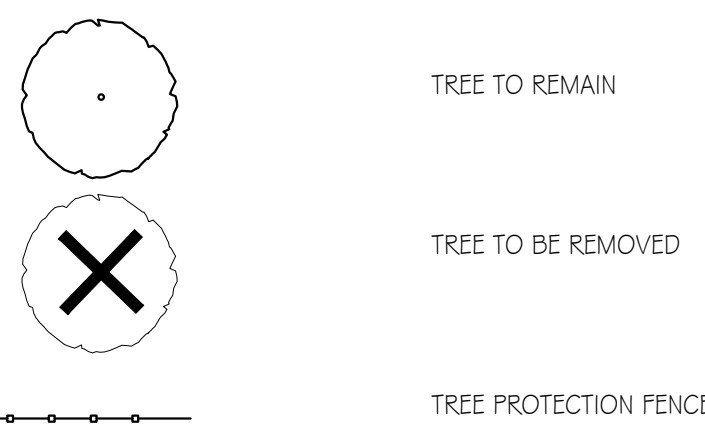
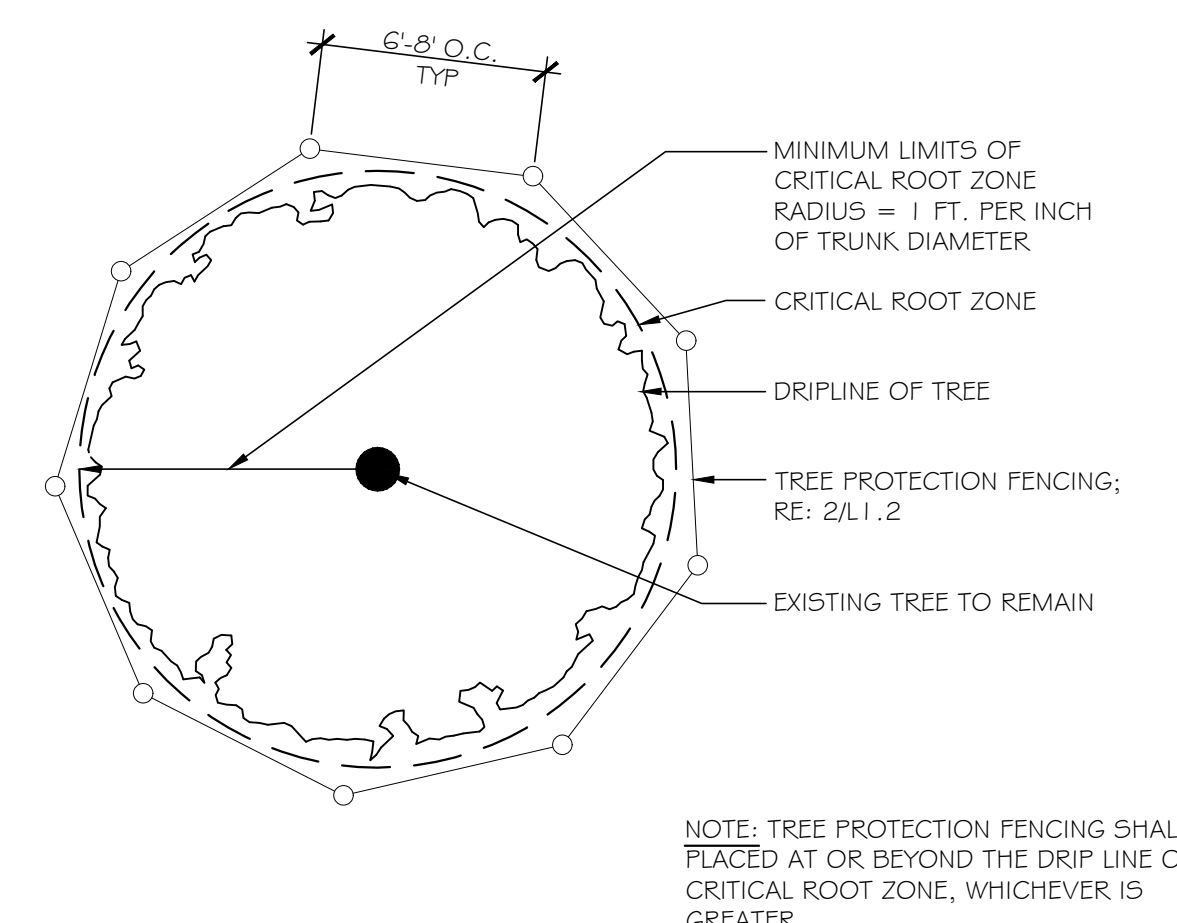

2 TREE PROTECTION FENCING - PLAN VIEW  
N.T.S.

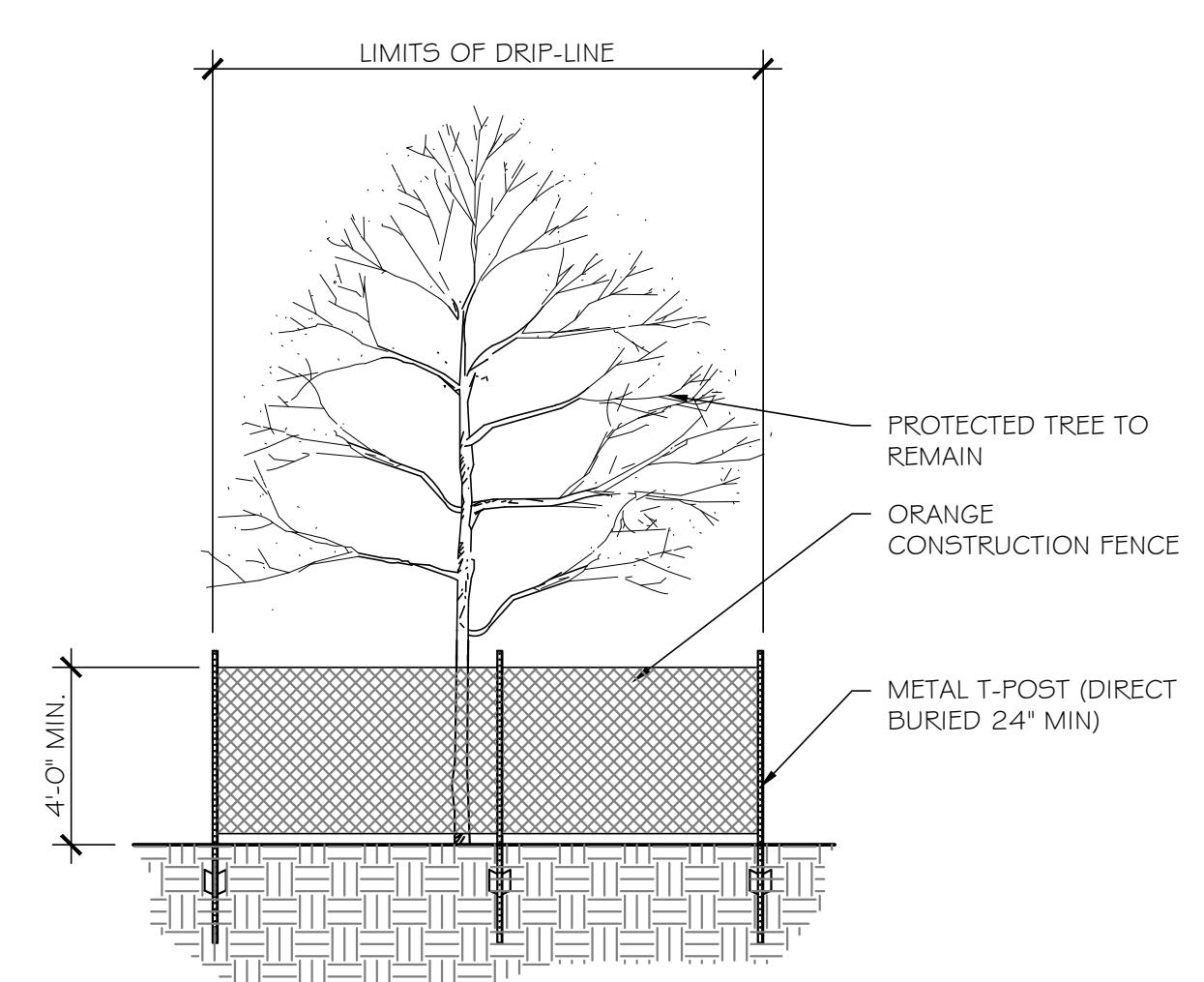

3 TREE PROTECTION FENCING  
3/4" = 1'-0"

CASE FILE # D178-016  
 PLANNED DEVELOPMENT DISTRICT NO. 745  
 SUB AREA C  
 TREE MITIGATION PLAN

TREE MITIGATION NOTES

- CERTIFIED ARBORIST:
  - SHALL BE APPROVED BY OWNER AND MUST BE ISA CERTIFIED. ARBORIST TO PROVIDE DIRECTION FOR TREE PRESERVATION, AS WELL AS DOCUMENTING AND INSURING GUIDELINES AND REGULATIONS CONFORM TO STANDARDS. PRIOR TO BID MUST VISIT SITE TO NOTE ALL TREE PRESERVATION PARAMETERS. MUST BE ONSITE DURING THE DURATION OF THE CONTRACT WHERE WORK INFRINGES UPON THE DRIPLENE OF THE TREE.
  - PROCEDURES REQUIRED PRIOR TO CONSTRUCTION: THE FOLLOWING PROCEDURES SHALL BE FOLLOWED ON ALL TYPES OF CONSTRUCTION PROJECTS.
    - DURING PRE-CONSTRUCTION, TREES TO BE REMOVED SHOULD BE REMOVED FROM THE SITE IN A MANNER TO AVOID INJURY TO REMAINING TREES, INCLUDING THE REMOVAL OF STUMPS AND/OR ROOT SYSTEMS. HEAVY EQUIPMENT SHALL NOT ENCROUGH ON THE ROOT SYSTEMS OF TREES TO BE RETAINED OR OTHER TREES OF HIGH VALUE. IF NECESSARY, TREES SHOULD BE REMOVED MANUALLY WITH CHAIN SAWS, AND STUMPS SHOULD BE GROUND OUT INSTEAD OF USING HEAVY EQUIPMENT.
    - CRITICAL ROOT ZONES SHALL BE ESTABLISHED AND MAINTAINED FOR ALL TREES TO BE CONSERVED ON A CONSTRUCTION SITE. BARRICADES SHALL BE 4 FOOT HIGH ORANGE VINYL CONSTRUCTION FENCE. SIGNS, IN ENGLISH AND SPANISH SHALL BE PLACED VISIBLE FROM ALL DIRECTIONS, ALONG THE FENCE TO INFORM WORKERS OF THE PURPOSE OF THE BOUNDARY. THE BARRIER AND PROPER SIGNAGE SHALL BE INSTALLED PRIOR TO ANY SITE PREPARATION AND SHALL BE MAINTAINED THROUGHOUT ALL PHASES OF THE CONSTRUCTION PROJECT. EROSION AND SEDIMENT CONTROL BARRIERS SHALL BE INSTALLED OR MAINTAINED IN A MANNER WHICH DOES NOT RESULT IN SOIL BUILDUP WITHIN THE TREE DRIP LINE. APPLY 4 INCHES OF COURSE MULCH WITHIN PROTECTION AREAS TO HELP REDUCE MOISTURE STRESS AND REDUCE MAINTENANCE.
    - WHERE EXCAVATIONS ARE PERFORMED WITHIN THE ROOT ZONE OF TREES, TRENCHING SHOULD BE PERFORMED MANUALLY, OR BY USING A VIBRATORY FLOW, DIRECTIONAL BORER, OR BY AIR SPADING. BACKHOES SHALL NOT BE USED TO RIP ROOTS AT CONSIDERABLE DISTANCES FROM THE POINT OF EXCAVATION. WHEN TRENCHING OR MODIFICATION OF THE ROOT ZONE ENCROUGHES HEAVILY ONTO ESTABLISHED TREES, A ROOT PRUNING METHOD SHOULD BE EMPLOYED WHERE THE ROOTS ARE EXPOSED AND TRIMMED WITH PROPER PRUNING TOOLS SEVERAL INCHES TO THE SIDE OF THE TRENCH BORDERING THE TRUNK OF THE AFFECTED TREE. TEARING OF ROOTS IS TO BE AVOIDED. SUPPLEMENTAL IRRIGATION SHALL START IF NEEDED. ANY ROOTS EXPOSED BY CONSTRUCTION ACTIVITY SHALL BE PRUNED FLUSH TO THE SOIL AND SEALED USING LAC BALSAM. BACKFILL ROOT AREAS WITH GOOD QUALITY TOP SOIL AS SOON AS POSSIBLE (I.E. WITHIN THE SAME WORKDAY). IF ROOTS ARE NOT BACKFILLED WITHIN THIS TIME, THEY SHALL BE COVERED WITH ORGANIC MATERIAL SUCH AS COMPOSTED MULCH TO A DEPTH OF 4 INCHES, WHICH WILL REDUCE TEMPERATURE AND MINIMIZE WATER LOSS DUE TO EVAPORATION. EXPOSED ROOTS MUST BE COVERED DURING THE SAME WORKDAY WITH SOIL, MULCH OR OTHER ORGANIC MATERIAL. THE USE OF A SILT FENCE OR OTHER TEMPORARY SOIL RETENTION MATERIAL SHOULD BE USED TO INSURE THAT ROOTS REMAIN COVERED UNTIL THE RECONSTRUCTION OF THE NEW WALL.
    - ALL TREES DIRECTLY ADJACENT TO BUILDINGS SHOULD BE PRUNED FOR CANOPY RAISING TO PROVIDE A MINIMUM OF 4 TO 6 FEET OF CLEARANCE OVER THE BUILDINGS AS WELL AS CANOPY REDUCTION PRUNING TO PROVIDE A MINIMUM OF 2 FEET CLEARANCE AWAY FROM THE SIDES OF BUILDINGS. A CERTIFIED ARBORIST SHOULD ASSESS EACH TREE FOR PRUNING NEEDS PRIOR TO THE CONSTRUCTION TO MAKE APPROPRIATE RECOMMENDATIONS. THE ARBORIST SHOULD ALSO REINSPECT EACH TREE TO INSURE PROPER PRUNING TECHNIQUE AND/OR BEST MANAGEMENT PRACTICES WERE USED IN PRUNING FOR CLEARANCE.
- THE FOLLOWING ACTIVITIES ARE PROHIBITED WITHIN THE LIMITS OF THE CRITICAL ROOT ZONE OF ANY PROTECTED TREE SUBJECT TO THE REQUIREMENTS OF THE CITY ORDINANCE.
  - MATERIAL STORAGE: NO MATERIALS INTENDED FOR USE IN CONSTRUCTION OR WASTE MATERIALS ACCUMULATED DUE TO EXCAVATION OR DEMOLITION SHALL BE PLACED WITHIN THE LIMITS OF THE CRITICAL ROOT ZONE OF ANY PROTECTED TREE.
  - EQUIPMENT CLEANING/LIQUID DISPOSAL: NO EQUIPMENT SHALL BE CLEANED OR OTHER LIQUIDS DEPOSITED OR ALLOWED TO FLOW OVERLAND WITHIN THE LIMITS OF THE CRITICAL ROOT ZONE OF A PROTECTED TREE. THIS INCLUDES, WITHOUT LIMITATION, PAINT, OIL, SOLVENTS, ASPHALT, CONCRETE, MORTAR OR SIMILAR MATERIALS.
  - TREE ATTACHMENTS: NO SIGNS, WIRES OR OTHER ATTACHMENTS, OTHER THAN THOSE A PROTECTIVE NATURE, SHALL BE ATTACHED TO ANY PROTECTED TREE.
  - VEHICULAR TRAFFIC: NO VEHICULAR AND/OR CONSTRUCTION EQUIPMENT OR PARKING SHALL TAKE PLACE WITHIN THE LIMITS OF THE CRITICAL ROOT ZONE OF ANY PROTECTED TREE OTHER THAN ON EXISTING STREET PAVEMENT. THIS RESTRICTION DOES NOT APPLY TO SINGLE INCIDENT ACCESS WITHIN THE CRITICAL ROOT ZONE FOR PURPOSES OF CLEARING UNDERBRUSH, ESTABLISHING THE BUILDING PAD AND ASSOCIATED LOT GRADING, VEHICULAR TRAFFIC NECESSARY FOR ROUTINE UTILITY MAINTENANCE, EMERGENCY RESTORATION OF UTILITY SERVICE, OR ROUTINE MOWING OPERATIONS.
  - GRADE CHANGES: NO GRADE CHANGES SHALL BE ALLOWED WITHIN THE LIMITS OF THE CRITICAL ROOT ZONE OF ANY PROTECTED TREE UNLESS ADEQUATE CONSTRUCTION METHODS ARE APPROVED BY THE LANDSCAPE ARCHITECT.
  - IMPERVIOUS PAVING: NO PAVING WITH ASPHALT, CONCRETE OR OTHER IMPERVIOUS MATERIALS THAT MAY REASONABLY BE EXPECTED TO KILL A TREE SHALL BE PLACED WITHIN THE LIMITS OF CRITICAL ROOT ZONE OF A PROTECTED TREE EXCEPT AS OTHERWISE ALLOWED IN THE CITY ORDINANCE.
- CONTRACTOR RESPONSIBLE FOR ANY DAMAGE TO TREES THAT ARE TO REMAIN. CONTRACTOR TO INSTALL NEW TREE OF EQUIVALENT SIZE IF DAMAGED DURING CONSTRUCTION.

1 TREE MITIGATION PLAN  
1" = 30'-0"

