

DOWNTOWN DALLAS PARKS UPDATE



Photo credit David Worthington

February 18, 2016

PARK AND RECREATION BOARD

- Downtown Parks Overview
- Carpenter Park
- Harwood Park
- Pacific Plaza
- West End Plaza



DOWNTOWN PARKS OVERVIEW

- Downtown Parks Master Plan Update (2013)
- Parks for Downtown Dallas (PDD) committed \$35M in matching funds for 2017 Bond Program



DOWNTOWN PARKS OVERVIEW

- Four priority parks
 - Carpenter Park
 - Harwood Park
 - Pacific Plaza
 - West End Plaza
- Builds on existing downtown parks
 - Main Street Garden
 - Belo Garden
 - Klyde Warren Park
 - Dealey Plaza
 - Pioneer Plaza/Cemetery



- Design Development agreement with Carpenter Park LLC approved
 - Park and Recreation Board November 19, 2015
 - City Council December 9, 2015
- Final design will be presented to the Park and Recreation Board in August 2016
- Currently working on removing, reconfiguring and storing Robert Irwin's *Portal Piece (Slice)*
- Design Development phase (including Robert Irwin's fee) expected to cost \$930,000

CARPENTER PARK



- PDD owns 85% of site
- Ten Eyck Landscape Architects and Quimby/McCoy working on conceptual design
 - Will be presented to Park and Recreation Board in 2016
- Final design of park dependent on DART D2 alignment
- \$10M invested by PDD and the Decherd Foundation on land acquisitions
- Conceptual master plan: \$200,000
- Requires abandonment of Wood Street
- Great lawn for Harwood Park is larger than Main Street Garden

HARWOOD PARK



Existing Site

HARWOOD PARK



REFINED CONCEPT MASTERPLAN
HARWOOD PARK
 Parks For Downtown Dallas

February 8, 2016

- Park and Recreation Department owns entire site
 - Land purchased in partnership with Trust for Public Land
- Park and Recreation Board review of project development
 - May 22, 2014
 - August 7, 2014
- PDD is convening a stakeholders meeting with landscape architecture firm SWA
- PDD will pay for schematic design and design development
 - \$550,000 estimated cost
- Schematic design estimated to be completed in late 2016
 - Park and Recreation Board will be briefed on plan
- Requires abandonment or temporary closure of Live Oak Street

PACIFIC PLAZA

Previous concept for Pacific Plaza

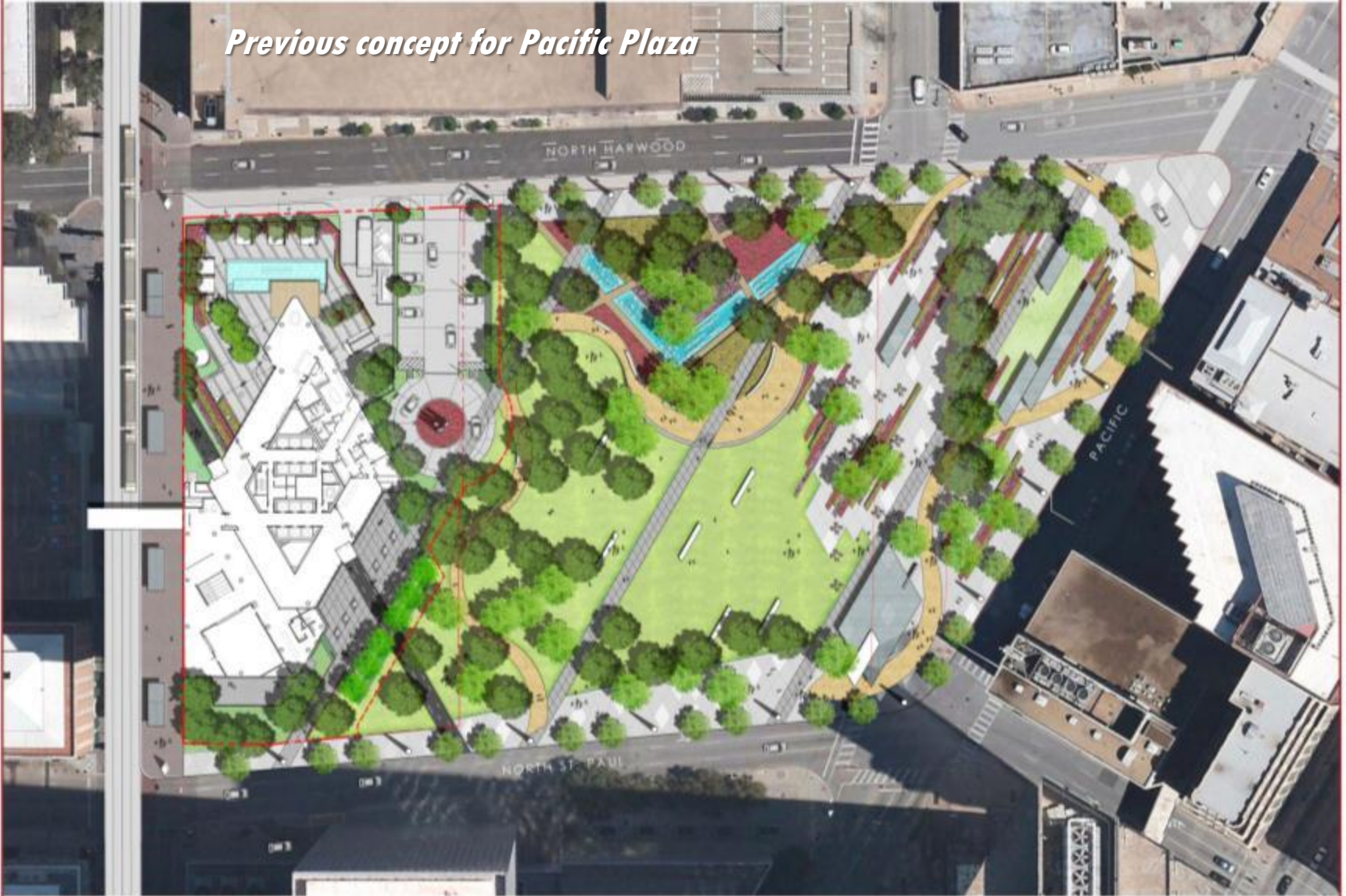

- Site not presently owned by the City of Dallas
 - \$4.6M allocated in 2006 Bond Program for land acquisition for 617 Corbin Site
 - PDD has committed to contributing additional funds for land acquisition costs
- .73 acre site
- PDD to pay for schematic development
- Site strongly favored by West End Business Association and Downtown Dallas Inc.

WEST END PLAZA



HISTORIC WEST END DISTRICT : WEST END PLAZA PRECEDENTS / SCALE COMPARISON

WEST END PLAZA

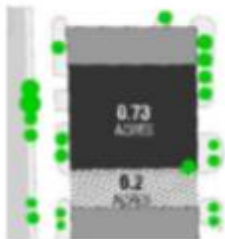

PEGASUS PLAZA

Dallas, TX



555 MISSION

San Francisco, CA

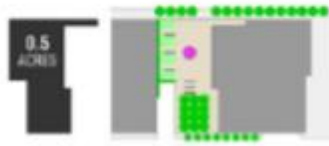

PLAZA DE SANTA ANA

Madrid, Spain



SHAW CENTER

Baton Rouge, LA

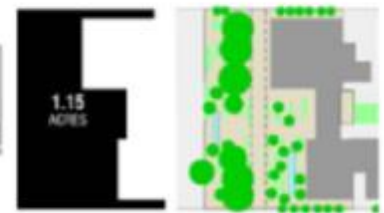

- Water Feature
- Cafe Area
- Public Art
- Shaded Seating
- Pedestrian Circulation
- Public Events



- Open Plaza
- Garden Rooms
- Public Art
- Shaded Grove
- Pedestrian Circulation



- Open Plaza
- Shaded Seats
- Multiple Cafe Areas
- Cafe Structures



- Urban Gardens
- Shaded Seats
- Interactive Water Feature
- Extended Plaza Across Street
- Outdoor Event Space

WEST END PLAZA



- Parks for Downtown Dallas (PDD) committed \$35M in matching funds for future 2017 Bond Program commitment
- Funding only possible if Park and Recreation Department receives funding in the 2017 Bond Program

DOWNTOWN DALLAS PARKS UPDATE



Photo credit David Worthington

February 18, 2016

PARK AND RECREATION BOARD