

CURVE	LENGTH	RADIUS	DELTA	CHORD BEARING	CH. DIST.
C1	446.74	2,266.83	111°30'	S 43°42'23" E	446.62
C2	805.29	788.51	58°30'54"	S 81°04'28" W	770.75
C3	789.02	2,266.83	20°11'45"	N 30°24'46" E	794.89

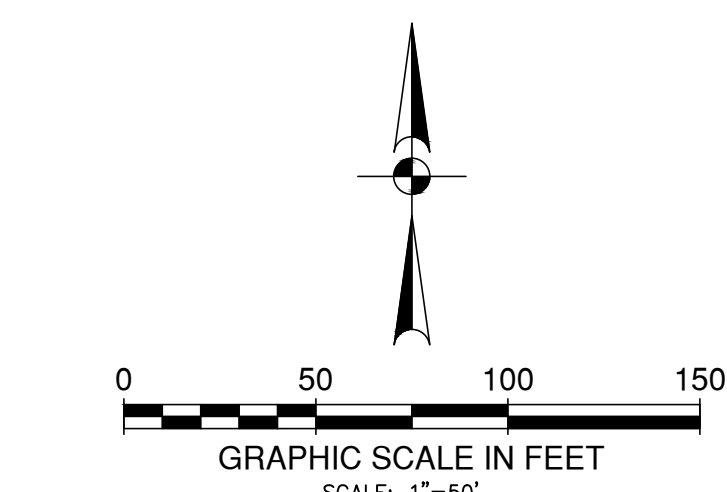

**muñoz**  
 1017 NORTH MAIN, SUITE 300  
 SAN ANTONIO, TEXAS 78212  
 0.210.349.1163 • F.210.525.1038

THIS DOCUMENT IS RELEASED FOR "REVIEW PURPOSES" UNDER THE AUTHORIZATION OF JASON R. ELMS, P.E. #90922 JUNE 15, 2018. IT IS NOT FOR CONSTRUCTION OR PERMIT PURPOSES.

**PAPE-DAWSON ENGINEERS**

DALLAS | SAN ANTONIO | AUSTIN | HOUSTON | FORT WORTH  
 5700 W PLANO PKWY, STE 2500 | PLANO, TX 75093 | 214.420.8484  
 TEXAS BOARD OF PROFESSIONAL ENGINEERS FIRM REGISTRATION #410

**DALLAS INDEPENDENT SCHOOL DISTRICT**  
**L.G. PINKSTON HIGH SCHOOL**  
 DALLAS, TEXAS  
**DESIGN DEVELOPMENT**

**DALLAS ISD BOND PROGRAM 2015**

Revisions		
#	DESCRIPTION	DATE

Date	<b>MARCH 09, 2018</b>	
Project Number	Checked By	Drawn By
<b>70077-00</b>	<b>JY</b>	<b>FC</b>
Sheet Title		

**DEVELOPMENT PLAN**

**EX-1**

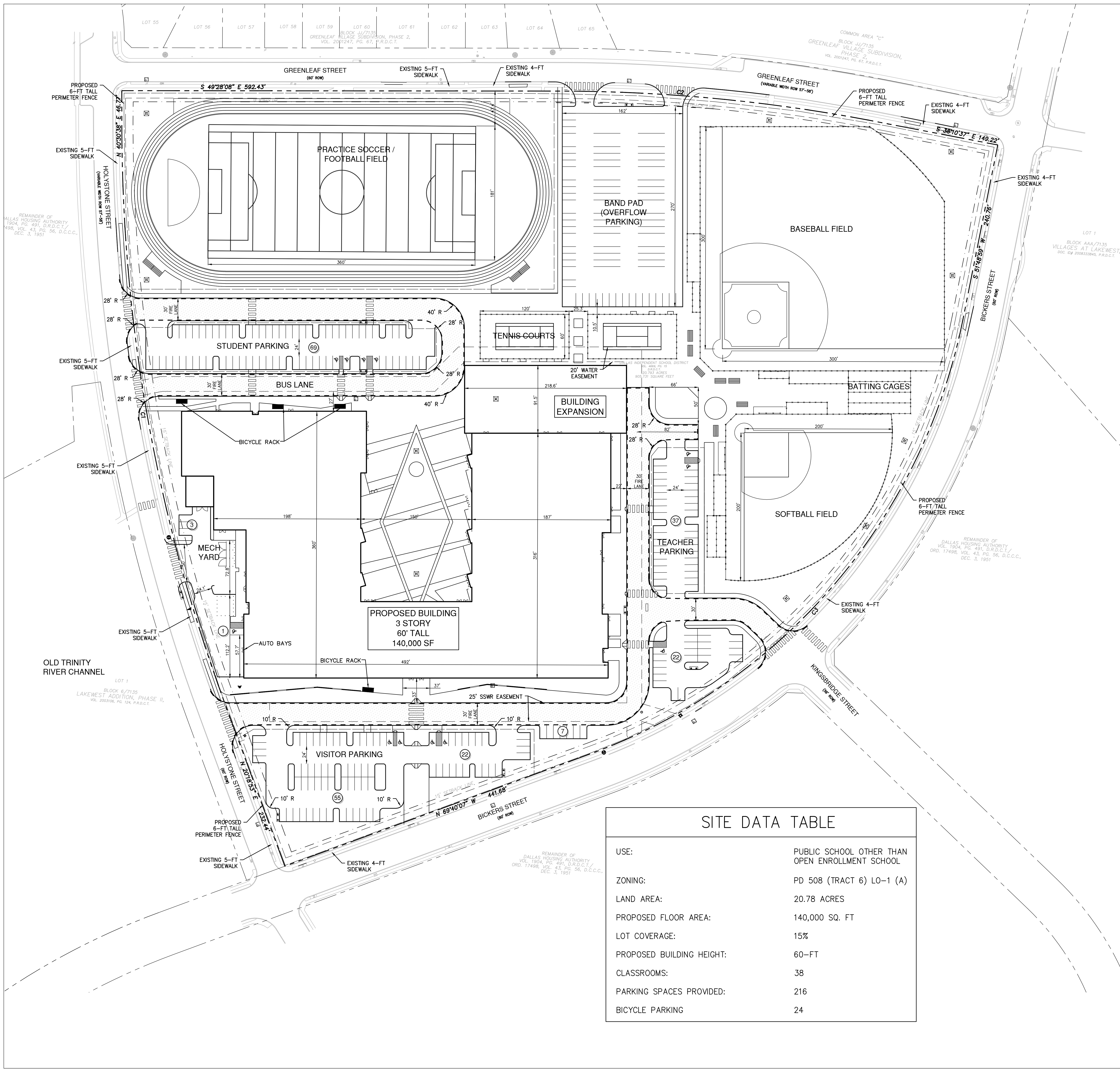

**LEGEND**

	PARKING COUNT
	PROPOSED FIRE LANE
	PROPERTY LINE
	PROPOSED CURB
	EXISTING CURB
	PROPOSED FENCE
	EXISTING 15' SETBACK
	PAINTED PEDESTRIAN CROSSWALK

SITE DATA TABLE	
USE:	PUBLIC SCHOOL OTHER THAN OPEN ENROLLMENT SCHOOL
ZONING:	PD 508 (TRACT 6) LO-1 (A)
LAND AREA:	20.78 ACRES
PROPOSED FLOOR AREA:	140,000 SQ. FT
LOT COVERAGE:	15%
PROPOSED BUILDING HEIGHT:	60-FT
CLASSROOMS:	38
PARKING SPACES PROVIDED:	216
BICYCLE PARKING	24